

F.A.S. RTE.	SECTION	COUNTY	TOTAL SHEETS	SHEET NO.
642	99-00124-02-PV	COLES	229	98
STA. 1+50.00		TO STA. 10+00.00		
FED. ROAD DIST. NO.		ILLINOIS FED. AID PROJECT		

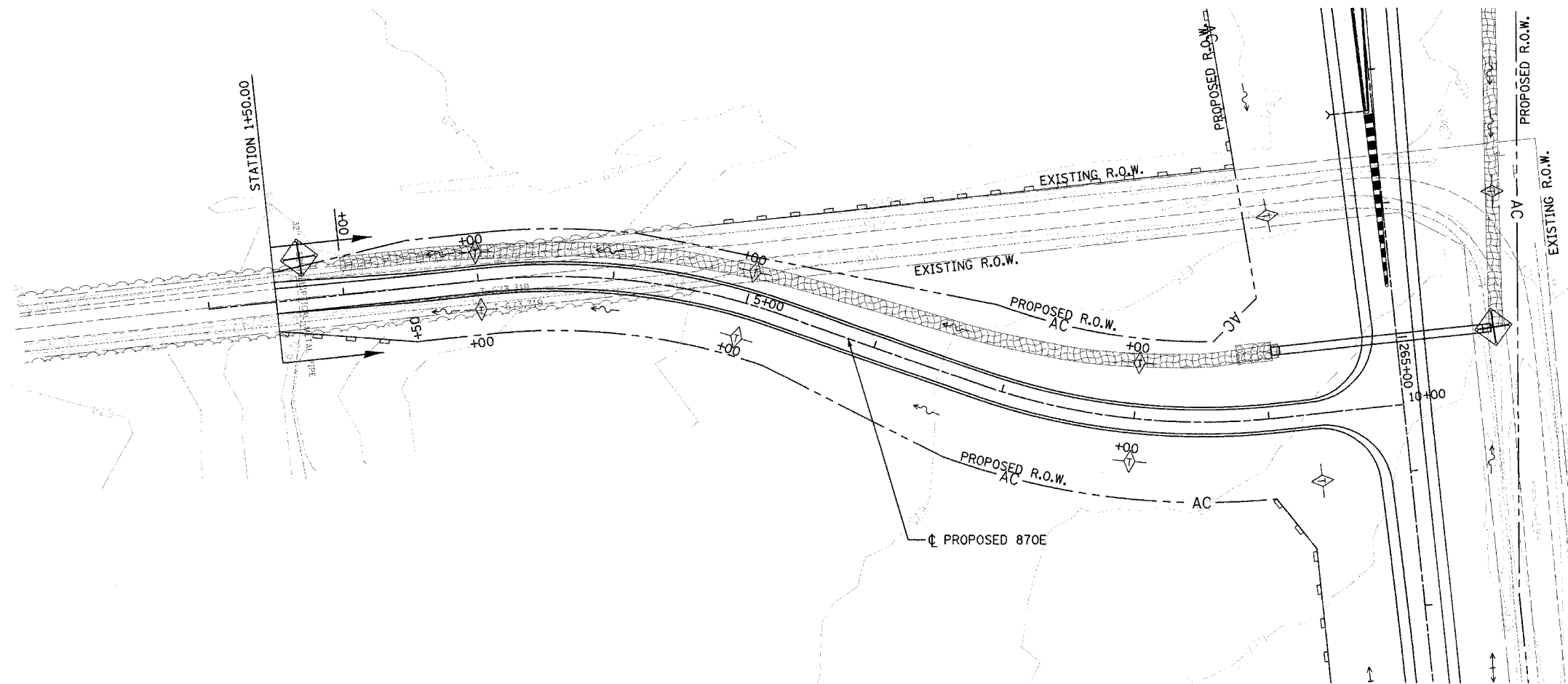

INTENDED SEQUENCE

1. PLACE PERIMETER EROSION CONTROL BARRIER PRIOR TO COMMENCEMENT OF ANY WORK. SEE STD. 280001.
2. CONSTRUCT EARTHWORK, INCLUDING DITCHES. (MAXIMUM 10 ACRES DISTURBED AT ONE TIME PRIOR TO SEEDING. SEE ART. 280).
3. PLACE AND MAINTAIN TEMPORARY AND PERMANENT EROSION CONTROLS AS WORK PROGRESSES, SEED EVERY 7 DAYS. SEE ART. 280.
4. FINAL SHAPE, GRADE, AND PAVE ROADWAY.
5. PLACE REMAINING PERMANENT EROSION CONTROLS.

LEGEND

	EA.	L.F.	SQ.YD.
	0	0'	782
	0	600'	0
	6	0'	0
	1	0'	0

NOTE: SEE MISCELLANEOUS DETAIL SHEET NO. 116 FOR EROSION CONTROL BLANKET DETAIL.

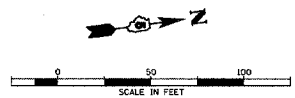

REVISIONS	
NAME	DATE

ILLINOIS DEPARTMENT OF TRANSPORTATION
EROSION CONTROL PLAN
 870E
 FAI-57, FAS 642
 SEC NO. 15-23K, 99-00124-02-PV
 COLES COUNTY, ILLINOIS

SCALE: HORIZ. 1"=50'
 DATE 07/13/2005

DRAWN BY
 CHECKED BY SKM

870E STA. 1+50.00 TO STA. 10+00.00



Copyright Hanson Professional Services Inc. 2005

LAYOUT: BJS 03/19/03
 DRAWN: BJP/JAF 03/31/03
 REVIEWED: SKM 04/01/03
 07/13/2005
 I:\97\005\9702124\02\15-23K\C\870E\EROS.dgn