

F.A.S. RTE.	SECTION	COUNTY	TOTAL SHEETS	SHEET NO.
642	99-00124-02-PV	COLES	229	102
STA.	TO STA.			
FED. ROAD DIST. NO.	ILLINOIS	FED. AID PROJECT		

LEGEND		EA.	L.F.	SQ.YD.
	EROSION CONTROL BLANKET	0	0'	705
	PERIMETER EROSION BARRIER	0	400'	0
	DITCH CHECK TEMPORARY	6	0'	0
	INLET AND PIPE PROTECTION	2	0'	0
	DITCH FLOW			
	DITCH FLOW SUMMIT			
	TREE REMOVAL			

NOTE: SEE MISCELLANEOUS DETAIL SHEET NO. 116 FOR EROSION CONTROL BLANKET DETAIL.

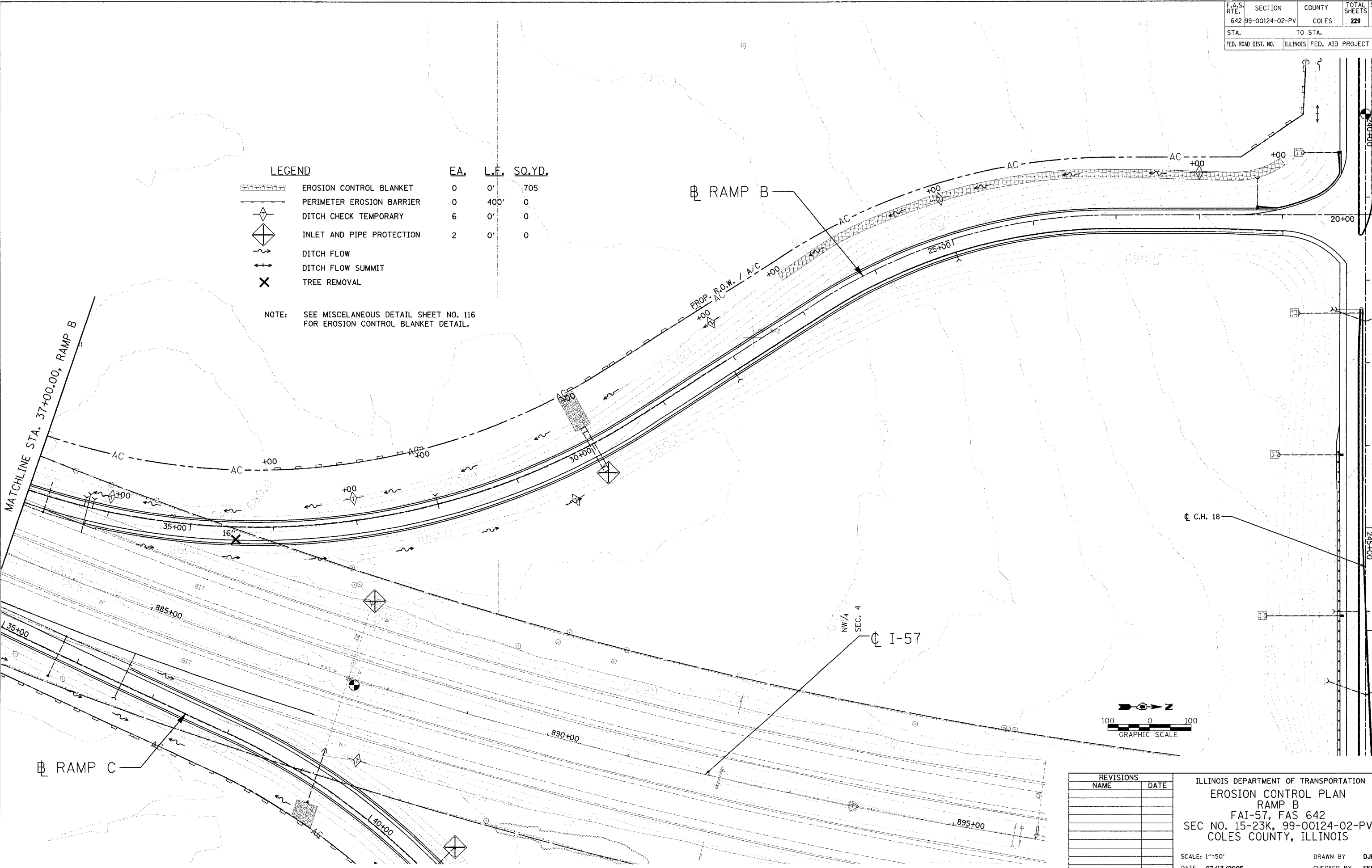

REVISIONS	
NAME	DATE

ILLINOIS DEPARTMENT OF TRANSPORTATION
 EROSION CONTROL PLAN
 RAMP B
 FAI-57, FAS 642
 SEC NO. 15-23K, 99-00124-02-PV
 COLES COUNTY, ILLINOIS

SCALE: 1"=50'
 DATE: 07/13/2005
 DRAWN BY: DJP
 CHECKED BY: SKM



LAYOUT: DJP/SM/03/28/05 07/13/2005
 DRAWN: DJP 04/28/05
 REVIEWED: JNM 05/07/05
 I:\97\065\97-0228\DWG\Sheet\97-RAMPB-ER0.dwg

© Copyright Hanson Professional Services Inc. 2005