

F.A.S. RTE.	SECTION	COUNTY	TOTAL SHEETS	SHEET NO.
567	04-00022-04-SP	MASON	18	1
FED. ROAD DIST. NO.	ILLINOIS	FED. AID PROJECT		

**STATE OF ILLINOIS  
DEPARTMENT OF TRANSPORTATION  
DIVISION OF HIGHWAYS**

**PLANS FOR PROPOSED  
HAZARD ELIMINATION SAFETY PROGRAM  
FAS 567**

**SECTION NO. 04-00022-04-SP**

**PROJECT NO. HS-567-(111)  
MASON COUNTY  
COUNTY HIGHWAY 20  
C-96-203-05**

**CONTRACT NO. 93400**

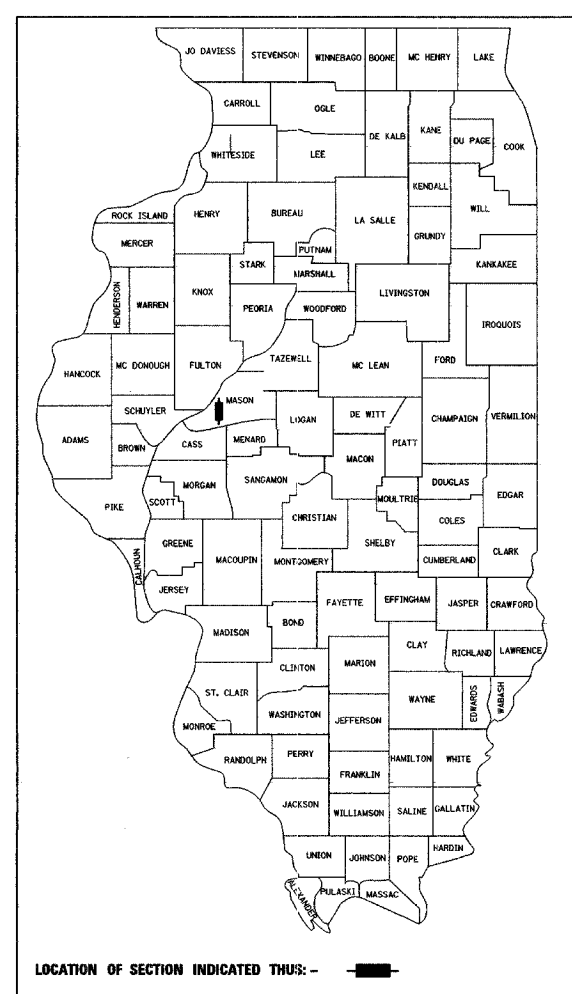

**INDEX OF SHEETS**

- 1 COVER SHEET
- 2 GENERAL NOTES, SUMMARY OF QUANTITIES, PROPOSED TYPICAL SECTION, AND BUTT JOINT DETAIL
- 3-4 PLAN AND PROFILE SHEETS
- 5-6 EROSION CONTROL PLANS
- 7-18 CROSS SECTIONS

**REQUIRED STANDARDS**

- 000001-04 SYMBOLS, ABBREVIATIONS, AND PATTERNS
- 280001-02 TEMPORARY EROSION CONTROL SYSTEMS
- 642001 SHOULDER RUMBLE STRIP
- 666001 RIGHT-OF-WAY MARKERS
- 701006-02 OFF-ROAD OPERATIONS, 2L, 2W, 4.5m (15') TO 600 mm (24") FROM PAVEMENT EDGE
- 701011-01 OFF-ROAD MOVING OPERATIONS, 2L, 2W, DAY ONLY
- 701201-02 LANE CLOSURE, 2L, 2W, DAY ONLY, FOR SPEEDS ≥ 45 MPH
- 701306-01 LANE CLOSURE, 2L, 2W, SLOW MOVING OPERATIONS DAY ONLY, FOR SPEEDS ≥ 45 MPH
- 701311-02 LANE CLOSURE, 2L, 2W, MOVING OPERATIONS - DAY ONLY
- 702001-05 TRAFFIC CONTROL DEVICES
- 780001-01 TYPICAL PAVEMENT MARKINGS
- 781001-02 TYPICAL APPLICATIONS RAISED REFLECTIVE PAVEMENT MARKERS

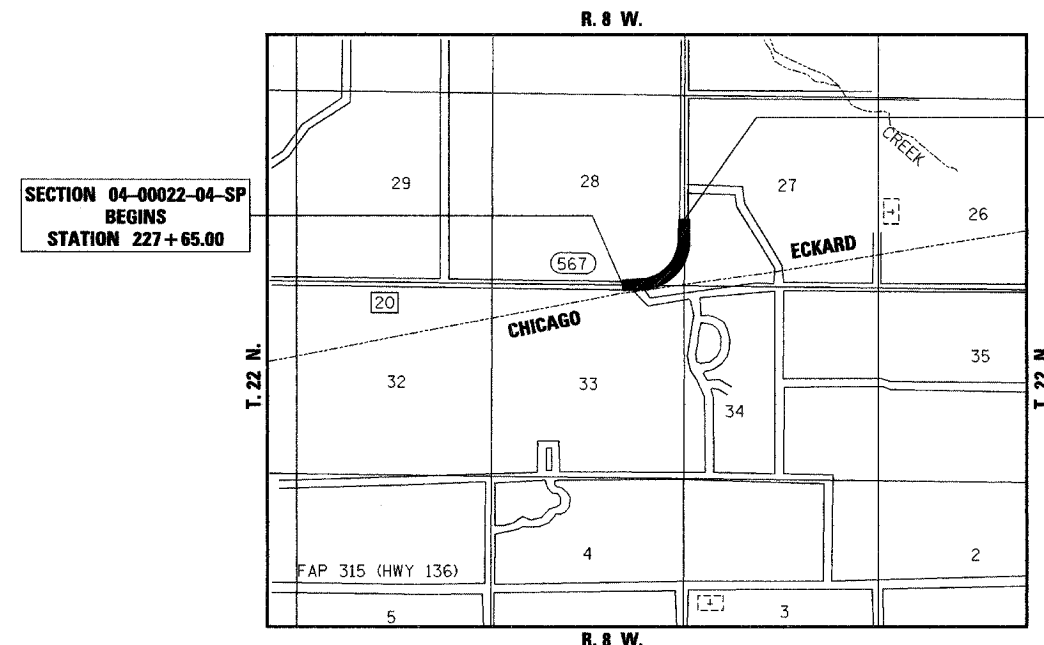

SECTION 04-00022-04-SP  
ENDS  
STATION 247 + 39.00

SECTION 04-00022-04-SP  
BEGINS  
STATION 227 + 65.00

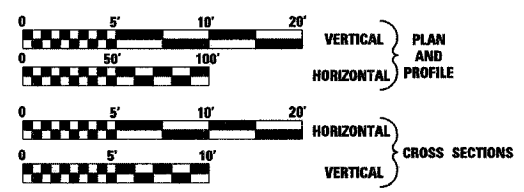
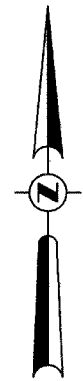

FULL SIZE PLANS HAVE BEEN PREPARED USING STANDARD ENGINEERING SCALES, REDUCED SIZE PLANS WILL NOT CONFORM TO STANDARD SCALES, IN MAKING MEASUREMENTS ON REDUCED PLANS, THE ABOVE SCALES MAY BE USED.

J.U.L.I.E.  
JOINT UTILITY LOCATION INFORMATION FOR EXCAVATION  
1-800-892-0123

**DESCRIPTION OF WORK**

THE PROJECT WILL CONSIST OF IMPROVING A HORIZONTAL CURVE ON COUNTY HIGHWAY 20. THE IMPROVEMENTS WILL CONSIST OF INCREASING THE SUPERELEVATION BY VARIABLE THICKNESS RESURFACING, CONSTRUCTING BITUMINOUS SHOULDERS 6' WIDE, AND FLATTENING THE EARTH SIDE SLOPES.

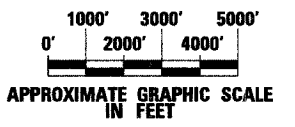

TOTAL AND NET LENGTH OF PROJECT = 1974.00 FEET = 0.374 MILES

FUNCTIONAL CLASSIFICATION : MAJOR COLLECTOR  
ADT : 5400 (2024)  
DESIGN SPEED : 50 MPH (POSTED 45)

HUTCHISON ENGINEERING, INC  
CONSULTING ENGINEERS  
JACKSONVILLE, ILLINOIS  
2005 JOB NO 2314

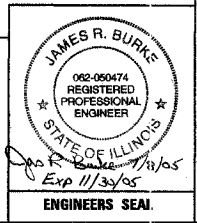

APPROVED	<i>May 31</i>	20 05
	<i>William R. Burke</i>	COUNTY ENGINEER
PASSED	<i>OCTOBER 13</i>	20 05
	<i>James J. ...</i>	DISTRICT SIX ENGINEER OF LOCAL ROADS & STREETS
PASSED	<i>OCT 14</i>	20 05
	<i>W.R. ...</i>	DISTRICT SIX ENGINEER OF CONSTRUCTION
Releasing For Bid Based on Limited Review	<i>OCT 13</i>	20 05
	<i>Christine M. Reed</i>	DEPUTY DIRECTOR OF HIGHWAYS, REGION FOUR ENGINEER
STATE OF ILLINOIS DEPARTMENT OF TRANSPORTATION		

CONTRACT NO. 93400