

F.A.S. RTE.	SECTION	COUNTY	TOTAL SHEETS	SHEET NO.
567	04-00022-04-PP	MASON	18	7
STA.		TO STA.		
FED. ROAD DIST. NO.	ILLINOIS	FED. AID PROJECT		

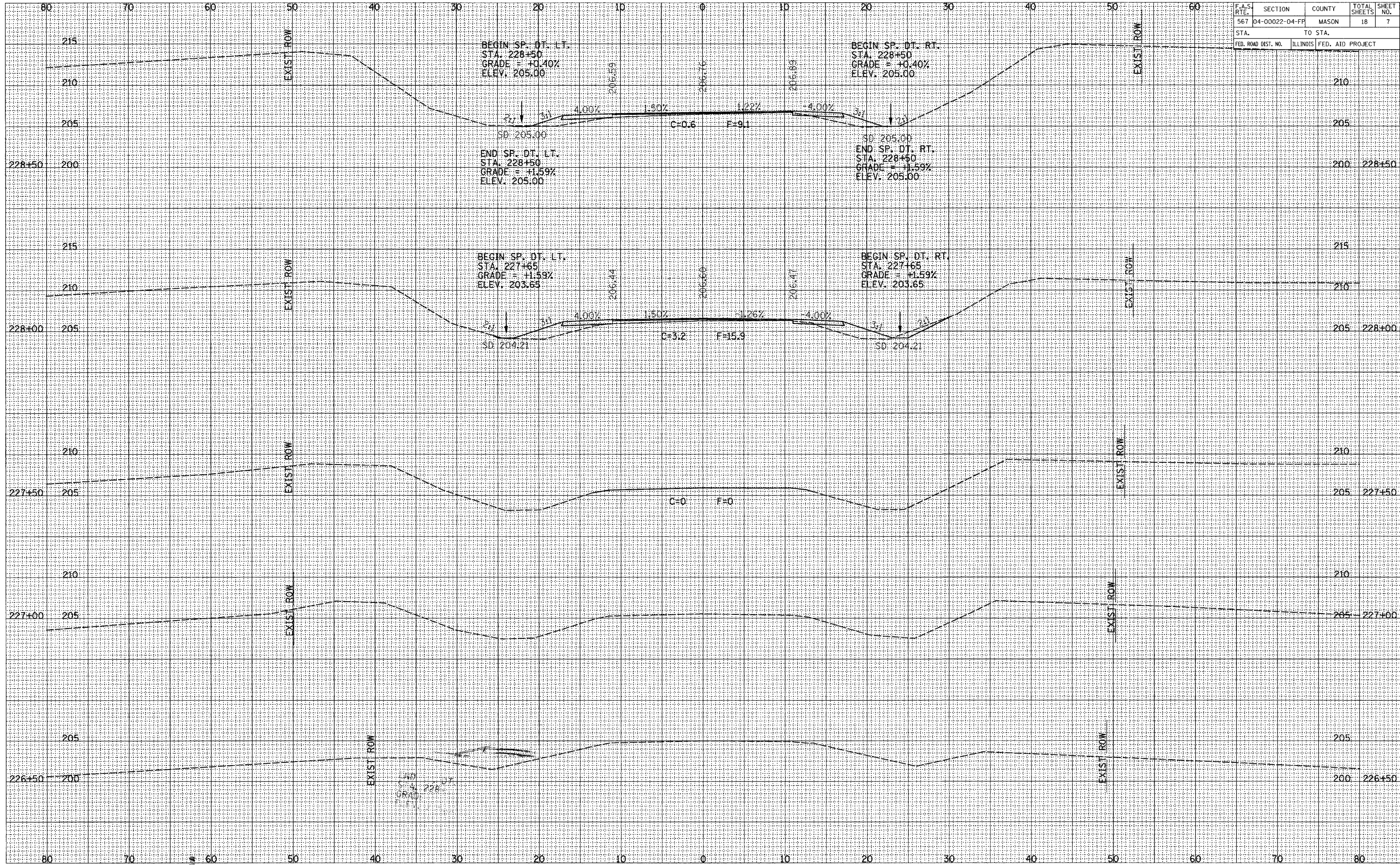

PLOTTED
 SHEET
 NOTE BOOK
 NO.

PLOTTED
 SHEET
 NOTE BOOK
 NO.

EXIST ROW