

F.A.S. RTE.	SECTION	COUNTY	TOTAL SHEETS	SHEET NO.
567	04-00022-04-FP	MASON	18	10
STA.		TO STA.		
FED. ROAD DIST. NO.		ILLINOIS	FED. AID PROJECT	

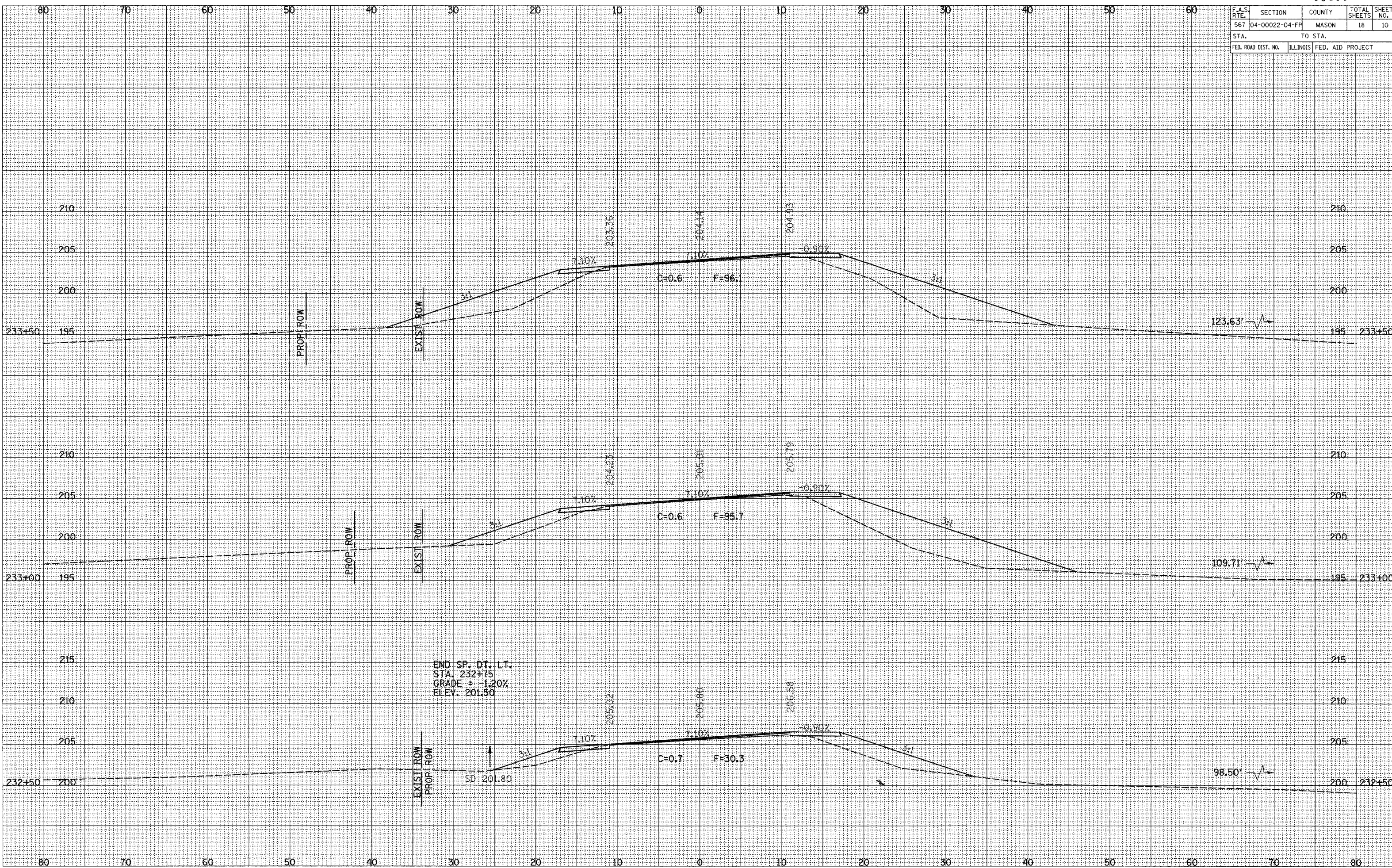

END SP. DT. LT.
 STA. 232+75
 GRADE = -1.20%
 ELEV. 201.50

PLOTTED
 TEMPLATE
 NOTE BOOK
 AREAS CHECKED

PLOTTED
 TEMPLATE
 NOTE BOOK
 AREAS CHECKED