

# MCLEAN COUNTY - I-39 OVERVIEW OF PROPOSED WORK

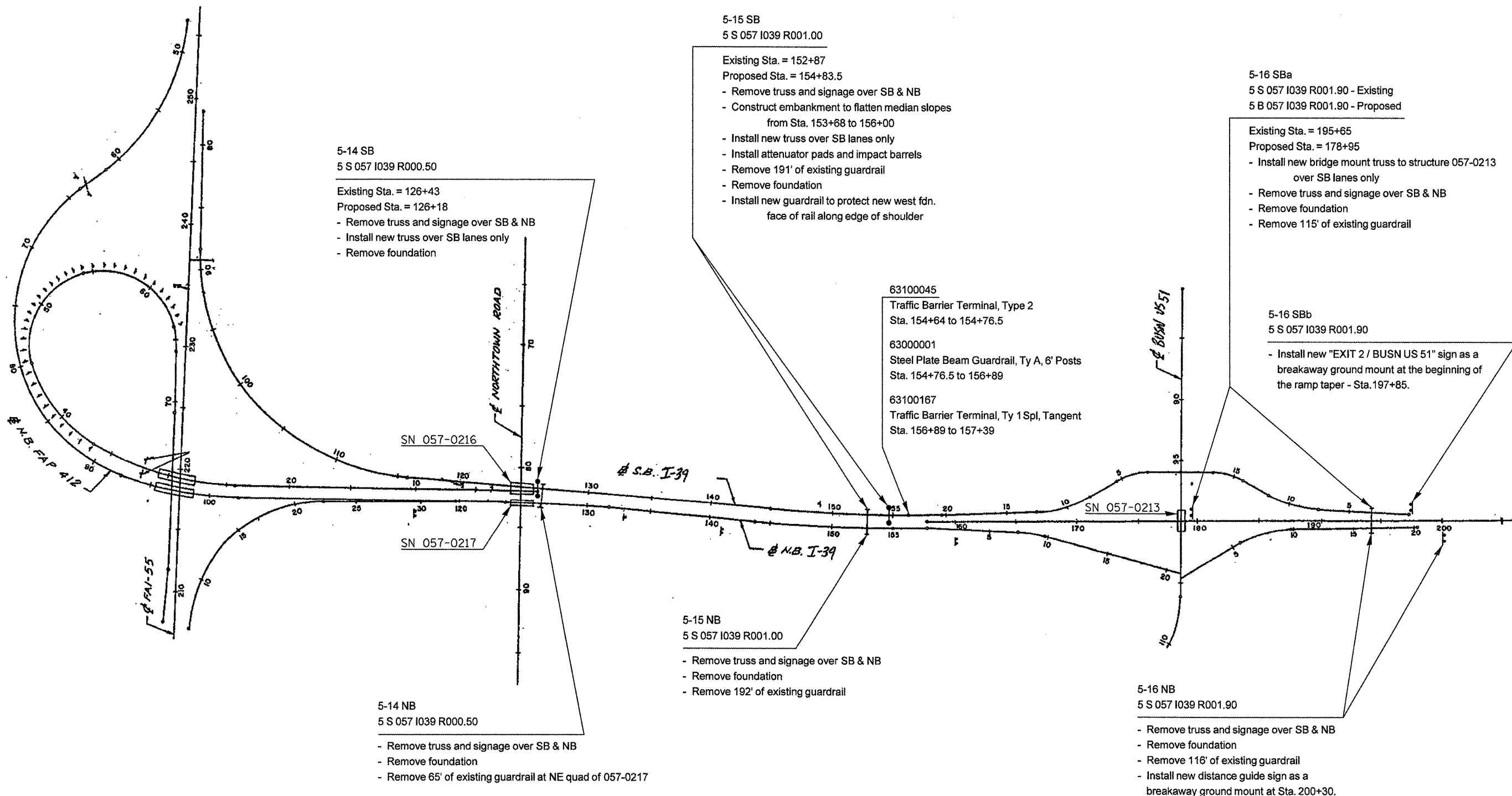

5-14 SB  
5 S 057 I039 R000.50

- Existing Sta. = 126+43  
Proposed Sta. = 126+18
- Remove truss and signage over SB & NB
  - Install new truss over SB lanes only
  - Remove foundation

5-15 SB  
5 S 057 I039 R001.00

- Existing Sta. = 152+87  
Proposed Sta. = 154+83.5
- Remove truss and signage over SB & NB
  - Construct embankment to flatten median slopes from Sta. 153+68 to 156+00
  - Install new truss over SB lanes only
  - Install attenuator pads and impact barrels
  - Remove 191' of existing guardrail
  - Remove foundation
  - Install new guardrail to protect new west fdn. face of rail along edge of shoulder

5-16 SBa  
5 S 057 I039 R001.90 - Existing  
5 B 057 I039 R001.90 - Proposed

- Existing Sta. = 195+65  
Proposed Sta. = 178+95
- Install new bridge mount truss to structure 057-0213 over SB lanes only
  - Remove truss and signage over SB & NB
  - Remove foundation
  - Remove 115' of existing guardrail

63100045  
Traffic Barrier Terminal, Type 2  
Sta. 154+64 to 154+76.5

63000001  
Steel Plate Beam Guardrail, Ty A, 6' Posts  
Sta. 154+76.5 to 156+89

63100167  
Traffic Barrier Terminal, Ty 1 Spl, Tangent  
Sta. 156+89 to 157+39

5-16 SBb  
5 S 057 I039 R001.90

- Install new "EXIT 2 / BUSN US 51" sign as a breakaway ground mount at the beginning of the ramp taper - Sta. 197+85.

5-15 NB  
5 S 057 I039 R001.00

- Remove truss and signage over SB & NB
- Remove foundation
- Remove 192' of existing guardrail

5-14 NB  
5 S 057 I039 R000.50

- Remove truss and signage over SB & NB
- Remove foundation
- Remove 65' of existing guardrail at NE quad of 057-0217

5-16 NB  
5 S 057 I039 R001.90

- Remove truss and signage over SB & NB
- Remove foundation
- Remove 116' of existing guardrail
- Install new distance guide sign as a breakaway ground mount at Sta. 200+30.

•VARIOUS COUNTIES  
••D-5 OVD SIN STR REPL 2012-06

FILE NAME =	USER NAME = ceerlockjd	DESIGNED - JAL	REVISED -	<b>STATE OF ILLINOIS DEPARTMENT OF TRANSPORTATION</b>	<b>MCLEAN COUNTY - I-39 OVERVIEW OF PROPOSED WORK</b>	F.A. RTE.	SECTION	COUNTY	TOTAL SHEETS	SHEET NO.	
cd:\pwwork\pwwork\ceerlockjd\0266557\0266557.dwg	46179-sht-details.dgn	DRAWN -	REVISED -			•	••	Various	178	97	
PLOT SCALE = 40.0000' / in.	CHECKED -	REVISIONS -	REVISIONS -			CONTRACT NO. 46179					
PLOT DATE = 10/7/2011	DATE = 04/26/11	REVISIONS -	REVISIONS -			ILLINOIS FED. AID PROJECT					