

EXISTING INFORMATION ONLY

ROUTE NO.	SECTION	COUNTY	TOTAL SHEETS	SHEET NO.
F.A.P. 412	4	McLEAN	33	31
STA. TO STA.		PROJECT		
# 57-259, 57-354		6 OF 10		

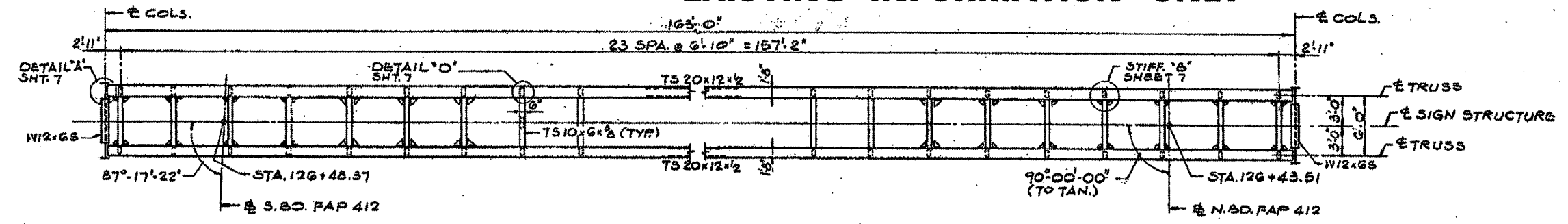

TOP PLAN

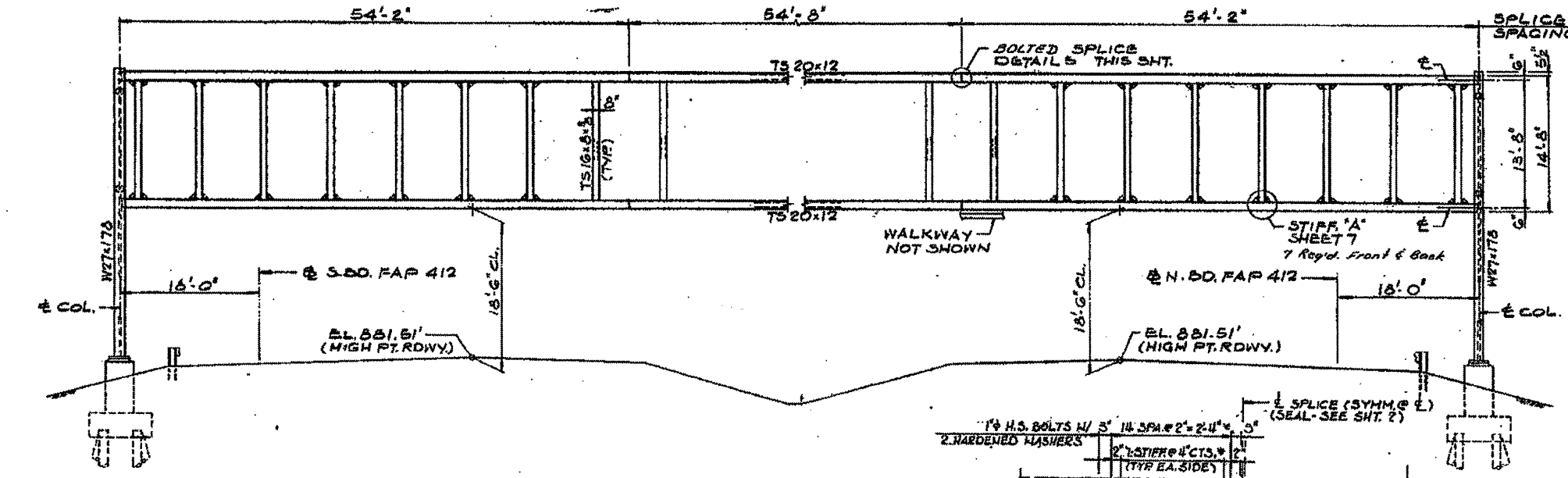

ELEVATION

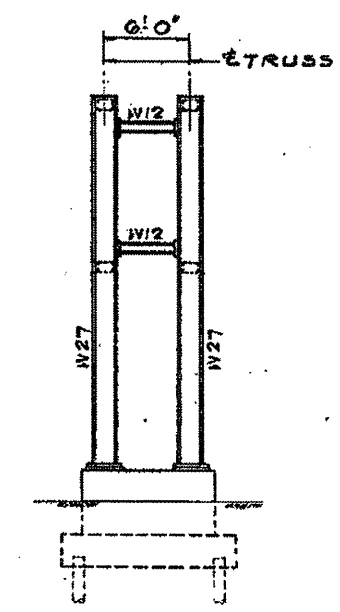

END VIEW

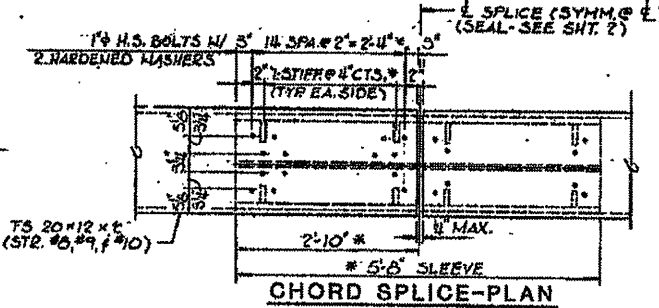

CHORD SPLICE-PLAN

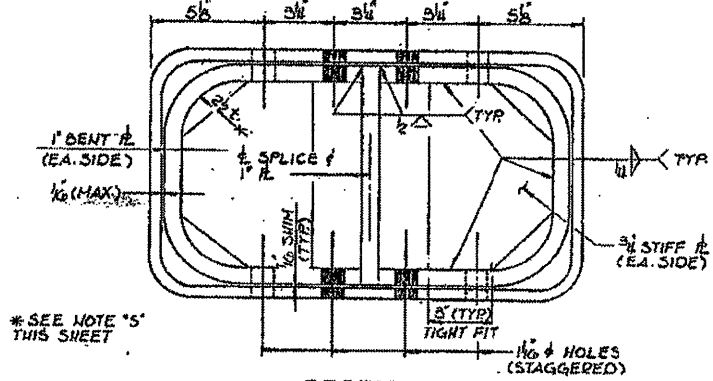

SECTION BOLTED SPLICE DETAILS

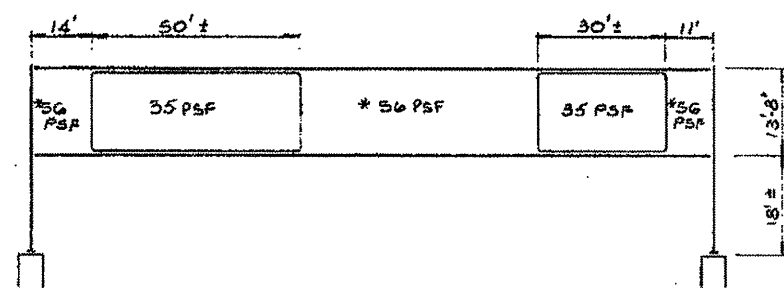

DESIGN WIND LOADING DIAGRAM C
* TOTAL LOAD FOR FRONT AND BACK MEMBERS.

BOLTED SPLICE NOTES

NOTE "S" FOR STRUCTURE #8, USE IN SPACES AT 1-3/4" WITH 1" DIAMETER HIGH-STRENGTH BOLTS AND 7 STIFFENERS AT 3-1/2" FOR 3'-0" SLEEVE.

NOTE: THE BOLTED SPLICE SHALL BE LOCATED AS SHOWN ON SHEETS 1 AND 6 OF 10. THE CONTRACTOR SHALL BE RESPONSIBLE FOR PROVIDING ALTERNATE SIGN PANEL SUPPORT DETAILS (SEE SHEET 3) TO THE ENGINEER FOR HIS APPROVAL WHERE BOLTED SPLICE LOCATIONS OCCUR.

NOTES:

ALL STRUCTURAL STEEL SHALL BE AASHTO M225 GR. 50 UNLESS OTHERWISE NOTED AS PER GENERAL NOTES.

FOR GENERAL NOTES SEE SHT. 1

SEE SHEETS 3 & 4 FOR WALKWAY LOCATIONS AND DETAILS.

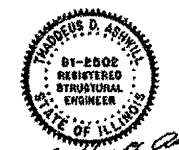

5 S 057 1039 R000.50

SIGN STRUCTURE # 10
GENERAL PLAN & DETAILS
F.A.P. ROUTE 412-SEC. 57-2SG
McLEAN COUNTY 57-3SG
STATION 126+43.61
STRUCTURE NUMBER # 10



FILE NAME =	USER NAME = cear-lock_jd	DESIGNED - JAL	REVISED -
\\pwwork\pwwork\cear-lock_jd\026655710	46179-shr-details.dgn	DRAWN -	REVISED -
PLOT SCALE = 40.0000' / 1" =		CHECKED -	REVISED -
PLOT DATE = 10/27/2011		DATE - 04/26/11	REVISED -

STATE OF ILLINOIS
DEPARTMENT OF TRANSPORTATION

AS-BUILTS FOR INFORMATION ONLY	
SCALE:	SHEET NO. OF SHEETS STA. TO STA.

F.A. RTE.	SECTION	COUNTY	TOTAL SHEETS	SHEET NO.
*	**	Various	178	136
CONTRACT NO. 46179				
ILLINOIS FED. AID PROJECT				

*VARIOUS COUNTIES
**0-5 OVD SIN STR REPL 2012-06