





TEMPORARY EROSION CONTROL NOTES

1. THE CONTRACTOR SHALL INSTALL PERIMETER EROSION BARRIER PRIOR TO STRIPPING OF VEGETATION.
2. TEMPORARY DITCH CHECKS SHALL BE INSTALLED IMMEDIATELY AFTER GRADING IS COMPLETED. DITCH CHECKS ARE BASED ON ONE (1) INSTALLATION AND THREE (3) REPLACEMENTS OVER THE DURATION OF THE CONTRACT. THESE ITEMS WILL BE PAID FOR PER LINEAL FOOT FOR THE ORIGINAL INSTALLATION, REGARDLESS OF THE TYPE OF CONFIGURATION USED.
3. RUNOFF FROM EXCAVATED AREAS SHALL LEAVE THE SITE THROUGH SEDIMENT CONTROL DEVICES. THE CONTRACTOR SHALL ADJUST HIS OPERATION AND IMPLEMENT EROSION CONTROL MEASURES ACCORDINGLY.
4. THE PERMIT ISSUED TO THE ILLINOIS DEPARTMENT OF TRANSPORTATION DOES NOT COVER IN-STREAM WORK BY THE CONTRACTOR. AFTER AWARD, THE CONTRACTOR WILL NEED TO COORDINATE AND HAVE A WORK PLAN APPROVED BY THE US ARMY CORPS OF ENGINEERS (USACOE). GUIDELINES ON ACCEPTABLE IN STREAM WORK TECHNIQUES CAN BE FOUND ON THE USACOE WEBSITE: <http://www.lrc.usage.army.mil/>.
5. THE CONTRACTOR SHALL SURROUND ANY NECESSARY EARTH STOCKPILES WITH PERIMETER EROSION BARRIER.
6. THE CONTRACTOR SHALL MAINTAIN ALL EROSION CONTROL DEVICES AT ALL TIMES. EROSION CONTROL DEVICES SHALL BE INSPECTED EVERY SEVEN CALENDAR DAYS OR WITHIN 24 HOURS AFTER A 13 MM (0.5 INCH) RAINFALL OR SNOWFALL.
7. THE CONTRACTOR SHALL SEED ALL DISTURBED AREAS AS SOON AS PRACTICAL AFTER CONSTRUCTION ACTIVITIES IN THAT AREA HAVE BEEN CONCLUDED. AREAS THAT HAVE STEEP SLOPES OR WILL NOT RECEIVE PERMANENT LANDSCAPING, SHALL BE TEMPORARILY SEEDED. ALL FLATTER AREAS OR AREAS WHERE NO FURTHER WORK IS TO OCCUR FOR ONE MONTH OR MORE SHALL BE SEEDED AND COVERED WITH EXCELSIOR BLANKET WITHIN SEVEN (7) CALENDAR DAYS.
8. THE CONTRACTOR WILL BE RESPONSIBLE FOR FILTERING ANY DIVERTED WATERS TO ELIMINATE SILT FROM BEING WASHED INTO THE I&M CANAL. THIS WATER DIVERSION SHALL BE IN ACCORDANCE TO THE REQUIREMENTS DETAILED ON SHEET #21 AND TO GBSP #15. THE CONTRACTOR WILL BE REQUIRED TO DEVELOP A PLAN TO FILTER THE DIVERTED WATERS TO THE SATISFACTION OF THE ENGINEER.

TEMPORARY EROSION CONTROL SEQUENCE OF CONSTRUCTION

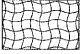
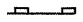
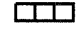
1. ESTABLISH TEMPORARY EROSION CONTROL AND ERECT PERIMETER EROSION CONTROL BARRIER AS SHOWN ON THE PLANS PRIOR TO EARTHWORK.
2. IMPLEMENT SEDIMENT AND EROSION CONTROL DEVICES FOR STOCKPILE AREAS AS REQUIRED.
3. CLEAN DRAINAGE FACILITIES AND REMOVE TEMPORARY EROSION DEVICES WITHIN 30 DAYS AFTER FINAL SITE STABILIZATION IS ACHIEVED.

LEGEND

-  COMPOST FURNISH AND PLACE, 4" W/ SEEDING, CL 4 AND EROSION CONTROL BLANKET
-  PERIMETER EROSION BARRIER
-  TEMPORARY DITCH CHECKS (STD 280001-04)
-  INLET FILTERS
-  INLET AND PIPE PROTECTON
-  INLET AND PIPE PROTECTON

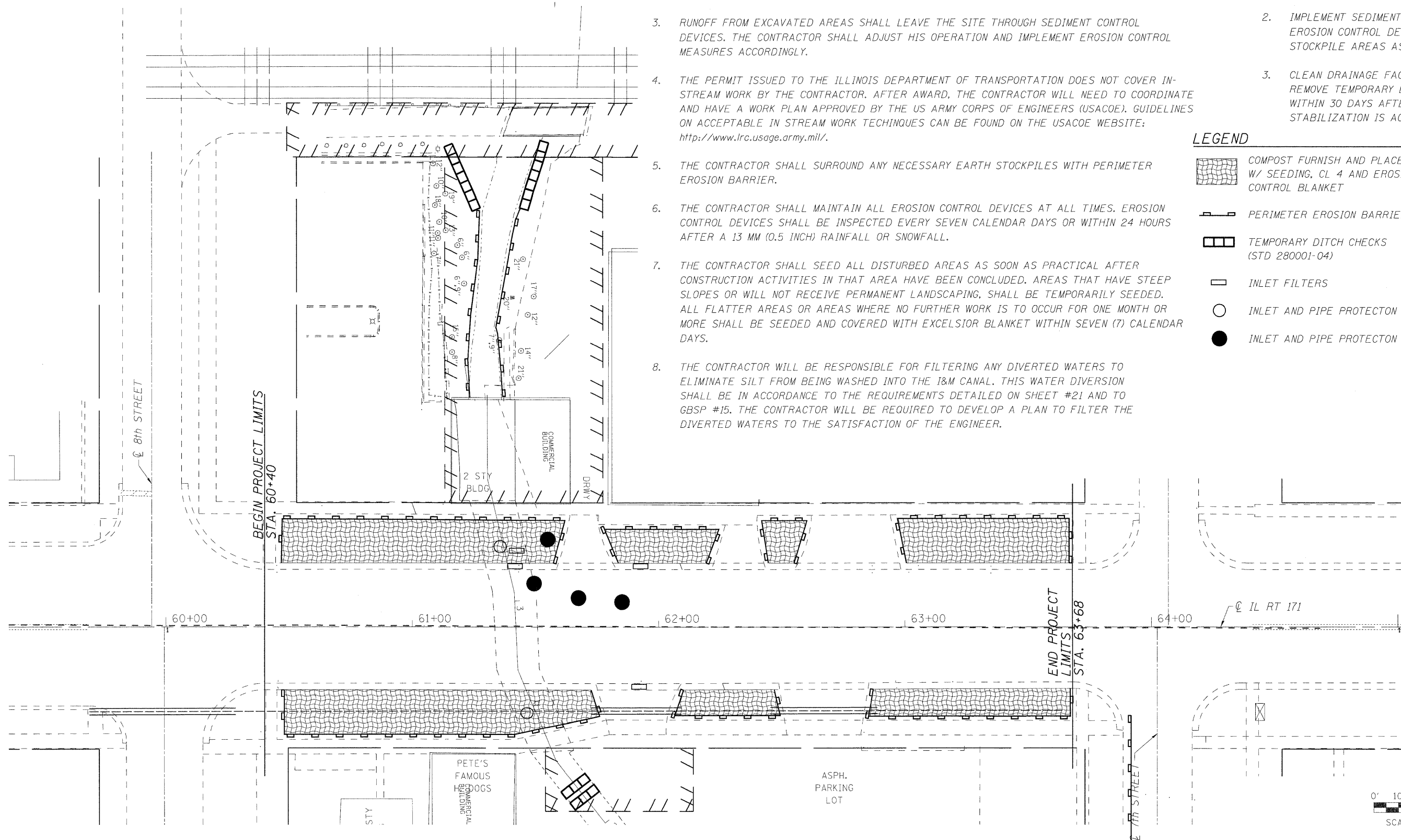

LONCO, INC.
CONSULTING ENGINEERS
1560 WALL ST, SUITE 222
NAPERVILLE, ILLINOIS 60563 Ph: 630/ 577-9100

DESIGNED - ST	REVISED -
DRAWN - ST	REVISED -
CHECKED - MJY, SLV	REVISED -
DATE - 10/14/2011	REVISED -

DESIGNED - ST	REVISED -
DRAWN - ST	REVISED -
CHECKED - MJY, SLV	REVISED -
DATE - 10/14/2011	REVISED -

**STATE OF ILLINOIS
DEPARTMENT OF TRANSPORTATION**

**EROSION CONTROL PLAN
IL ROUTE 171 OVER MILNE CREEK**

SCALE: NONE SHEET NO. 1 OF 1 SHEET STA. 60+40 TO STA. 63+68

F.A.P. RTE.	SECTION	COUNTY	TOTAL SHEETS	SHEET NO.
577	D-T	WILL	44	18
D-91-265-06			CONTRACT NO. 60B10	
FED. ROAD DIST. NO. ILLINOIS FED. AID PROJECT				