

**PRE-STAGE:**

- ESTABLISH TRAFFIC CONTROL SIGNS, AND BARRICADES ON FLEMING ROAD AND IL ROUTE 120
- REMOVE EXISTING SHOULDER ON NORTHBOUND SIDE OF FLEMING ROAD FROM STATION 209+00 TO 219+17.
- INSTALL TEMPORARY PAVEMENT ON NORTHBOUND SIDE OF FLEMING ROAD FROM STATION 209+00 TO 219+17.

**STAGE 1:**

- ESTABLISH STAGE 1 TEMPORARY TRAFFIC CONTROL SIGNS, AND BARRICADES, ON IL ROUTE 120 AND FLEMING ROAD.
- REMOVE EXISTING PAVEMENT AND SHOULDER ON SOUTHBOUND SIDE OF FLEMING ROAD FROM STATION 211+29 TO 219+15.
- INSTALL NEW PAVEMENT WITH SUBGRADE ON SOUTHBOUND SIDE OF FLEMING ROAD FROM STATION 211+29 TO 219+15.
- INSTALL TEMPORARY PAVEMENT ON SOUTHBOUND SIDE OF FLEMING ROAD FROM STATION 209+00 TO 218+12.4
- INSTALL NEW SHOULDER ON THE EASTBOUND LANE OF IL ROUTE 120 WEST OF FLEMING ROAD.
- PERFORM DITCH IMPROVEMENT WORK ON EASTBOUND SIDE OF IL ROUTE 120 WEST OF FLEMING ROAD.

**LEGEND:**

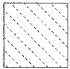
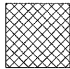
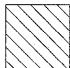
- (A) TEMPORARY PAVEMENT MARKING, TYPE III  
4" SOLID WHITE EDGE LINE
- (B) TEMPORARY PAVEMENT MARKING, TYPE III  
4" SOLID SINGLE YELLOW
- (C) TEMPORARY PAVEMENT MARKING, TYPE III  
4" SOLID DOUBLE YELLOW
-  WORK ZONE
-  TEMPORARY PAVEMENT, 9"
-  PAVEMENT AND SHOULDER REMOVAL

NOTE:  
"PCC TEMPORARY PAVEMENT SHALL CONSIST OF CLASS PV CONCRETE MEETING THE REQUIREMENTS OF ART. 1020 OF THE STANDARD SPECIFICATIONS".

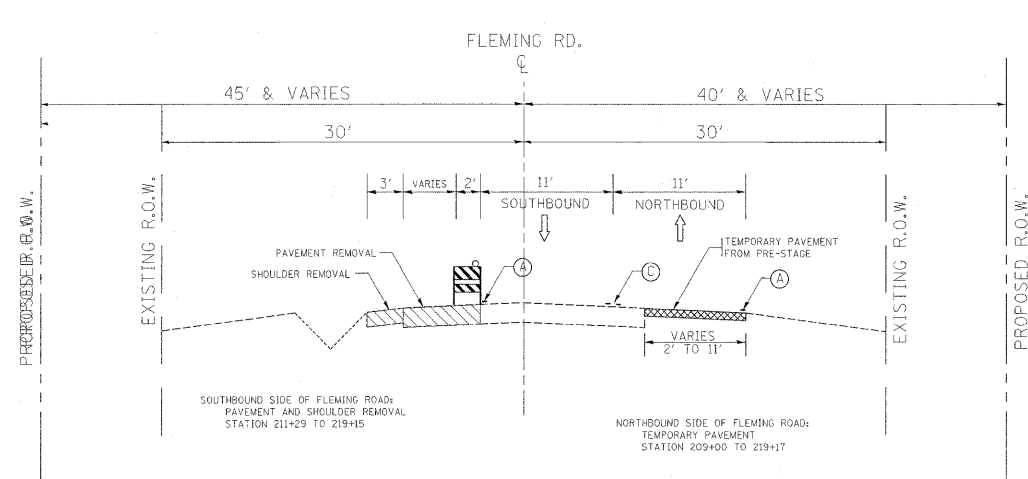

FLEMING ROAD  
STAGE 1 REMOVALS  
STA 211+29 TO 219+15

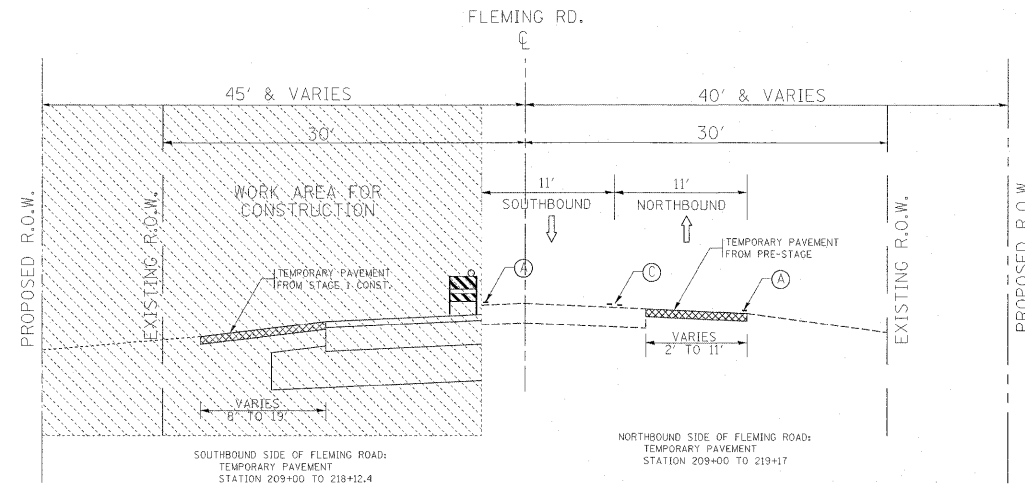

FLEMING ROAD  
STAGE 1 CONSTRUCTION  
STA 211+29 TO 219+15

|   |                            |            |           |   |  |           |           |      |                           |         |        |              |           |
|---|----------------------------|------------|-----------|---|--|-----------|-----------|------|---------------------------|---------|--------|--------------|-----------|
| FILE NAME =                               | USER NAME = golbenjr       | DESIGNED - | REVISED - | <b>STATE OF ILLINOIS<br/>DEPARTMENT OF TRANSPORTATION</b> | <b>STAGING DESCRIPTION AND TYPICAL SECTIONS<br/>FOR MAINTANCE OF TRAFFIC</b> |           |           |      | F.A.P. RTE.               | SECTION | COUNTY | TOTAL SHEETS | SHEET NO. |
| ct:\pw_work\pwidot\golbenjr\d0107803\PI13 | 07-Design.dgn              | DRAWN -    | REVISED - |   | 333  | 15-N-6    | MCHENRY   | 67   | 16                        |         |        |              |           |
|   | PLOT SCALE = 50.000' / in. | CHECKED -  | REVISED - |   | CONTRACT NO. 60L27   |           |           |      | ILLINOIS FED. AID PROJECT |         |        |              |           |
|   | PLOT DATE = 9/24/2011      | DATE -     | REVISED - |   | SCALE:   | SHEET NO. | OF SHEETS | STA. | TO STA.                   |         |        |              |           |