

**BEGIN PROJECT
STA. 123 + 00**

IL. RTE. 120

WORK ZONE

STATION 218+00

FLEMING RD.

FOR WIDENING AND RESURFACING OPERATIONS
THE SIGNING, BARRICADING, AND LANE CLOSURE
SHALL BE IN ACCORDANCE WITH STANDARD 701201
IN ADDITION TO THE SIGNS SHOWN.

FLEMING ROAD RECONSTRUCTION:
FROM STATION 211+29 TO STATION 219+15

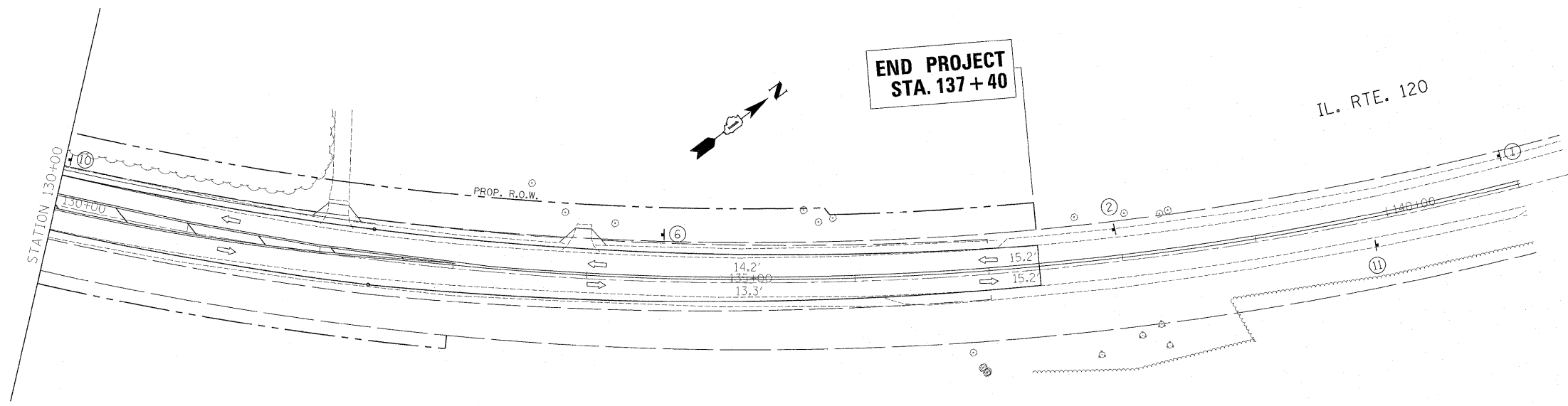

**END PROJECT
STA. 137 + 40**

IL. RTE. 120

LEGEND:

- (A) TEMPORARY PAVEMENT MARKING, TYPE III
4" SOLID WHITE EDGE LINE
- (B) TEMPORARY PAVEMENT MARKING, TYPE III
4" SOLID SINGLE YELLOW
- (C) TEMPORARY PAVEMENT MARKING, TYPE III
4" SOLID DOUBLE YELLOW
- (D) TEMPORARY PAVEMENT MARKING, TYPE III
8" SOLID WHITE LINE
- (E) TEMPORARY PAVEMENT MARKING, TYPE III
12" SOLID WHITE 45 DEGREE DIAGONALS
AT 10' OR LESS SPACING
- (F) TEMPORARY PAVEMENT MARKING, TYPE III
12" SOLID YELLOW 45 DEGREE DIAGONALS
AT LEAST 5 LINES EQUALLY SPACED
- (G) TEMPORARY PAVEMENT MARKING, TYPE III
24" SOLID WHITE (STOP BAR)
- BARRICADE TYPE I OR TYPE II OR REFLECTORIZED DRUM
OR VERTICAL PANEL WITH ONE BURN LIGHT.
- ⊥ TYPE III BARRICADE WITH 2 LIGHTS ONE SYMBOL
REPRESENTS ANY NUMBER OF BARRICADES REQUIRED
TO ADEQUATELY PROTECT THE AREA SHOWN.
- + CONSTRUCTION SIGN AND REFERENCE NUMBER
(REFER TO SIGN DETAIL LEGEND SHEET)
- ↑ TRAFFIC LANE

FOR WIDENING AND RESURFACING OPERATIONS
THE SIGNING, BARRICADING, AND LANE CLOSURE
SHALL BE IN ACCORDANCE WITH STANDARD 701201
IN ADDITION TO THE SIGNS SHOWN.

FILE NAME =	USER NAME = galbanjr	DESIGNED -	REVISED -	STATE OF ILLINOIS DEPARTMENT OF TRANSPORTATION	IL. ROUTE 120 FLEMING ROAD SUGGESTED STAGING & TRAFFIC CONTROL PLAN, STAGE 1				F.A.P. RTE.	SECTION	COUNTY	TOTAL SHEETS	SHEET NO.
ci:\pw_work\pwidet\galbanjr\d0107803\PI113	07-Design.dgn	DRAWN -	REVISED -		333	15-N-6	MCHENRY	67	20				
	PLOT SCALE = 50.000' / in.	CHECKED -	REVISED -		SCALE: SHEET NO. OF SHEETS STA. TO STA.				CONTRACT NO. 60L27				
	PLOT DATE = 9/30/2011	DATE -	REVISED -		ILLINOIS FED. AID PROJECT								