

FOR WIDENING AND RESURFACING OPERATIONS THE SIGNING, BARRICADING, AND LANE CLOSURE SHALL BE IN ACCORDANCE WITH STANDARD 701201 IN ADDITION TO THE SIGNS SHOWN.

FLEMING ROAD RECONSTRUCTION:  
FROM STATION 211+29 TO STATION 219+15

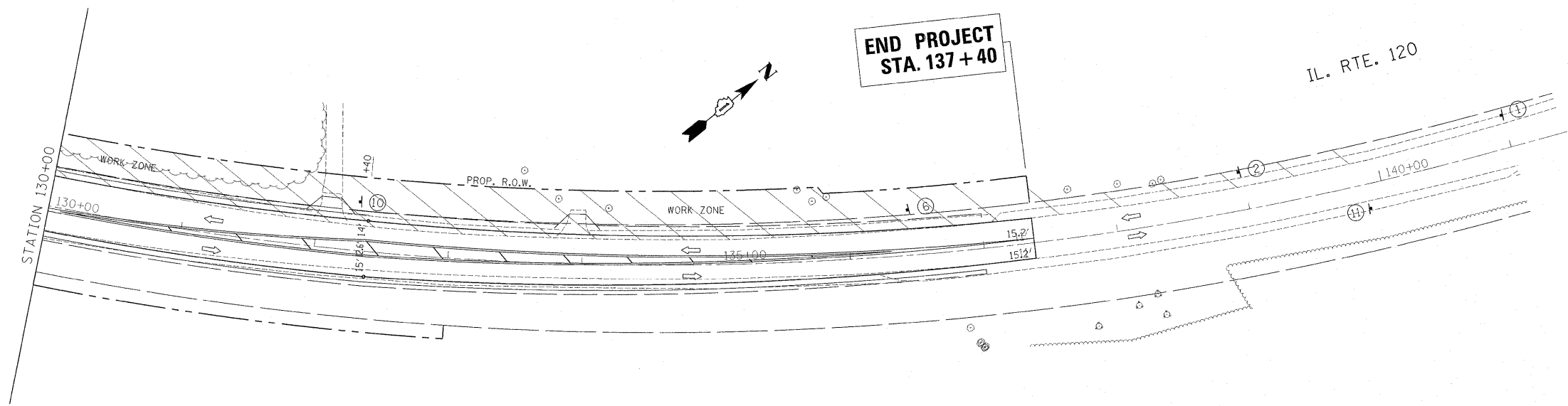

- LEGEND:**
- (A) TEMPORARY PAVEMENT MARKING, TYPE III  
4" SOLID WHITE EDGE LINE
  - (B) TEMPORARY PAVEMENT MARKING, TYPE III  
4" SOLID SINGLE YELLOW
  - (C) TEMPORARY PAVEMENT MARKING, TYPE III  
4" SOLID DOUBLE YELLOW
  - (D) TEMPORARY PAVEMENT MARKING, TYPE III  
8" SOLID WHITE LINE
  - (E) TEMPORARY PAVEMENT MARKING, TYPE III  
12" SOLID WHITE 45 DEGREE DIAGONALS  
AT 10' OR LESS SPACING
  - (F) TEMPORARY PAVEMENT MARKING, TYPE III  
12" SOLID YELLOW 45 DEGREE DIAGONALS  
AT LEAST 5 LINES EQUALLY SPACED
  - (G) TEMPORARY PAVEMENT MARKING, TYPE III  
24" SOLID WHITE (STOP BAR)
  - BARRICADE TYPE I OR TYPE II OR REFLECTORIZED DRUM  
OR VERTICAL PANEL WITH ONE BURN LIGHT.
  - ⊥ TYPE III BARRICADE WITH 2 LIGHTS ONE SYMBOL  
REPRESENTS ANY NUMBER OF BARRICADES REQUIRED  
TO ADEQUATELY PROTECT THE AREA SHOWN.
  - ⊕ CONSTRUCTION SIGN AND REFERENCE NUMBER  
(REFER TO SIGN DETAIL LEGEND SHEET)
  - ↑ TRAFFIC LANE

FOR WIDENING AND RESURFACING OPERATIONS THE SIGNING, BARRICADING, AND LANE CLOSURE SHALL BE IN ACCORDANCE WITH STANDARD 701201 IN ADDITION TO THE SIGNS SHOWN.

FILE NAME = c:\pwwork\pwwork\galbanjr\d0107803\p113	USER NAME = galbanjr 07-Design.dgn	DESIGNED - DRAWN -	REVISED - REVISED -	<b>STATE OF ILLINOIS DEPARTMENT OF TRANSPORTATION</b>	<b>IL. ROUTE 120 FLEMING ROAD SUGGESTED STAGING &amp; TRAFFIC CONTROL PLAN, STAGE 3</b>			F.A.P. RTE. 333	SECTION 16-N-6	COUNTY MCHENRY	TOTAL SHEETS 67	SHEET NO. 24
PLOT SCALE = 50.000' / in.	CHECKED -	REVISED -	REVISED -		SCALE:	SHEET NO. OF SHEETS	STA. TO STA.	CONTRACT NO. 60L27				
PLOT DATE = 9/30/2011	DATE -	REVISED -	REVISED -		ILLINOIS FED. AID PROJECT							