

PLAN	REVISIONS	DATE
NO.	BY	
NO.	BY	
NO.	BY	
NO.	BY	
NO.	BY	
NO.	BY	
NO.	BY	
NO.	BY	
NO.	BY	

FILE	REVISIONS	DATE
NO.	BY	
NO.	BY	
NO.	BY	
NO.	BY	
NO.	BY	
NO.	BY	
NO.	BY	
NO.	BY	
NO.	BY	

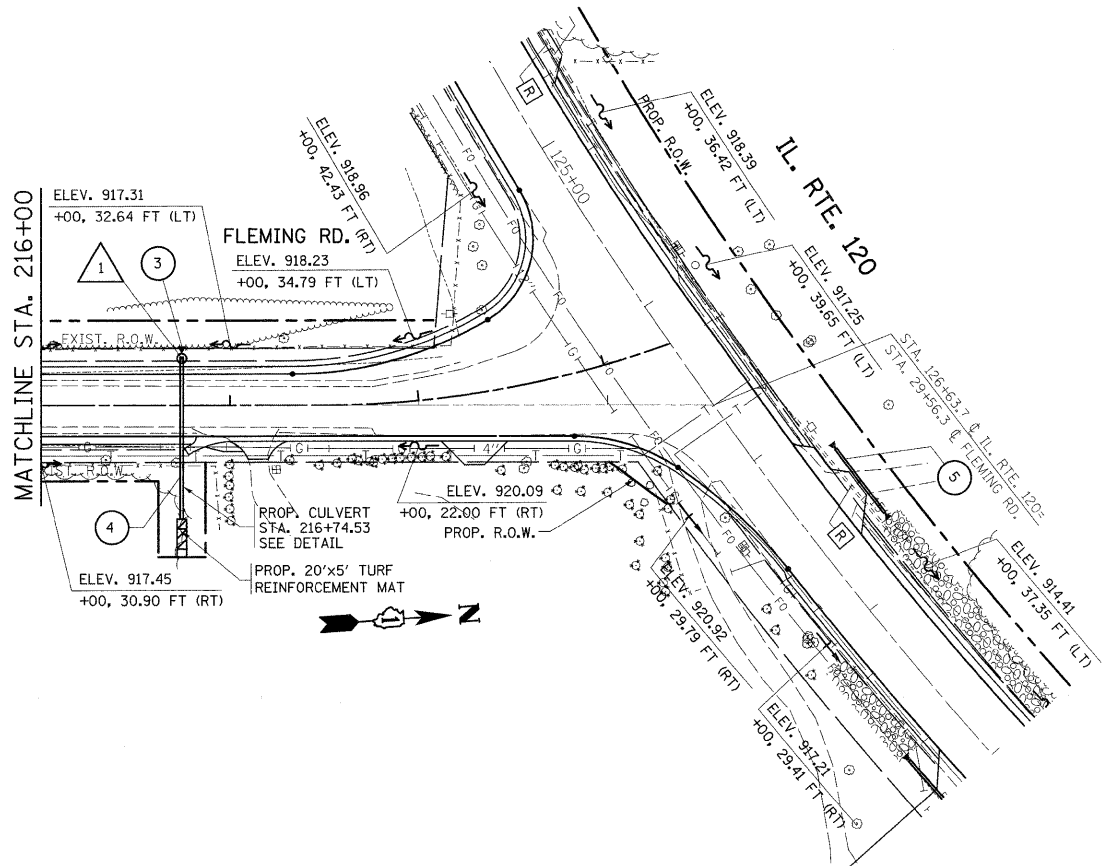

- 3 PRCF END SECTION, 15"
STA. 216+74.50, 32.86 FT. (LT)
INV. = 916.97 (W)
- 4 18" DIA. PIPE CULVERT
CLASS A, T-1, 82.78 FT.
W/1 PRCF END SECTION, 18"
INV. = 914.61
TBF = 10.64 CU. YD.

FLAT SLAB 1
MH, T-A, 4 FT. DIA., TIF CL
STA. 216+74+50, 24.86 FT. (LT)
T.G. = 919.38
INV. = 916.95 (W)
INV. = 914.82 (E)

SYMBOL LEGEND	
	REFERENCE LINE / CENTERLINE AND STATIONING
	RIGHT OF WAY LINE
	DRAINAGE DIVDE (HYDROLOGIC ATLAS)
	INTERPRETED DRAINAGE AREA TO OUTLET/SUB-DIVIDE
	DITCH
	OUTLET
	OVERFLOW
	CULVERT SIZE-TYPE
	SUMMIT
	SWALE

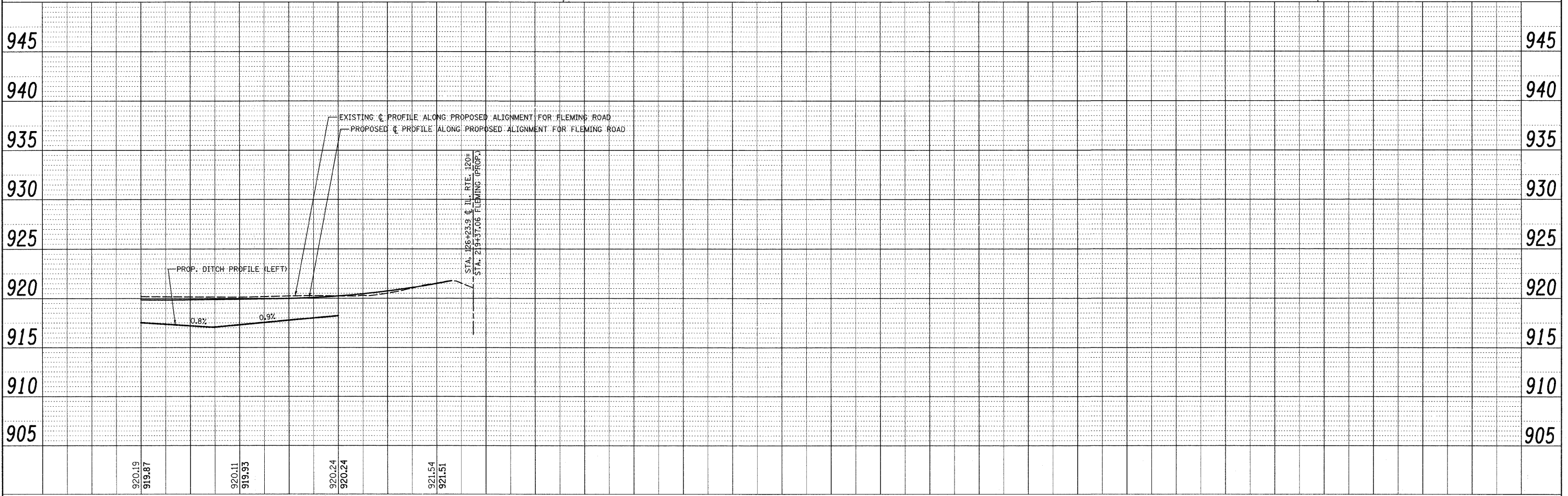

FILE NAME = P113707-sht-drain.dgn	USER NAME = beaverd	DESIGNED -	REVISED -	STATE OF ILLINOIS DEPARTMENT OF TRANSPORTATION	EXISTING AND PROPOSED DRAINAGE PLAN FLEMING RD IL. ROUTE 120			F.A.P. RTE. 333	SECTION 15-N-6	COUNTY MCHENRY	TOTAL SHEETS 67	SHEET NO. 28
PLOT SCALE = 50.0000' / in.	DATE = 9/16/2011	DRAWN -	REVISED -		SCALE: 1"=50'	SHEET NO. OF SHEETS	STA. 216+00 TO STA. 219+37	CONTRACT NO. 60L27				
		CHECKED -	REVISED -		FED. ROAD DIST. NO. ILLINOIS FED. AID PROJECT							
		DATE -	REVISED -									