

FINAL SURVEY	SURVEYED	BY	DATE
NOTE BOOK	PLOTTED		
NO.	TEMPLATE		
	AREAS CHECKED		
	AREAS		

ORIGINAL SURVEY	SURVEYED	BY	DATE
NOTE BOOK	PLOTTED		
NO.	TEMPLATE		
	AREAS CHECKED		
	AREAS		

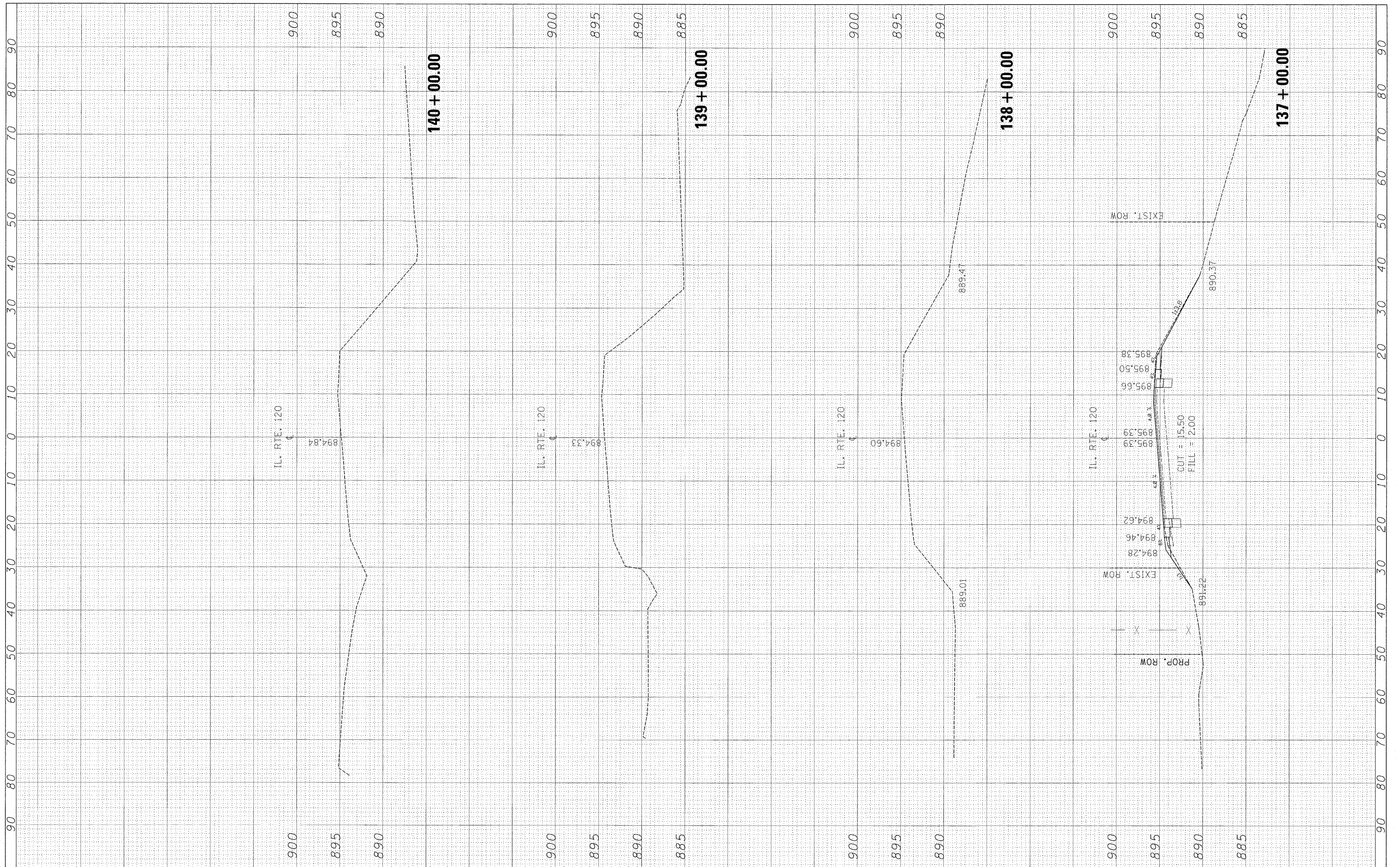

FILE NAME = c:\pwork\pwork\galbanjr\d0107803\F113727-sh	USER NAME = galbanjr	DESIGNED -	REVISED -	STATE OF ILLINOIS DEPARTMENT OF TRANSPORTATION	IL. RTE. 120 FLEMING RD. CROSS SECTIONS			F.A.P. RTE. 333	SECTION 15-N-6	COUNTY McHenry	TOTAL SHEETS 67	SHEET NO. 67
	xsht-11120-Design.dgn	DRAWN -	REVISED -		SCALE:	SHEET NO.	OF	SHEETS	STA. 137+00.00	TO STA. 140+00.00	ILLINOIS FED. AID PROJECT	
	PLOT SCALE = 10.0000' / 1in.	CHECKED -	REVISED -								CONTRACT NO.	
	PLOT DATE = 10/1/2011	DATE -	REVISED -								CONTRACT NO.	