

- GENERAL NOTES:
- 1) LIMIT OF RESURFACING ON THE SIDE-STREETS THROUGHOUT THE PROJECT SHALL BE TO THE RADIUS RETURN, UNLESS OTHERWISE SHOWN ON THE PLANS, OR AS DIRECTED BY THE RESIDENT ENGINEER.
  - 2) ALL RAISED REFLECTIVE PAVEMENT MARKERS SHALL BE PLACED IN ACCORDANCE WITH DISTRICT ONE "TYPICAL APPLICATIONS RAISED REFLECTIVE PAVEMENT MARKERS (SNOW-PLOW RESISTANT) (TC-11)" STANDARD DETAIL.
  - 3) ALL FINAL PAVEMENT MARKINGS SHALL BE THERMOPLASTIC (OF THE EXTRUDED TYPE) AND SHOULD BE PLACED IN ACCORDANCE WITH "DISTRICT ONE TYPICAL PAVEMENT MARKINGS (TC-13)" STANDARD DETAIL.
  - 4) ALL HMA SHOULDERS TO BE MILLED AND RESURFACED PER PROPOSED TYPICAL SECTION.

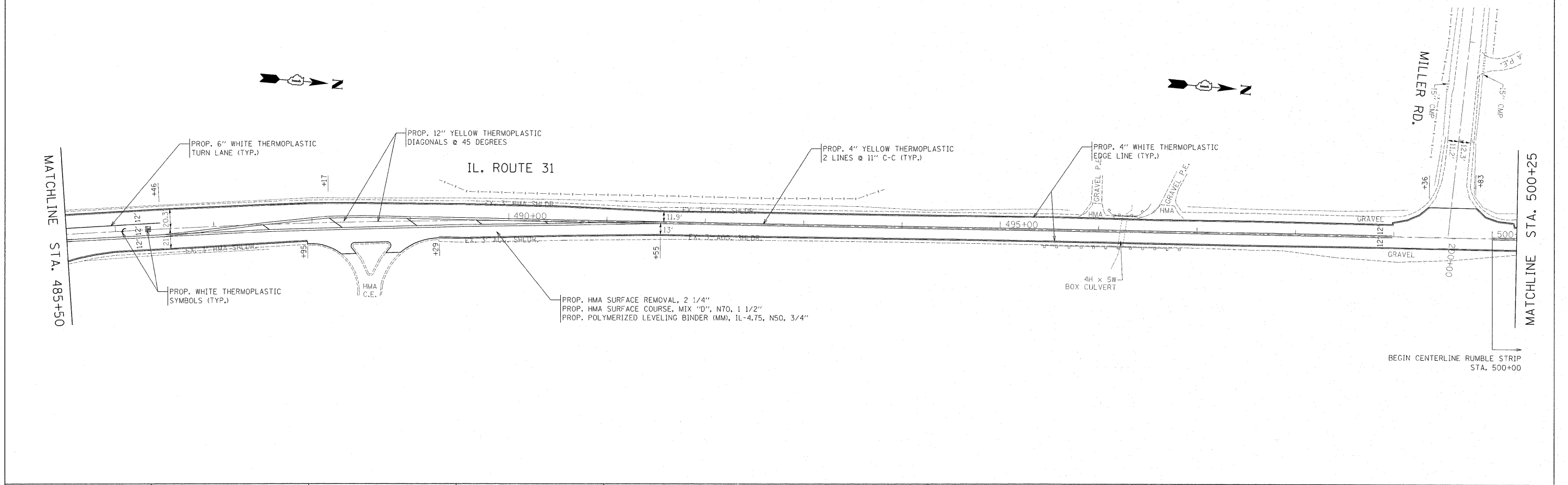

FILE NAME = c:\pwwork\pwwork\basksnmi\d0270394\0146611-sht-plan.dgn	USER NAME = basksnmi	DESIGNED -	REVISED -	<b>STATE OF ILLINOIS DEPARTMENT OF TRANSPORTATION</b>	<b>IL 31 (McHENRY COUNTY LINE - STROM DRIVE) ROADWAY &amp; PAVEMENT MARKINGS PLANS</b>	F.A.U. RTE. = 3887	SECTION = S-RS-5	COUNTY = KANE	TOTAL SHEETS = 33	SHEET NO. = 12
	PLOT SCALE = 50.0000' / 1" =	CHECKED -	REVISED -			SCALE: 1" = 50'	SHEET NO. 12 OF 33 SHEETS	STA. 354+00 TO STA. 598+71	CONTRACT NO. 60P12	
PLOT DATE = 10/25/2011	DATE -	REVISED -	REVISED -							