

- (A) PROP. THERMOPLASTIC PLASTIC PAVEMENT TURN LANE MARKING-LINE 6", WHITE (TYP.)
- (B) PROP. THERMOPLASTIC PAVEMENT MARKING-LINE 4", WHITE (TYP.)
- (C) PROP. THERMOPLASTIC PAVEMENT MARKING-LINE 4", YELLOW (TYP.)
- (D) PROP. THERMOPLASTIC PAVEMENT MARKING-LINE 8", WHITE (TYP.)
- (E) PROP. THERMOPLASTIC PAVEMENT MARKING-LINE 12", WHITE (TYP.)
- (F) PROP. THERMOPLASTIC PAVEMENT MARKING-LINE 4", 10' DASH-30' SKIP, WHITE (TYP.)
- (G) PROP. THERMOPLASTIC PAVEMENT MARKING LETTERS AND SYMBOLS, WHITE (TYP.)
- (H) PROP. THERMOPLASTIC PAVEMENT MARKING DOUBLE LINES 4" @ 11" C-C, YELLOW (TYP.)
- (I) PROP. THERMOPLASTIC PAVEMENT STOP MARKING-LINE 24", WHITE (TYP.)

- (1) PROP. HOT-MIX ASPHALT SURFACE REMOVAL, 2 1/2"
PROP. HMA SURFACE COURSE, MIX "D", N70, 1 1/2"
PROP. POLYMERIZED LEVELING BINDER COURSE (MACHINE METHOD), IL-4.75, N50, 1"

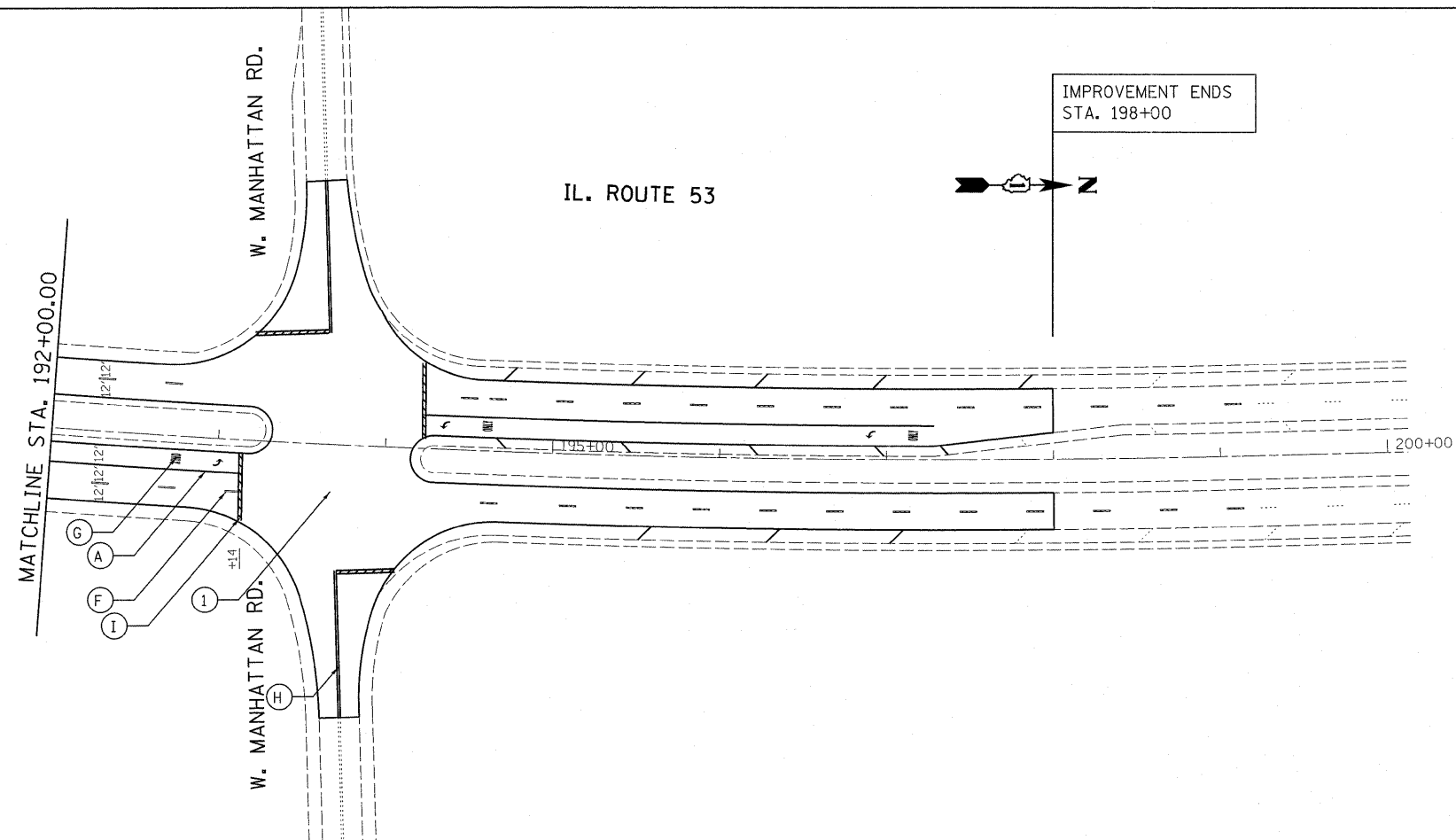
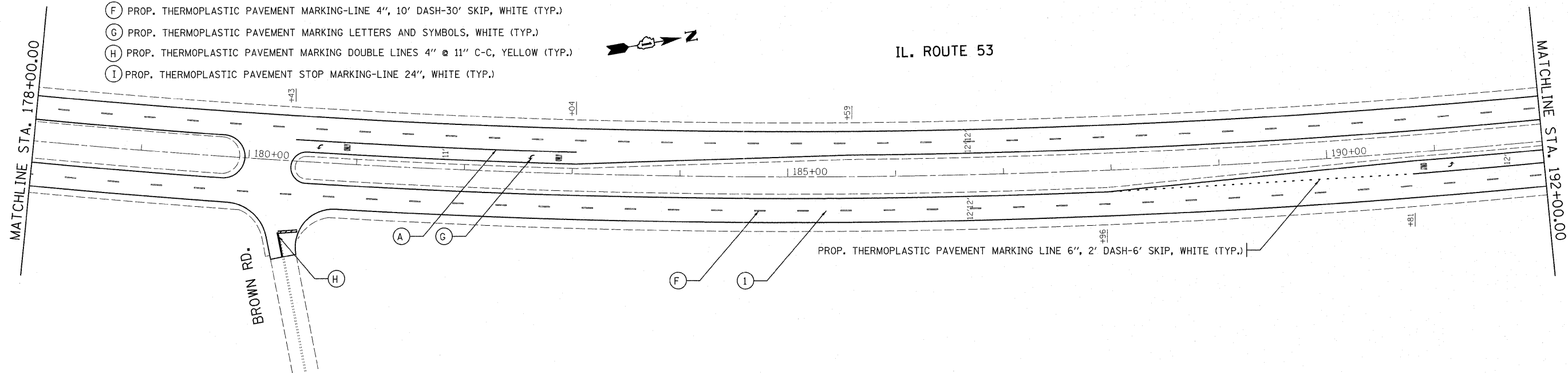

- (A) PROP. THERMOPLASTIC PLASTIC PAVEMENT TURN LANE MARKING-LINE 6", WHITE (TYP.)
- (B) PROP. THERMOPLASTIC PAVEMENT MARKING-LINE 4", WHITE (TYP.)
- (C) PROP. THERMOPLASTIC PAVEMENT MARKING-LINE 4", YELLOW (TYP.)
- (D) PROP. THERMOPLASTIC PAVEMENT MARKING-LINE 8", WHITE (TYP.)
- (E) PROP. THERMOPLASTIC PAVEMENT MARKING-LINE 12", WHITE (TYP.)
- (F) PROP. THERMOPLASTIC PAVEMENT MARKING-LINE 4", 10' DASH-30' SKIP, WHITE (TYP.)
- (G) PROP. THERMOPLASTIC PAVEMENT MARKING LETTERS AND SYMBOLS, WHITE (TYP.)
- (H) PROP. THERMOPLASTIC PAVEMENT MARKING DOUBLE LINES 4" @ 11" C-C, YELLOW (TYP.)
- (I) PROP. THERMOPLASTIC PAVEMENT STOP MARKING-LINE 24", WHITE (TYP.)

- (1) PROP. HOT-MIX ASPHALT SURFACE REMOVAL, 2 1/2"
PROP. HMA SURFACE COURSE, MIX "D", N70, 1 1/2"
PROP. POLYMERIZED LEVELING BINDER COURSE (MACHINE METHOD), IL-4.75, N50, 1"

FILE NAME = es:\pw_work\pwsdot\qureshiya\d0262790\DI48411-shr-plan.dgn	USER NAME = qureshiya	DESIGNED -	REVISED -	STATE OF ILLINOIS DEPARTMENT OF TRANSPORTATION	ROADWAY AND PAVEMENT MARKING PLANS IL 53 (MANHATTAN RD. TO HOFF RD.)			F.A.P. RTE. 846	SECTION 4R-RS-9	COUNTY WILL	TOTAL SHEETS 25	SHEET NO. 12
	PLOT SCALE = 50.0000' / in.	CHECKED -	REVISED -		SCALE: NONE	SHEET NO. 7 OF 7 SHEETS	STA. TO STA.	CONTRACT NO. 60P19				
PLOT DATE = 10/18/2011	DATE -	REVISED -	REVISED -	ILLINOIS FED. AID PROJECT								