

RESTORATION OF WORK AREA

RESTORATION OF THE TRAFFIC SIGNAL WORK AREA SHALL BE INCIDENTAL TO THE RELATED PAY ITEM SUCH AS FOUNDATION, CONDUIT, HANDHOLE, TRENCH AND BACKFILL, ETC., AND NO EXTRA COMPENSATION SHALL BE ALLOWED. ALL ROADWAY SURFACES SUCH AS SHOULDERS, MEDIANS, SIDEWALKS, PAVEMENT, ETC. SHALL BE REPLACED IN KIND. ALL DAMAGE TO MOWED LAWNS SHALL BE REPLACED WITH AN APPROVED SOD, AND ALL DAMAGE TO UNMOWED FIELDS SHALL BE SEEDING IN ACCORDANCE WITH STANDARD SPECIFICATIONS 252 AND 250 RESPECTIVELY.

NOTE:

THE ENVIRONMENTAL FIRM IS REQUIRED TO CONTINUOUSLY MONITOR FOR WORKER PROTECTION AND SOIL CONTAMINATION AT SEVERAL AREAS. SEE SPECIAL PROVISION AND SUPPLEMENTAL SPECIFICATIONS FOR DETAILS.

THE FOLLOWING ITEMS SHALL BE REMOVED BY THE CONTRACTOR AND SHALL BE DISPOSED OF BY THEM OUTSIDE THE RIGHT-OF-WAY AT THEIR EXPENSE. THE SALVAGE VALUE OF THE REMOVED EQUIPMENT SHALL BE REFLECTED IN THE CONTRACT BID PRICE.

- 1 EACH CONTROLLER AND CABINET (COMPLETE, LESS EVP EQUIPMENT TO BE RELOCATED)
- 7 EACH PEDESTRIAN PUSHBUTTON
- 4 EACH TRAFFIC SIGNAL POST
- 1 EACH SERVICE INSTALLATION

THE FOLLOWING ITEMS SHALL BE REMOVED BY THE CONTRACTOR AND RETURNED TO THE VILLAGE OF OAK LAWN.

- 1 EACH LIGHT DETECTOR AMPLIFIER
- 4 EACH LIGHT DETECTOR

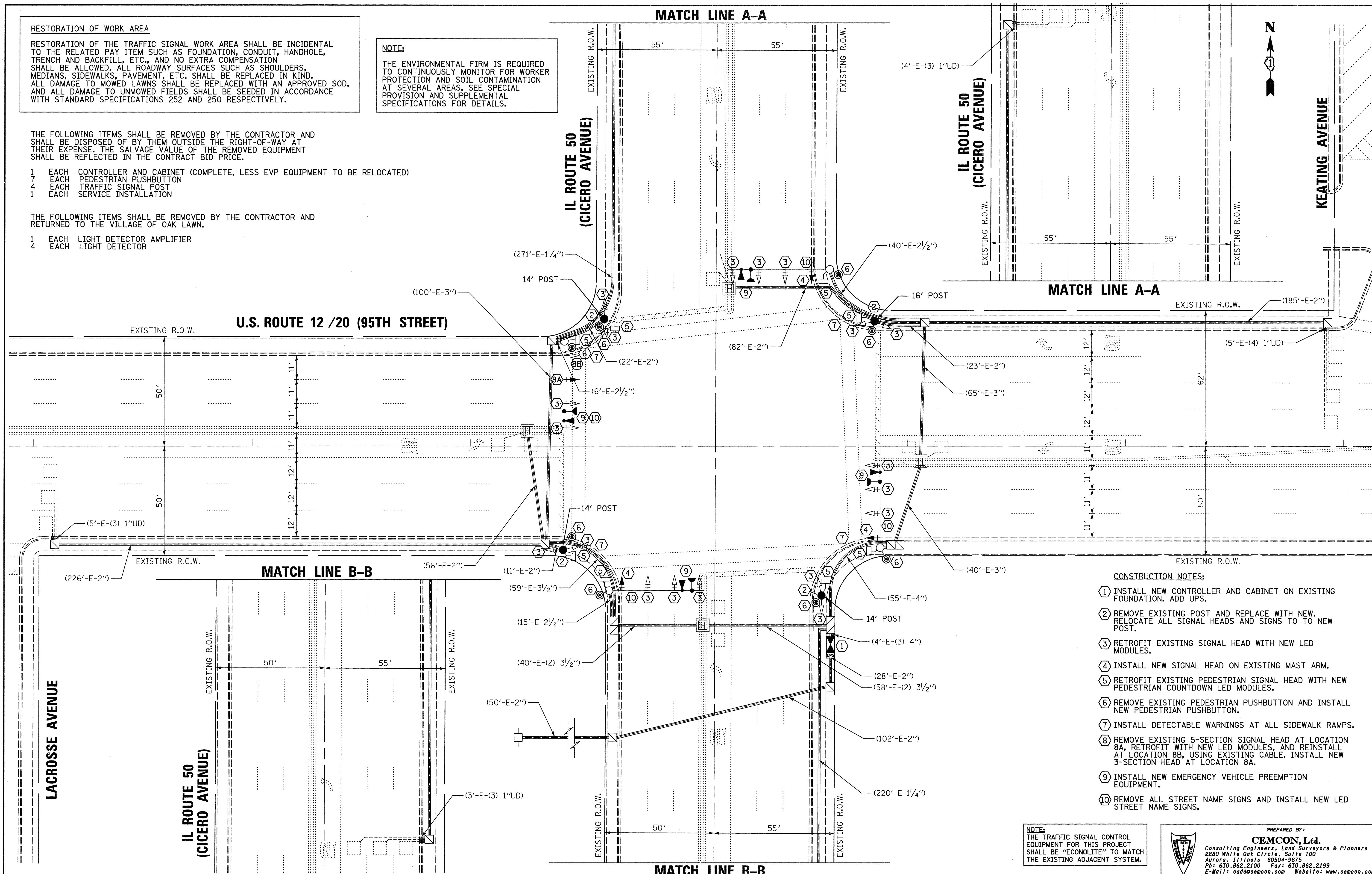

CONSTRUCTION NOTES:

- ① INSTALL NEW CONTROLLER AND CABINET ON EXISTING FOUNDATION. ADD UPS.
- ② REMOVE EXISTING POST AND REPLACE WITH NEW. RELOCATE ALL SIGNAL HEADS AND SIGNS TO NEW POST.
- ③ RETROFIT EXISTING SIGNAL HEAD WITH NEW LED MODULES.
- ④ INSTALL NEW SIGNAL HEAD ON EXISTING MAST ARM.
- ⑤ RETROFIT EXISTING PEDESTRIAN SIGNAL HEAD WITH NEW PEDESTRIAN COUNTDOWN LED MODULES.
- ⑥ REMOVE EXISTING PEDESTRIAN PUSHBUTTON AND INSTALL NEW PEDESTRIAN PUSHBUTTON.
- ⑦ INSTALL DETECTABLE WARNINGS AT ALL SIDEWALK RAMP.
- ⑧ REMOVE EXISTING 5-SECTION SIGNAL HEAD AT LOCATION 8A, RETROFIT WITH NEW LED MODULES, AND REINSTALL AT LOCATION 8B, USING EXISTING CABLE. INSTALL NEW 3-SECTION HEAD AT LOCATION 8A.
- ⑨ INSTALL NEW EMERGENCY VEHICLE PREEMPTION EQUIPMENT.
- ⑩ REMOVE ALL STREET NAME SIGNS AND INSTALL NEW LED STREET NAME SIGNS.

NOTE:
THE TRAFFIC SIGNAL CONTROL EQUIPMENT FOR THIS PROJECT SHALL BE "ECONOLITE" TO MATCH THE EXISTING ADJACENT SYSTEM.

PREPARED BY:
CEMCON, Ltd.
Consulting Engineers, Land Surveyors & Planners
2280 White Oak Circle, Suite 100
Aurora, Illinois 60504-9675
Ph: 630.862.2100 Fax: 630.862.2199
E-Mail: codd@cemcon.com Website: www.cemcon.com

FILE NAME = \MICROST\352098\ 95TH @ CICERO SIG.DGN	USER NAME = JGC	DESIGNED - BPT	REVISED -
PLOT SCALE = 1"=20'	CHECKED - BPT	DRAWN - JGC	REVISED -
PLOT DATE = 10-21-11	DATE - 10-21-11		REVISED -

**STATE OF ILLINOIS
DEPARTMENT OF TRANSPORTATION**

**TRAFFIC SIGNAL MODIFICATION PLAN
U.S. ROUTE 12 / 20 (95TH STREET) AT IL ROUTE 50 (CICERO AVENUE)**

SCALE: 1"=20' SHEET NO. OF SHEETS STA. TO STA.

F.A.P. RTE.	SECTION	COUNTY	TOTAL SHEETS	SHEET NO.
029	2011-038-TS	COOK	21	10
FED. ROAD DIST. NO.			ILLINOIS FED. AID PROJECT	
			CONTRACT NO. 60P44	

Rev. Sheet 1-5-12