

GENERAL NOTES:

1. ALL CONSTRUCTION SHALL BE DONE IN ACCORDANCE WITH THE "STANDARD SPECIFICATIONS FOR ROAD AND BRIDGE CONSTRUCTION" ADOPTED JANUARY 1, 2012 (HEREINAFTER REFERRED TO AS THE "STANDARD SPECIFICATIONS"); THE LATEST "SUPPLEMENTAL SPECIFICATIONS" AND "RECURRING SPECIAL PROVISIONS"; THE LATEST EDITION OF THE "ILLINOIS MANUAL ON UNIFORM TRAFFIC CONTROL DEVICES FOR STREETS AND HIGHWAYS"; THE DETAILS IN THE PLANS AND THE SPECIAL PROVISIONS INCLUDED IN THE CONTRACT DOCUMENTS.
2. ANY REFERENCE TO THE STANDARDS THROUGHOUT THE PLANS OR SPECIAL PROVISIONS SHALL BE INTERPRETED AS THE LATEST STANDARD OF THE ILLINOIS DEPARTMENT OF TRANSPORTATION.
3. THE CONTRACTOR SHALL NOTIFY J.U.L.I.E. (1-800-892-0123) AT LEAST 10 DAYS PRIOR TO CONSTRUCTION OF THE PROPOSED IMPROVEMENTS. ALL UTILITIES MUST BE NOTIFIED AND STAKED PRIOR TO CONSTRUCTION.
4. THE CONTRACTOR SHALL FAMILIARIZE HIMSELF WITH THE PLANS AND SHALL NOTIFY THE ENGINEER AT ONCE OF ANY DISCREPANCIES.
5. THE CONTRACTOR IS REQUIRED TO ATTEND AN ILLINOIS DEPARTMENT OF TRANSPORTATION (IDOT) PRECONSTRUCTION MEETING AND SHALL INFORM THE IDOT TRAFFIC ENGINEER BEFORE WORK COMMENCES.
6. THE CONTRACTOR SHALL KEEP PUBLIC STREET PAVEMENTS CLEAN OF DIRT AND DEBRIS.
7. THE CONTRACTOR SHALL BE RESPONSIBLE IN PROVIDING SAFE AND HEALTHFUL CONDITIONS THROUGHOUT THE CONSTRUCTION OF THE PROPOSED IMPROVEMENTS.
8. THE CONTRACTOR SHALL BE RESPONSIBLE FOR THE PROTECTION OF ALL UNDERGROUND AND SURFACE UTILITIES EVEN THOUGH THEY MAY NOT BE SHOWN ON THE PLANS. ANY UTILITY THAT IS DAMAGED DURING CONSTRUCTION SHALL BE RESTORED TO A CONDITION EQUAL TO THAT EXISTING BEFORE THE DAMAGE INCURRED. THIS WORK SHALL BE AT THE CONTRACTOR'S EXPENSE.
9. RESTORATION OF THE WORK AREA SHALL BE INCIDENTAL TO THE RELATED PAY ITEMS AND SHALL BE REPLACED IN KIND. ALL DAMAGE TO MOWED LAWNS SHALL BE REPLACED WITH AN APPROVED SOD, AND ALL DAMAGE TO UNMOWED FIELDS SHALL BE SEEDED IN ACCORDANCE WITH THE STANDARD SPECIFICATIONS 252 AND 250, RESPECTIVELY.
10. CONTROLLER CABINETS SHALL BE PLACED SO THAT a) THE DOORS OPEN AWAY FROM THE CURB OR TRAVEL WAY., b) AND THE TRAFFIC MOVEMENTS AT THE INTERSECTION ARE VISIBLE FROM THE CONTROLLER.
11. ANY CONTROLLER CABINET WHETHER NEW OR EXISTING TO RECEIVE UPS, WILL HAVE A "L" SHAPED 4 FOOT CONCRETE MAINTENANCE PAD INSTALLED. SEE PLANS FOR DETAIL. THE COST OF INSTALLATION OF CONCRETE PAD IS INCIDENTAL TO NEW CONTROLLER AND OR UPS INSTALLATIONS.
12. THE GENERAL CONTRACTOR IS REQUIRED TO HIRE AN ENVIRONMENTAL ENGINEERING FIRM TO CONTINUOUSLY MONITOR FOR WORKER SAFETY AND SOIL CONTAMINATION AT SEVERAL AREAS. SEE SPECIAL PROVISION AND SUPPLEMENTAL SPECIFICATIONS FOR DETAILS.

Rev. sheet 1-5-12

PREPARED BY:
CEMCON, Ltd.
 Consulting Engineers, Land Surveyors & Planners
 2280 White Oak Circle, Suite 100
 Aurora, Illinois 60504-9675
 Ph: 630.862.2100 Fax: 630.862.2199
 E-Mail: oad@cemcon.com Website: www.cemcon.com

FILE NAME = MICROST\352102\ 02-GENNOTES.DGN	USER NAME = JGC	DESIGNED - BPT	REVISED -	STATE OF ILLINOIS DEPARTMENT OF TRANSPORTATION	GENERAL NOTES				F.A.J. RTE.	SECTION	COUNTY	TOTAL SHEETS	SHEET NO.
	PLOT SCALE = NONE	DRAWN - JGC	REVISED -		IL ROUTE 83 (TORRENCE AVENUE) AT GLENWOOD DYER ROAD				2937	2011-040-TS	COOK	14	2
	PLOT DATE = 10-21-11	CHECKED - BPT	REVISED -		SCALE: N.T.S. SHEET NO. OF SHEETS STA. TO STA.				FED. ROAD DIST. NO. ILLINOIS FED. AID PROJECT CONTRACT NO. 60P46				

PAY CODE NUMBER	SUMMARY OF QUANTITIES ITEM	UNIT	URBAN	CONSTRUCTION TYPE CODE 0021
			TOTAL QUANTITY	TORRANCE AT GLENWOOD DYER QUANTITY
67000400	ENGINEER'S FIELD OFFICE, TYPE A	CAL MO	6	6 3 Δ
67100100	MOBILIZATION	L SUM	1	1
70102620	TRAFFIC CONTROL AND PROTECTION, STANDARD 701501	L SUM	1	1
70102635	TRAFFIC CONTROL AND PROTECTION, STANDARD 701701	L SUM	1	1
* 72000100	SIGN PANEL - TYPE 1	SQ FT	35.5	35.5
* 78000200	THERMOPLASTIC PAVEMENT MARKING - LINE 4"	FOOT	1121	1121
* 78000600	THERMOPLASTIC PAVEMENT MARKING - LINE 12"	FOOT	39	39
* 78000650	THERMOPLASTIC PAVEMENT MARKING - LINE 24"	FOOT	127	127
78300100	PAVEMENT MARKING REMOVAL	SQ FT	176	176
81028200	UNDERGROUND CONDUIT, GALVANIZED STEEL, 2" DIA.	FOOT	1473	1473
81028210	UNDERGROUND CONDUIT, GALVANIZED STEEL, 2 1/2" DIA.	FOOT	108	108
81028220	UNDERGROUND CONDUIT, GALVANIZED STEEL, 3" DIA.	FOOT	57	57
81028240	UNDERGROUND CONDUIT, GALVANIZED STEEL, 4" DIA.	FOOT	241	241
81400100	HANDHOLE	EACH	4	4
81400200	HEAVY DUTY HANDHOLE	EACH	9	9
81400300	DOUBLE HANDHOLE	EACH	1	1
85700200	FULL-ACTUATED CONTROLLER AND TYPE IV CABINET	EACH	1	1
87301225	ELECTRIC CABLE IN CONDUIT, SIGNAL NO. 14 3C	FOOT	250	250
87301245	ELECTRIC CABLE IN CONDUIT, SIGNAL NO. 14 5C	FOOT	1453	1453
87301255	ELECTRIC CABLE IN CONDUIT, SIGNAL NO. 14 7C	FOOT	1367	1367
87301305	ELECTRIC CABLE IN CONDUIT, LEAD-IN, NO. 14 1 PAIR	FOOT	2175	2175
87301805	ELECTRIC CABLE IN CONDUIT, SERVICE, NO. 6 2C	FOOT	224	224
87301900	ELECTRIC CABLE IN CONDUIT, EQUIPMENT GROUNDING CONDUCTOR, NO. 6 1C	FOOT	791	791
87502480	TRAFFIC SIGNAL POST, GALVANIZED STEEL 14 FT.	EACH	2	2
87502500	TRAFFIC SIGNAL POST, GALVANIZED STEEL 16 FT.	EACH	2	2
87700170	STEEL MAST ARM ASSEMBLY AND POLE, 26 FT.	EACH	2	2
87700210	STEEL MAST ARM ASSEMBLY AND POLE, 34 FT.	EACH	1	1
87700220	STEEL MAST ARM ASSEMBLY AND POLE, 36 FT.	EACH	1	1
87800100	CONCRETE FOUNDATION, TYPE A	FOOT	12	12
87800150	CONCRETE FOUNDATION, TYPE C	FOOT	4	4
87800400	CONCRETE FOUNDATION, TYPE E 30-INCH DIAMETER	FOOT	20	20
87800415	CONCRETE FOUNDATION, TYPE E 36-INCH DIAMETER	FOOT	22	22
88030020	SIGNAL HEAD, LED, 1-FACE, 3-SECTION, MAST-ARM MOUNTED	EACH	4	4
88030050	SIGNAL HEAD, LED, 1-FACE, 3-SECTION, BRACKET MOUNTED	EACH	2	2
88030110	SIGNAL HEAD, LED, 1-FACE, 5-SECTION, MAST-ARM MOUNTED	EACH	4	4
88030240	SIGNAL HEAD, LED, 2-FACE, 1-3 SECTION, 1-5 SECTION, BRACKET MOUNTED	EACH	4	4
88200210	TRAFFIC SIGNAL BACKPLATE, LOUVERED, ALUMINUM	EACH	8	8
88500100	INDUCTIVE LOOP DETECTOR	EACH	10	10
88600100	DETECTOR LOOP, TYPE 1	FOOT	660	660
88700200	LIGHT DETECTOR	EACH	2	2
88700300	LIGHT DETECTOR AMPLIFIER	EACH	1	1
89000100	TEMPORARY TRAFFIC SIGNAL INSTALLATION	EACH	1	1
89502375	REMOVE EXISTING TRAFFIC SIGNAL EQUIPMENT	EACH	1	1
89502380	REMOVE EXISTING HANDHOLE	EACH	8	8
89502385	REMOVE EXISTING CONCRETE FOUNDATION	EACH	7	7
X8730250	ELECTRIC CABLE IN CONDUIT, NO. 20 3/C, TWISTED, SHIELDED	FOOT	250	250
Z0030850	TEMPORARY INFORMATION SIGNING	SQ FT	51.4	51.4
Z0073510	TEMPORARY TRAFFIC SIGNAL TIMING	EACH	1	1
X8620200	UNINTERRUPTIBLE POWER SUPPLY SPECIAL	EACH	1	1

CUYD 45 45
L SUM 1 1
EACH 6 6

* 100% VILLAGE OF LYNWOOD
* Specialty Items

* 06900200 NON-SPECIAL WASTE DISPOSAL
* 06900450 SPECIAL WASTE PLANS AND REPORTS
* 06900530 SOIL DISPOSAL ANALYSIS

Rev. 1-5-12

FILE NAME = \MICROST\352102\ 03-SUMMARY.DGN

USER NAME = JGC	DESIGNED - BPT	REVISED -
PLOT SCALE = NONE	CHECKED - BPT	REVISED -
PLOT DATE = 10-21-11	DATE - 10-21-11	REVISED -

STATE OF ILLINOIS
DEPARTMENT OF TRANSPORTATION

SUMMARY OF QUANTITIES
IL ROUTE 83 (TORRENCE AVENUE) AT GLENWOOD DYER ROAD

SCALE: N.T.S. SHEET NO. OF SHEETS STA. TO STA.

PREPARED BY:
CEMCON, Ltd.
Consulting Engineers, Land Surveyors & Planners
2280 White Oak Circle, Suite 100
Aurora, Illinois 60504-9875
PH: 630.962.2100 Fax: 630.962.2199
E-Mail: cadd@cemcon.com Website: www.cemcon.com

F.A.U. RTE.	SECTION	COUNTY	TOTAL SHEETS	SHEET NO.
2937	2011-040-TS	COOK	14	3
FED. ROAD DIST. NO.			ILLINOIS FED. AID PROJECT	

THE FOLLOWING ITEMS SHALL BE REMOVED BY THE CONTRACTOR AND SHALL BE DISPOSED OF BY THEM OUTSIDE THE RIGHT-OF-WAY AT THEIR EXPENSE. THE SALVAGE VALUE OF THE REMOVED EQUIPMENT SHALL BE REFLECTED IN THE CONTRACT BID PRICE.

- 1 EACH CONTROLLER AND CABINET (COMPLETE)
- 3 EACH MAST ARM ASSEMBLY AND POLE, ALUMINUM
- 2 EACH TRAFFIC SIGNAL POST
- 4 EACH SIGNAL HEAD, 1-FACE, 3-SECTION, MAST ARM MOUNTED
- 4 EACH SIGNAL HEAD, 2-FACE, 3-SECTION, BRACKET MOUNTED
- 4 EACH SIGNAL HEAD, 1-FACE, 3-SECTION, BRACKET MOUNTED

THE FOLLOWING EXISTING TRAFFIC SIGNAL EQUIPMENT SHALL BE REMOVED BY THE CONTRACTOR AND RETURNED TO IDOT.

- 1 EACH MAST ARM ASSEMBLY AND POLE, STEEL

RESTORATION OF WORK AREA

RESTORATION OF THE TRAFFIC SIGNAL WORK AREA SHALL BE INCIDENTAL TO THE RELATED PAY ITEM SUCH AS FOUNDATION, CONDUIT, HANDHOLE, TRENCH AND BACKFILL, ETC., AND NO EXTRA COMPENSATION SHALL BE ALLOWED. ALL ROADWAY SURFACES SUCH AS SHOULDERS, MEDIANS, SIDEWALKS, PAVEMENT, ETC. SHALL BE REPLACED IN KIND. ALL DAMAGE TO MOWED LAWNS SHALL BE REPLACED WITH AN APPROVED SOD, AND ALL DAMAGE TO UNMOWED FIELDS SHALL BE SEED IN ACCORDANCE WITH STANDARD SPECIFICATIONS 252 AND 250 RESPECTIVELY.

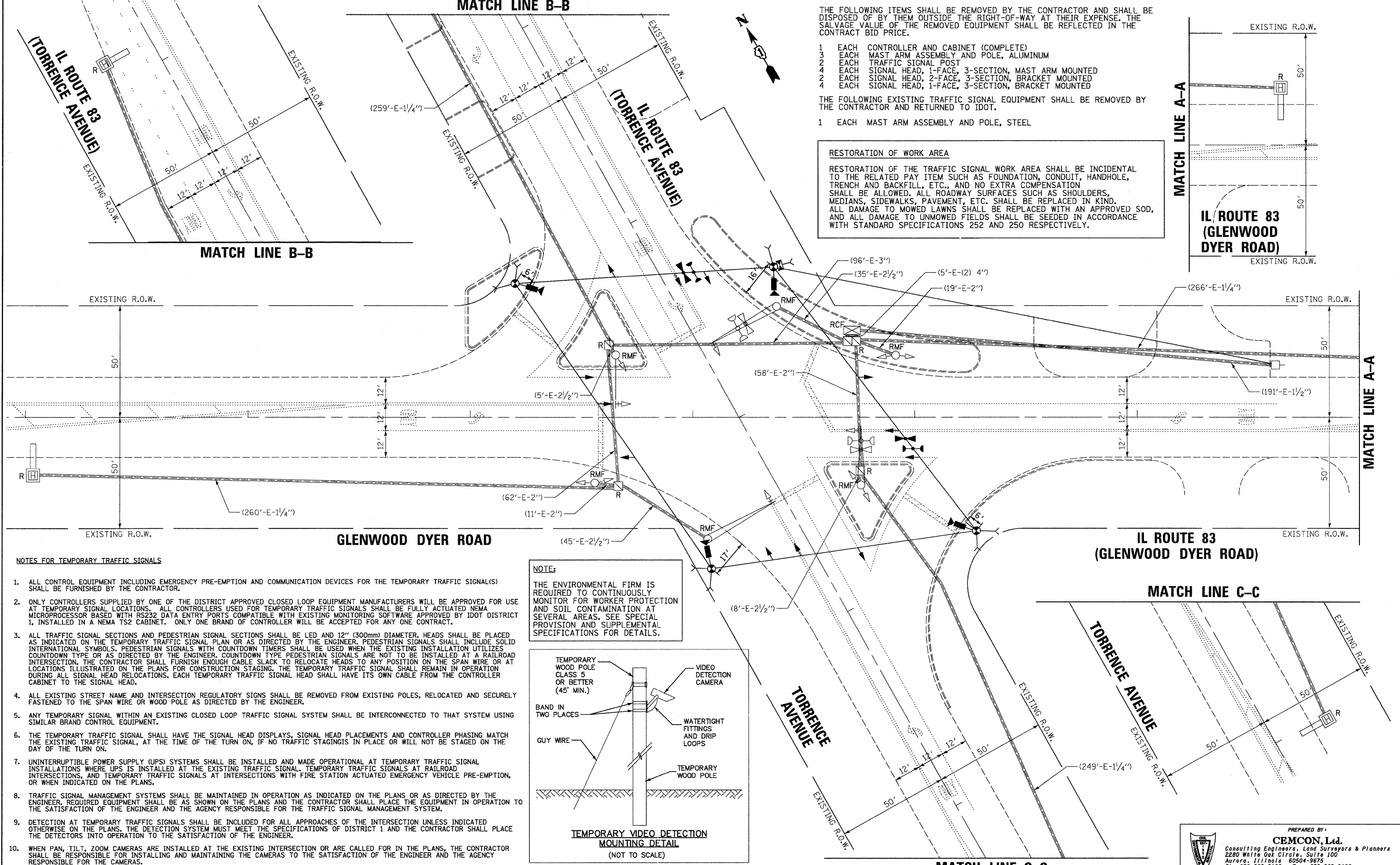

NOTES FOR TEMPORARY TRAFFIC SIGNALS

1. ALL CONTROL EQUIPMENT INCLUDING EMERGENCY PRE-EMPTION AND COMMUNICATION DEVICES FOR THE TEMPORARY TRAFFIC SIGNAL(S) SHALL BE FURNISHED BY THE CONTRACTOR.
2. ONLY CONTROLLERS SUPPLIED BY ONE OF THE DISTRICT APPROVED CLOSED LOOP EQUIPMENT MANUFACTURERS WILL BE APPROVED FOR USE AT TEMPORARY SIGNAL LOCATIONS. ALL CONTROLLERS USED FOR TEMPORARY TRAFFIC SIGNALS SHALL BE FULLY ACTUATED NEMA MICROPROCESSOR BASED WITH RS232 DATA ENTRY PORTS COMPATIBLE WITH EXISTING MONITORING SOFTWARE APPROVED BY IDOT DISTRICT 1, INSTALLED IN A NEMA TS2 CABINET. ONLY ONE BRAND OF CONTROLLER WILL BE ACCEPTED FOR ANY ONE CONTRACT.
3. ALL TRAFFIC SIGNAL SECTIONS AND PEDESTRIAN SIGNAL SECTIONS SHALL BE LED AND 12" (300mm) DIAMETER. HEADS SHALL BE PLACED AS INDICATED ON THE TEMPORARY TRAFFIC SIGNAL PLAN OR AS DIRECTED BY THE ENGINEER. PEDESTRIAN SIGNALS SHALL INCLUDE SOLID INTERNATIONAL SYMBOLS. PEDESTRIAN SIGNALS WITH COUNTDOWN TIMERS SHALL BE USED WHEN THE EXISTING INSTALLATION UTILIZES COUNTDOWN TYPE OR AS DIRECTED BY THE ENGINEER. COUNTDOWN TYPE PEDESTRIAN SIGNALS ARE NOT TO BE INSTALLED AT A RAILROAD INTERSECTION. THE CONTRACTOR SHALL FURNISH ENOUGH CABLE SLACK TO RELOCATE HEADS TO ANY POSITION ON THE SPAN WIRE OR AT LOCATIONS ILLUSTRATED ON THE PLANS FOR CONSTRUCTION STAGING. THE TEMPORARY TRAFFIC SIGNAL SHALL REMAIN IN OPERATION DURING ALL SIGNAL HEAD RELOCATIONS. EACH TEMPORARY TRAFFIC SIGNAL HEAD SHALL HAVE ITS OWN CABLE FROM THE CONTROLLER CABINET TO THE SIGNAL HEAD.
4. ALL EXISTING STREET NAME AND INTERSECTION REGULATORY SIGNS SHALL BE REMOVED FROM EXISTING POLES, RELOCATED AND SECURELY FASTENED TO THE SPAN WIRE OR WOOD POLE AS DIRECTED BY THE ENGINEER.
5. ANY TEMPORARY SIGNAL WITHIN AN EXISTING CLOSED LOOP TRAFFIC SIGNAL SYSTEM SHALL BE INTERCONNECTED TO THAT SYSTEM USING SIMILAR BRAND CONTROL EQUIPMENT.
6. THE TEMPORARY TRAFFIC SIGNAL SHALL HAVE THE SIGNAL HEAD DISPLAYS, SIGNAL HEAD PLACEMENTS AND CONTROLLER PHASING MATCH THE EXISTING TRAFFIC SIGNAL, AT THE TIME OF THE TURN ON, IF NO TRAFFIC STAGINGS IN PLACE OR WILL NOT BE STAGED ON THE DAY OF THE TURN ON.
7. UNINTERRUPTIBLE POWER SUPPLY (UPS) SYSTEMS SHALL BE INSTALLED AND MADE OPERATIONAL AT TEMPORARY TRAFFIC SIGNAL INSTALLATIONS WHERE UPS IS INSTALLED AT THE EXISTING TRAFFIC SIGNAL. TEMPORARY TRAFFIC SIGNALS AT RAILROAD INTERSECTIONS, AND TEMPORARY TRAFFIC SIGNALS AT INTERSECTIONS WITH FIRE STATION ACTUATED EMERGENCY VEHICLE PRE-EMPTION, OR WHEN INDICATED ON THE PLANS.
8. TRAFFIC SIGNAL MANAGEMENT SYSTEMS SHALL BE MAINTAINED IN OPERATION AS INDICATED ON THE PLANS OR AS DIRECTED BY THE ENGINEER. REQUIRED EQUIPMENT SHALL BE AS SHOWN ON THE PLANS AND THE CONTRACTOR SHALL PLACE THE EQUIPMENT IN OPERATION TO THE SATISFACTION OF THE ENGINEER AND THE AGENCY RESPONSIBLE FOR THE TRAFFIC SIGNAL MANAGEMENT SYSTEM.
9. DETECTION AT TEMPORARY TRAFFIC SIGNALS SHALL BE INCLUDED FOR ALL APPROACHES OF THE INTERSECTION UNLESS INDICATED OTHERWISE ON THE PLANS. THE DETECTION SYSTEM MUST MEET THE SPECIFICATIONS OF DISTRICT 1 AND THE CONTRACTOR SHALL PLACE THE DETECTORS INTO OPERATION TO THE SATISFACTION OF THE ENGINEER.
10. WHEN PAN, TILT, ZOOM CAMERAS ARE INSTALLED AT THE EXISTING INTERSECTION OR ARE CALLED FOR IN THE PLANS, THE CONTRACTOR SHALL BE RESPONSIBLE FOR INSTALLING AND MAINTAINING THE CAMERAS TO THE SATISFACTION OF THE ENGINEER AND THE AGENCY RESPONSIBLE FOR THE CAMERAS.

NOTE:
THE ENVIRONMENTAL FIRM IS REQUIRED TO CONTINUOUSLY MONITOR FOR WORKER PROTECTION AND SOIL CONTAMINATION AT SEVERAL AREAS. SEE SPECIAL PROVISION AND SUPPLEMENTAL SPECIFICATIONS FOR DETAILS.

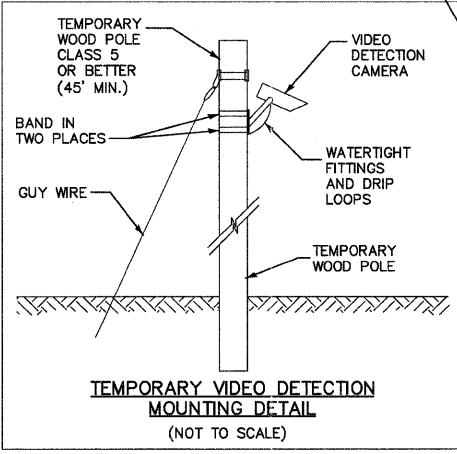

FILE NAME =	USER NAME = JGC	DESIGNED - BPT	REVISED -
\"MICROST\352102\" IL 83 e GLENWD TEMP SIG.DGN		DRAWN - RDS/JGC	REVISED -
	PLOT SCALE = 1\"=20'	CHECKED - BPT	REVISED -
	PLOT DATE = 10-21-11	DATE - 10-21-11	REVISED -

**STATE OF ILLINOIS
DEPARTMENT OF TRANSPORTATION**

**TEMPORARY TRAFFIC SIGNAL INSTALLATION AND REMOVAL PLAN
IL ROUTE 83 (TORRENCE AVENUE) AT GLENWOOD DYER ROAD**

SCALE: 1\"=20' SHEET NO. OF SHEETS STA. TO STA.

PREPARED BY:
CEMCON, Ltd.
Consulting Engineers, Land Surveyors & Planners
2280 White Oak Circle, Suite 100
Aurora, Illinois 60504-9675
Ph: 630.862.2100 Fax: 630.862.2199
E-Mail: cadd@cemcon.com Website: www.cemcon.com

F.A.U. RTE.	SECTION	COUNTY	TOTAL SHEETS	SHEET NO.
2937	2011-040-TS	COOK	14	10
FED. ROAD DIST. NO. [ILLINOIS] FED. AID PROJECT			CONTRACT NO. 60P46	

Rev. Sheet 1-5-12

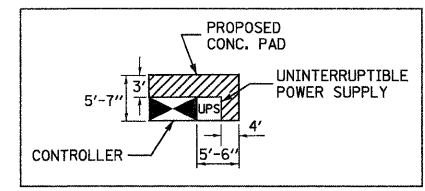
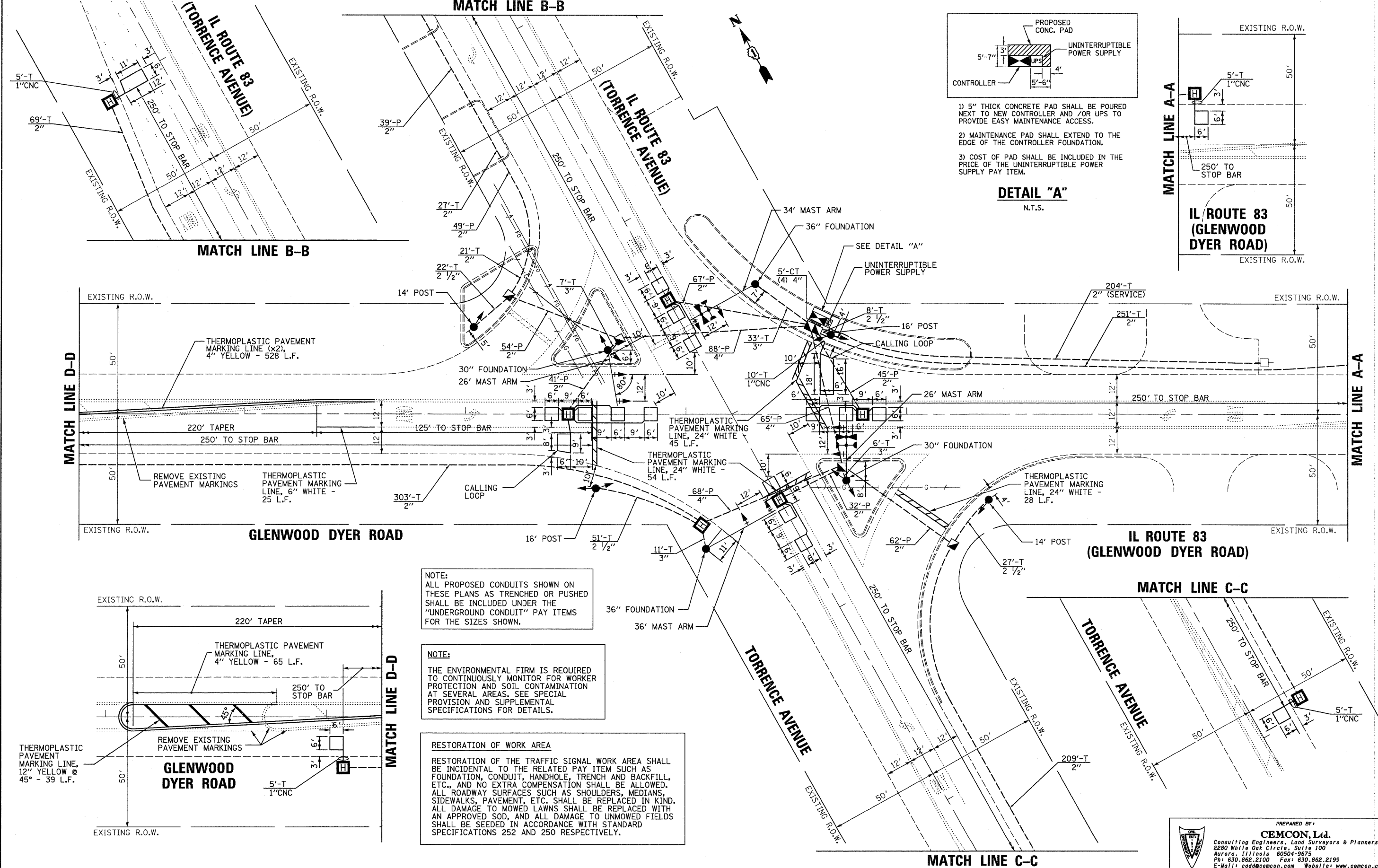

- 1) 5" THICK CONCRETE PAD SHALL BE POURED NEXT TO NEW CONTROLLER AND /OR UPS TO PROVIDE EASY MAINTENANCE ACCESS.
- 2) MAINTENANCE PAD SHALL EXTEND TO THE EDGE OF THE CONTROLLER FOUNDATION.
- 3) COST OF PAD SHALL BE INCLUDED IN THE PRICE OF THE UNINTERRUPTIBLE POWER SUPPLY PAY ITEM.

DETAIL "A"
N.T.S.

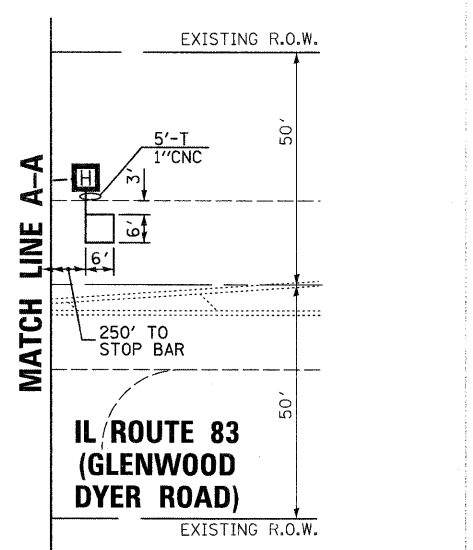

IL/ROUTE 83 (GLENWOOD DYER ROAD)

MATCH LINE D-D

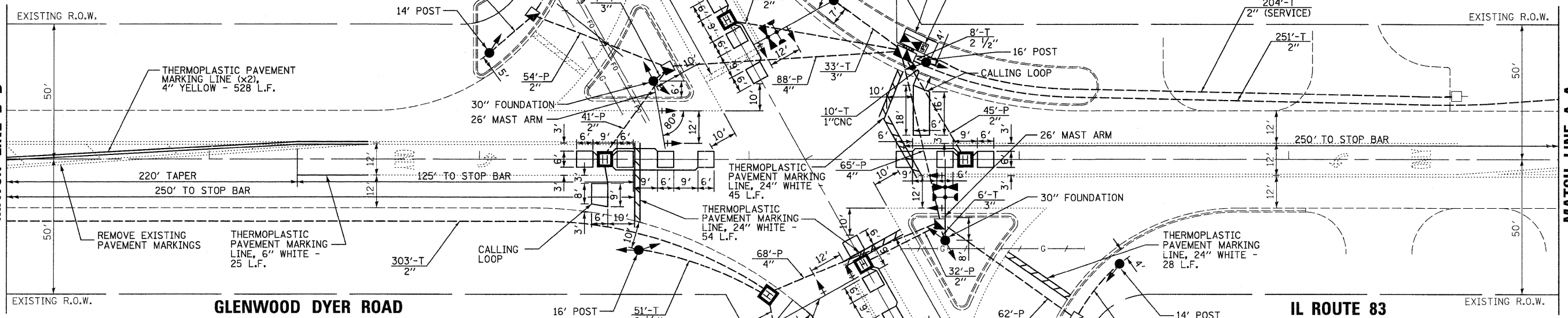

GLENWOOD DYER ROAD

MATCH LINE A-A

NOTE:
ALL PROPOSED CONDUITS SHOWN ON THESE PLANS AS TRENCHED OR PUSHED SHALL BE INCLUDED UNDER THE "UNDERGROUND CONDUIT" PAY ITEMS FOR THE SIZES SHOWN.

NOTE:
THE ENVIRONMENTAL FIRM IS REQUIRED TO CONTINUOUSLY MONITOR FOR WORKER PROTECTION AND SOIL CONTAMINATION AT SEVERAL AREAS. SEE SPECIAL PROVISION AND SUPPLEMENTAL SPECIFICATIONS FOR DETAILS.

RESTORATION OF WORK AREA
RESTORATION OF THE TRAFFIC SIGNAL WORK AREA SHALL BE INCIDENTAL TO THE RELATED PAY ITEM SUCH AS FOUNDATION, CONDUIT, HANDHOLE, TRENCH AND BACKFILL, ETC., AND NO EXTRA COMPENSATION SHALL BE ALLOWED. ALL ROADWAY SURFACES SUCH AS SHOULDERS, MEDIANS, SIDEWALKS, PAVEMENT, ETC. SHALL BE REPLACED IN KIND. ALL DAMAGE TO MOWED LAWNS SHALL BE REPLACED WITH AN APPROVED SOD, AND ALL DAMAGE TO UNMOWED FIELDS SHALL BE SEEDED IN ACCORDANCE WITH STANDARD SPECIFICATIONS 252 AND 250 RESPECTIVELY.

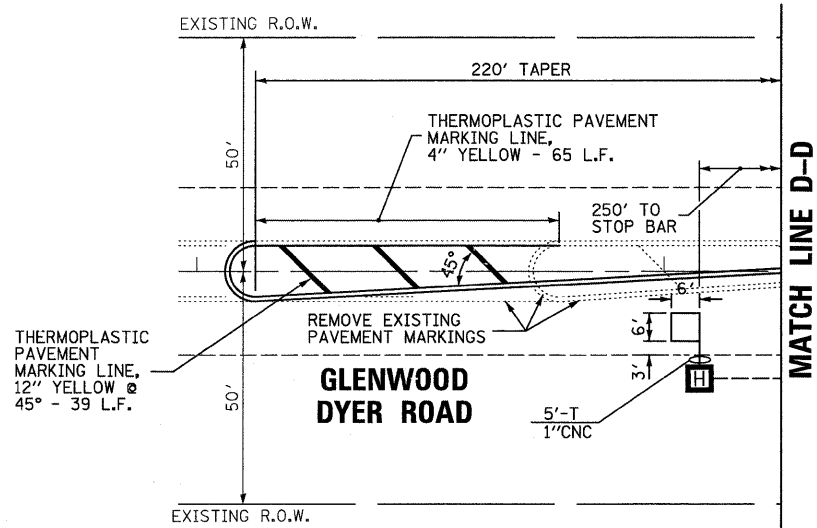

GLENWOOD DYER ROAD

MATCH LINE C-C

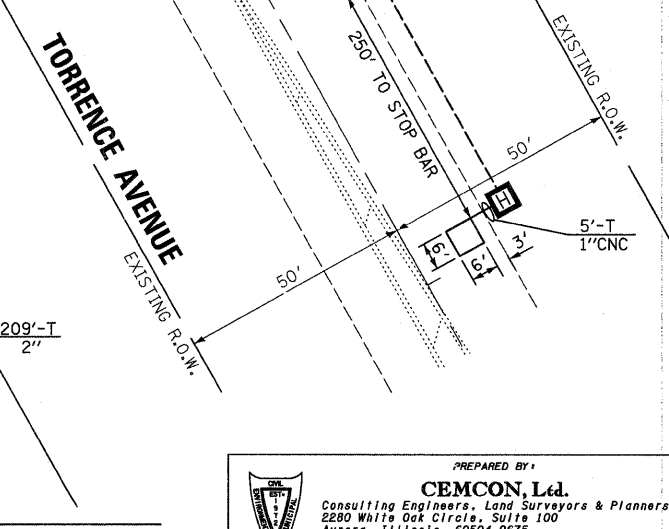

MATCH LINE C-C

FILE NAME =	USER NAME = JGC	DESIGNED - BPT	REVISED -
\\MICROST\352102\ IL 83 @ GLENWD SIG.DGN		DRAWN - RDS/JGC	REVISED -
	PLOT SCALE = 1"=20'	CHECKED - BPT	REVISED -
	PLOT DATE = 10-21-11	DATE - 10-21-11	REVISED -

STATE OF ILLINOIS
DEPARTMENT OF TRANSPORTATION

TRAFFIC SIGNAL MODERNIZATION PLAN
IL ROUTE 83 (TORRENCE AVENUE) AT GLENWOOD DYER ROAD

SCALE: 1"=20' SHEET NO. OF SHEETS STA. TO STA.

PREPARED BY:
CEMCON, Ltd.
Consulting Engineers, Land Surveyors & Planners
2280 White Oak Circle, Suite 100
Aurora, Illinois 60504-9675
Ph: 630.862.2100 Fax: 630.862.2199
E-Mail: codd@cemcon.com Website: www.cemcon.com

F.A.U. RTE.	SECTION	COUNTY	TOTAL SHEETS	SHEET NO.
2937	2011-040-TS	COOK	14	12
FED. ROAD DIST. NO. [ILLINOIS] FED. AID PROJECT			CONTRACT NO. 60P46	

Rev. Sheet 1-5-12