

|                         |                              |                       |                           |                           |
|-------------------------|------------------------------|-----------------------|---------------------------|---------------------------|
| <b>ROUTE</b><br>VARIOUS | <b>SECTION</b><br>2011-050-I | <b>COUNTY</b><br>COOK | <b>TOTAL SHEETS</b><br>69 | <b>SHEET NUMBER</b><br>10 |
|-------------------------|------------------------------|-----------------------|---------------------------|---------------------------|

CONTRACT NO. 60P60

**TRAFFIC DATA**

**33<sup>RD</sup> ST**  
 2000 ADT = 9009  
 POSTED SPEED LIMIT = 30 MPH  
**I-90/94 DAN RYAN EXPY**  
 2009 ADT = 260900  
 POSTED SPEED LIMIT = 55 MPH

**47<sup>TH</sup> ST**  
 2010 ADT = 11900  
 POSTED SPEED LIMIT = 30 MPH  
**I-90/94 DAN RYAN EXPY**  
 2009 ADT = 240800  
 POSTED SPEED LIMIT = 55 MPH

**35<sup>TH</sup> ST**  
 2010 ADT = 12700  
 POSTED SPEED LIMIT = 30 MPH  
**I-90/94 DAN RYAN EXPY**  
 2009 ADT = 250300  
 POSTED SPEED LIMIT = 55 MPH

**51<sup>ST</sup> ST**  
 2006 ADT = 20600  
 POSTED SPEED LIMIT = 30 MPH  
**I-90/94 DAN RYAN EXPY**  
 2009 ADT = 215000  
 POSTED SPEED LIMIT = 55 MPH

**39<sup>TH</sup> ST (PERSHING RD)**  
 2006 ADT = 15000  
 POSTED SPEED LIMIT = 30 MPH  
**I-90/94 DAN RYAN EXPY**  
 2009 ADT = 252700  
 POSTED SPEED LIMIT = 55 MPH

**55<sup>TH</sup> ST WB**  
 2010 ADT = 15100  
 POSTED SPEED LIMIT = 30 MPH  
**I-90/94 DAN RYAN EXPY**  
 2009 ADT = 209900  
 POSTED SPEED LIMIT = 55 MPH

**ROOT ST**  
 2010 ADT = 1350  
 POSTED SPEED LIMIT = 30 MPH  
**I-90/94 DAN RYAN EXPY**  
 2009 ADT = 248800  
 POSTED SPEED LIMIT = 55 MPH

**55<sup>TH</sup> ST**  
 2010 ADT = 15100  
 POSTED SPEED LIMIT = 30 MPH  
**I-90/94 DAN RYAN EXPY**  
 2009 ADT = 209900  
 POSTED SPEED LIMIT = 55 MPH

**43<sup>RD</sup> ST**  
 2010 ADT = 7000  
 POSTED SPEED LIMIT = 30 MPH  
**I-90/94 DAN RYAN EXPY**  
 2009 ADT = 248800  
 POSTED SPEED LIMIT = 55 MPH

**57<sup>TH</sup> ST**  
 1997 ADT = 5009  
 POSTED SPEED LIMIT = 30 MPH  
**I-90/94 DAN RYAN EXPY**  
 2009 ADT = 220900  
 POSTED SPEED LIMIT = 55 MPH

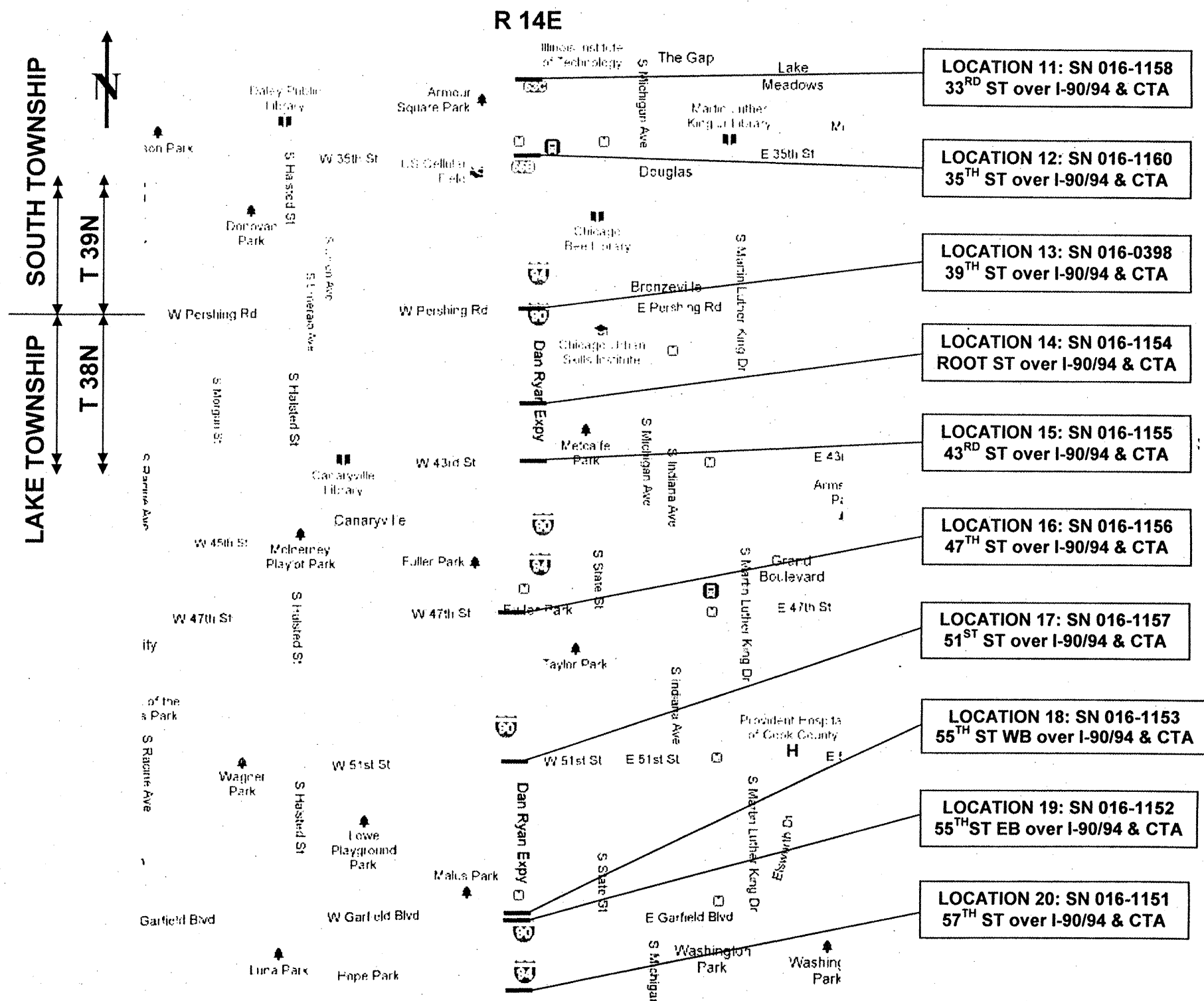

LOCATION 11: SN 016-1158  
33<sup>RD</sup> ST over I-90/94 & CTA

LOCATION 12: SN 016-1160  
35<sup>TH</sup> ST over I-90/94 & CTA

LOCATION 13: SN 016-0398  
39<sup>TH</sup> ST over I-90/94 & CTA

LOCATION 14: SN 016-1154  
ROOT ST over I-90/94 & CTA

LOCATION 15: SN 016-1155  
43<sup>RD</sup> ST over I-90/94 & CTA

LOCATION 16: SN 016-1156  
47<sup>TH</sup> ST over I-90/94 & CTA

LOCATION 17: SN 016-1157  
51<sup>ST</sup> ST over I-90/94 & CTA

LOCATION 18: SN 016-1153  
55<sup>TH</sup> ST WB over I-90/94 & CTA

LOCATION 19: SN 016-1152  
55<sup>TH</sup> ST EB over I-90/94 & CTA

LOCATION 20: SN 016-1151  
57<sup>TH</sup> ST over I-90/94 & CTA

ILLINOIS DEPARTMENT OF  
TRANSPORTATION  
  
LOCATION MAP 2  
LOCATIONS 11 - 20