

QUANTITY  
 4 (100) LINE = 64.1 ft. (19.7 m)  
 21.1 sq. ft. (1.97 sq. m)

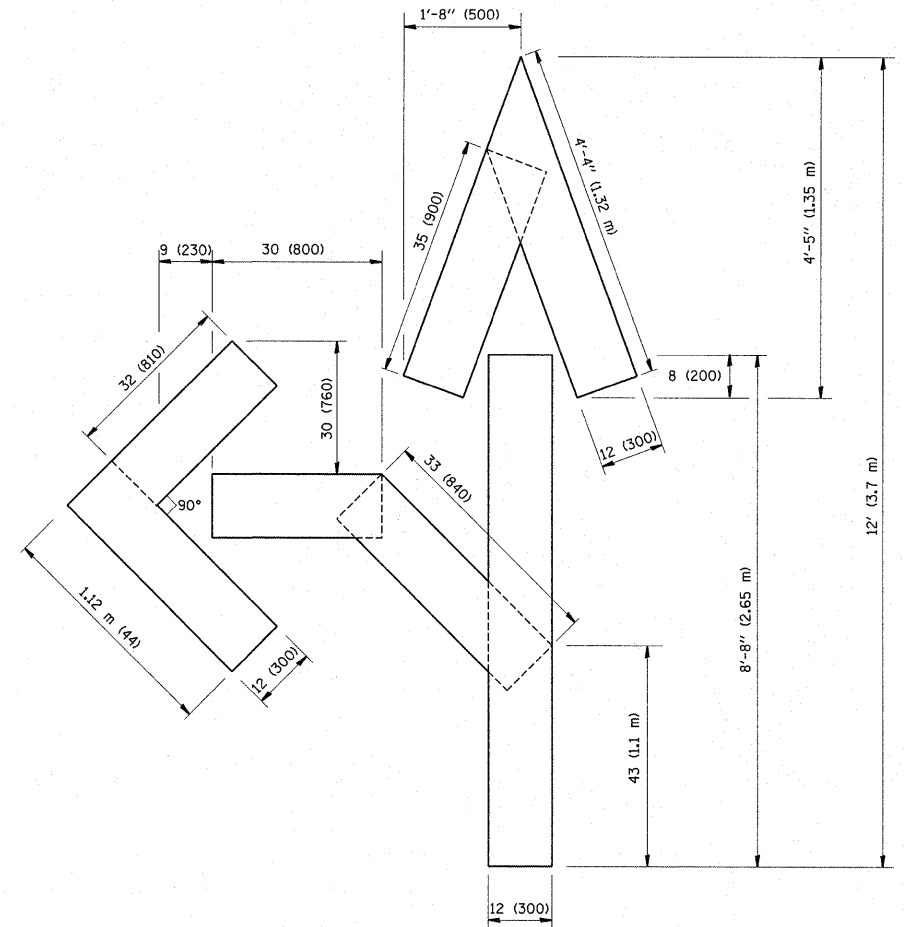

QUANTITY  
 4 (100) LINE = 82.5 ft. (25.3 m)  
 27.5 sq. ft. (2.53 sq. m)

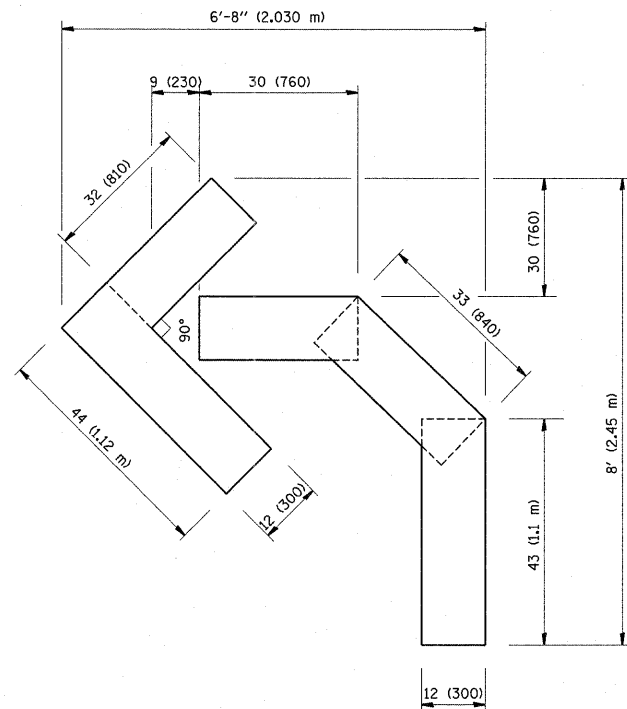

QUANTITY  
 4 (100) LINE = 45.5 ft. (13.9 m)  
 15.2 sq. ft. (1.39 sq. m)

All dimensions are in inches (millimeters) unless otherwise shown.

FILE NAME =	USER NAME = teriqf	DESIGNED -	REVISED -T. RAMMACHER 06-05-96
ct:\pw\work\p\p\tdot\teriqf\m\0273018\01st\d.dgn		DRAWN -	REVISED -T. RAMMACHER 11-04-97
PLOT SCALE = 50,0000 / 1		CHECKED -	REVISED -T. RAMMACHER 03-02-98
PLOT DATE = 10/21/2011		DATE - 09-18-94	REVISED -E. GOMEZ 08-28-00

**STATE OF ILLINOIS  
 DEPARTMENT OF TRANSPORTATION**

**PAVEMENT MARKING LETTERS AND SYMBOLS  
 FOR TRAFFIC STAGING**

F.A.P. RTE.	SECTION	COUNTY	TOTAL SHEETS	SHEET NO.
303	134-RS-3	LAKE	19	18
<b>TC-16</b>			<b>CONTRACT NO. 60P94</b>	
FED. ROAD DIST. NO. 1 ILLINOIS FED. AID PROJECT				

SCALE: NONE SHEET NO. 1 OF 1 SHEETS STA. TO STA.