

Existing Structures: S.N. 016-0486 and S.N. 016-0487

No Salvage.

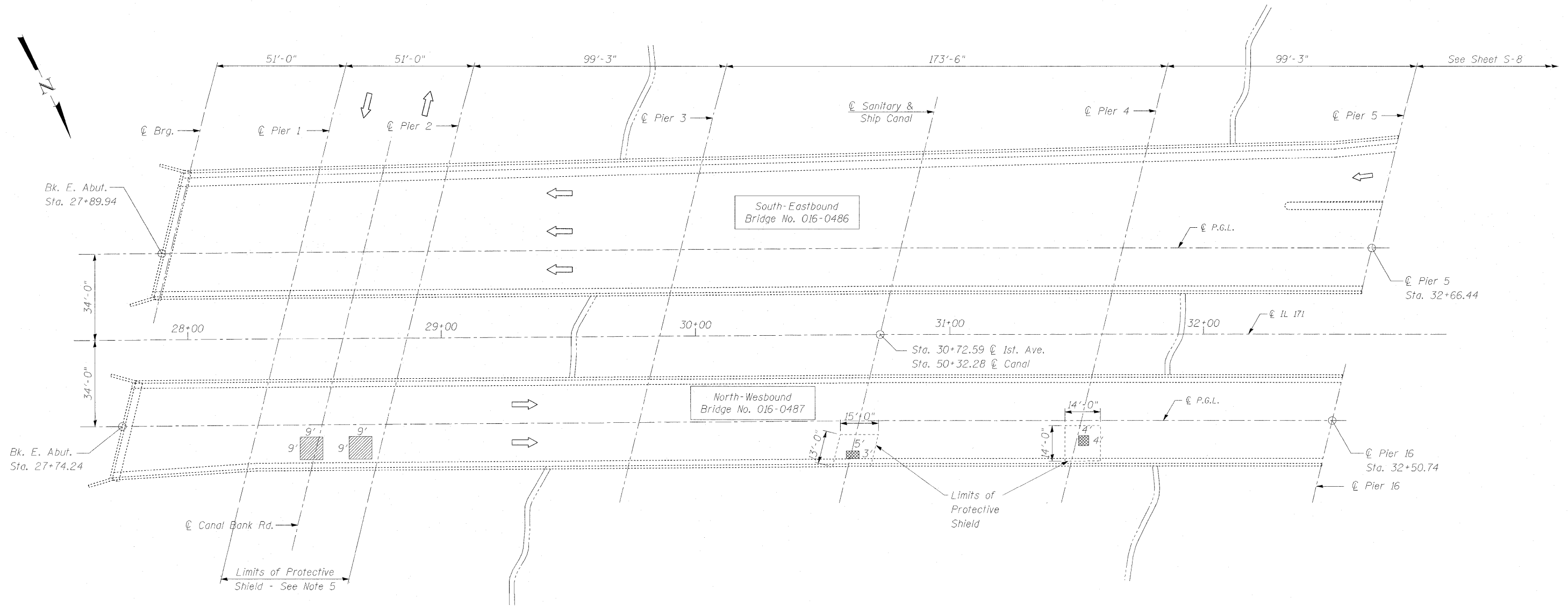

**Notes:**

- Repairs shall include but not be limited to the areas shown. The actual areas to be determined by the Engineer at the time of construction.
- The Engineer shall record the actual deck repair areas in order to document as-built conditions for the future reference.
- Care shall be exercised during concrete removal to protect the reinforcement bars and structural steel from damage.
- The Contractor shall make his own investigation to determine the existence, nature, and exact location of all utility lines and appurtenances within the limits of the work. Any damage to be repaired at the Contractor's expense.
- Quantities for protective shield have been included in the spans over traffic if full or partial depth repairs were recommended to be performed on that span. The calculated quantity considers the entire span where the repair is located, from half the width of the shoulder (five feet minimum beyond the edge of pavement or edge of sidewalk) on each side of the roadway.

**Legend:**

- Indicates Partial Deck Slab Repair
- Indicates Full Depth, Type II Deck Slab Repair

**BILL OF MATERIAL**

ITEM	UNIT	QUANTITY
Deck Slab Repair (Full Depth, Type II)	Sq. Yd.	10.6
Deck Slab Repair (Partial)	Sq. Yd.	193
Protective Shield	Sq. Yd.	1,428

**LAST DELAMINATION SURVEY**

July, 2011 (Provided by IDOT)

**DECK SLAB REPAIRS-I  
1ST AVE. (IL. 171) OVER  
SANITARY & SHIP CANAL AND RAMP  
COOK COUNTY  
STATION 30+72.59  
STRUCTURE NO. 016-0486 (S.B.)  
& STRUCTURE NO. 016-0487 (N.B.)**

FILE NAME =	USER NAME =	DESIGNED - EM	REVISED -	<b>STATE OF ILLINOIS DEPARTMENT OF TRANSPORTATION</b>	<b>DECK SLAB REPAIR PLAN I STRUCTURE NO. 016-0486 (S.B.) &amp; 016-0487 (N.B.)</b>	F.A.P. RTE.	SECTION	COUNTY	TOTAL SHEETS	SHEET NO.	
		CHECKED - JMH	REVISED -			373	2011-077-BR	COOK	32	21	
PLOT SCALE =		DRAWN - DR	REVISED -			CONTRACT NO. 60R03					
PLOT DATE =		CHECKED - JMH	REVISED -			ILLINOIS FED. AID PROJECT					