

Existing Structure: S.N. 016-1026. Bridge to be closed for repairs.
See Maintenance of Traffic Substage IIA for Detour Plan.

No Salvage.

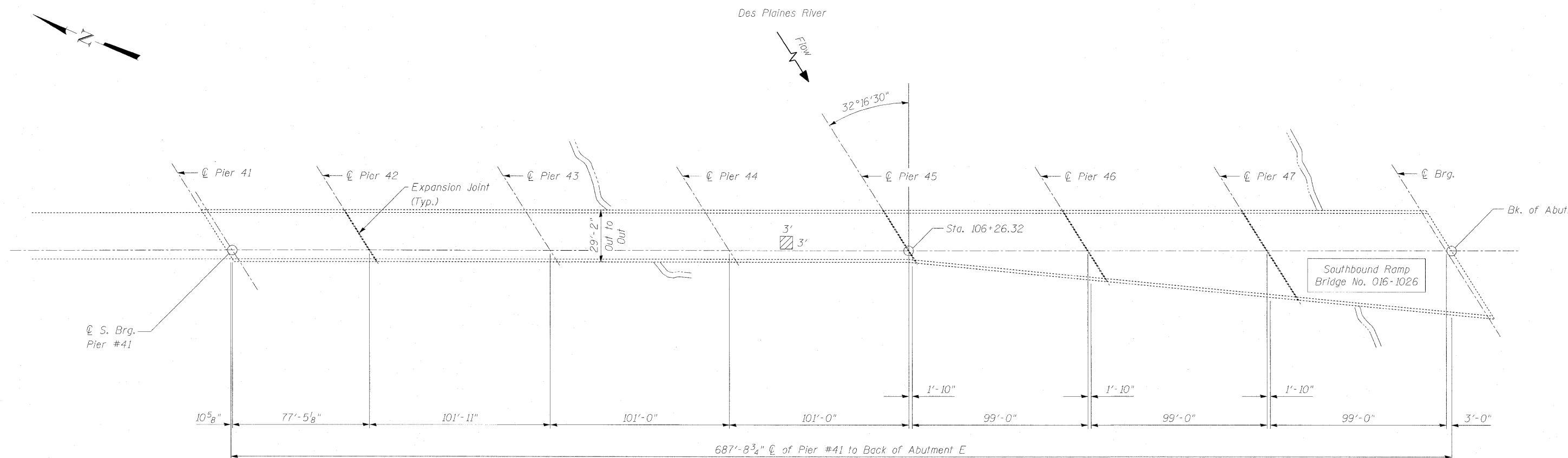

PLAN

LAST DELAMINATION SURVEY

July, 2011 (Provided by IDOT)

Notes:

- Repairs shall include but not be limited to the areas shown. The actual areas to be determined by the Engineer at the time of construction.
- The Engineer shall record the actual deck repair areas in order to document as-built conditions for the future reference.
- Care shall be exercised during concrete removal to protect the reinforcement bars and structural steel from damage.
- The Contractor shall make his own investigation to determine the existence, nature, and exact location of all utility lines and appurtenances within the limits of the work. Any damage to be repaired at the Contractor's expense.

Legend:

Indicates Partial Deck Slab Repair

BILL OF MATERIAL

ITEM	UNIT	QUANTITY
Deck Slab Repair (Partial)	Sq. Yd.	1.0

**DECK SLAB REPAIRS
1ST AVE. (IL. 171) S.B. RAMP TO I-55
OVER DES PLAINES RIVER
COOK COUNTY
STATION 106+26.32
STRUCTURE NO. 016-1026 (S.B.)**

FILE NAME =	USER NAME =	DESIGNED - EM	REVISED -	STATE OF ILLINOIS DEPARTMENT OF TRANSPORTATION	DECK SLAB REPAIR PLAN STRUCTURE NO. 016-1026 (S.B.)	F.A.P. RTE.	SECTION	COUNTY	TOTAL SHEETS	SHEET NO.	
		CHECKED - JMH	REVISED -			373	2011-077-BR	COOK	32	24	
PLOT SCALE =		DRAWN - DR	REVISED -			CONTRACT NO. 60R03					
PLOT DATE =		CHECKED - JMH	REVISED -			ILLINOIS FED. AID PROJECT					