

F.A.P. RTE.	SECTION	COUNTY	TOTAL SHEETS	SHEET NO.
307	129-R-2	KANE	243	64
STA.	TO STA.			
FED. ROAD DIST. NO. 1	ILLINOIS	FED. AID PROJECT		
CONTRACT NO. 62195				

**EXISTING UTILITIES LEGEND**

- EXISTING STORM SEWER
- PROPOSED STORM SEWER
- EXISTING SANITARY SEWER
- WATER MAIN
- ELECTRIC
- GAS MAIN
- OIL PIPELINE
- TELEPHONE
- CABLE TV
- GAS VALVE
- WATER VALVE
- VALVE VAULT
- BUFFALO BOX
- MONITORING WELL
- STRUCTURE TO BE ADJUSTED
- FILLING EXIST. STRUCTURE
- STRUCTURE TO BE CLEANED
- REMOVE EXISTING STRUCTURE
- FRAMES AND LIDS TO BE ADJUSTED (SPECIAL)
- STRUCTURE TO BE RECONSTRUCTED
- STORM SEWER (WATER MAIN REQUIREMENTS)
- FLOW DIRECTION
- SUMMIT

**CITY OF ST. CHARLES**

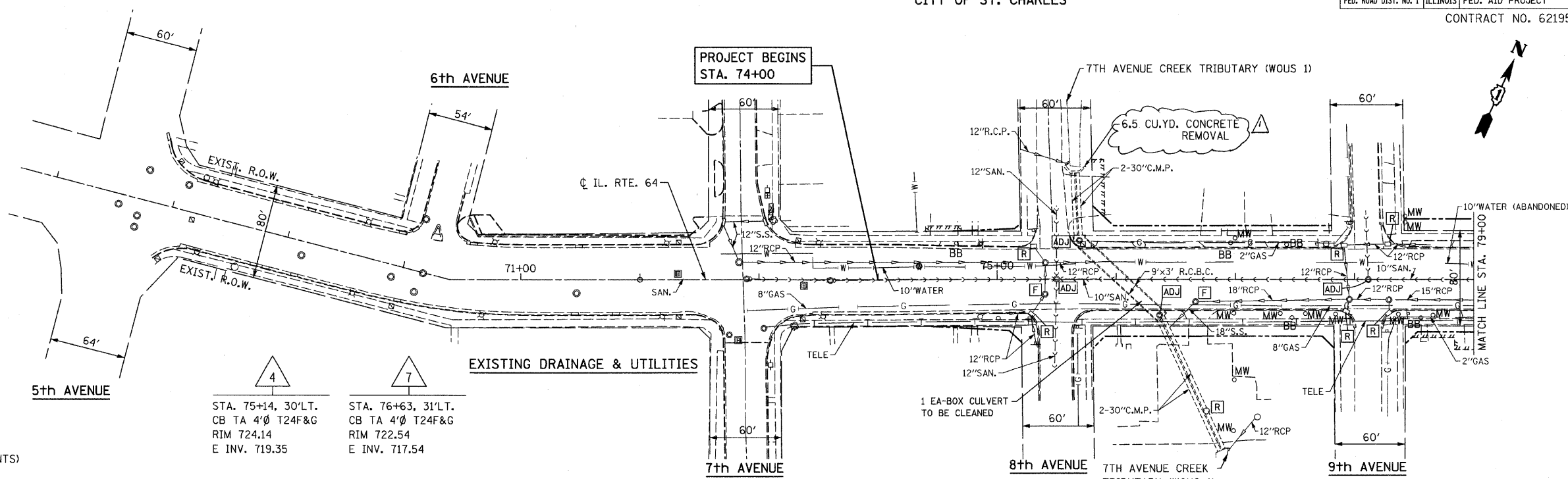

**EXISTING DRAINAGE & UTILITIES**

4	7	5	8	11	14	16	17	18	19	20	21	22	23
STA. 75+14, 30'LT. CB TA 4'Ø T24F&G RIM 724.14 E INV. 719.35	STA. 76+63, 31'LT. CB TA 4'Ø T24F&G RIM 722.54 E INV. 717.54	STA. 75+35, 57'RT. CB TA 4'Ø T1F OL RIM 722.85 NW INV. 719.55	STA. 76+80, 70.5'RT. INLET TY A T1F OL RIM 719.50 E INV. 717.00	STA. 77+62, 18'RT. MH TA 6'Ø T1F CL RIM 722.42 E & W INV. 717.25 S INV. 717.62	STA. 77+96, 33.5'LT. MH TA 4'Ø T1F CL RIM 722.07 S & W INV. 717.53 N INV. 718.00	STA. 77+98, 44'LT. CB TA 4'Ø T1F OL RIM 721.90 S INV. 717.10 E INV. 718.10	STA. 78+00, 61'RT. CB TA 4'Ø T1F OL RIM 720.10 N & E INV. 717.41	STA. 78+23, 61'RT. CB TY C T1F OL RIM 720.20 W INV. 717.51	STA. 78+26, 48'LT. CB TA 4'Ø T1F OL RIM 722.00 W INV. 718.30	STA. 78+55, 17'RT. MH TA 6'Ø T1F CL RIM 722.61 E & W INV. 717.36 N & S INV. 717.36	STA. 78+55, 31'RT. CB TA 4'Ø T24F&G RIM 722.33 N INV. 717.50	STA. 78+55, 37'LT. INLET TY A T8G RIM 722.60 S INV. 719.30	STA. 78+55, 31'RT. CB TA 4'Ø T24F&G RIM 722.31 N & S INV. 717.78

**DRAINAGE GENERAL NOTE:**

- ALL OFFSETS GIVEN FOR STRUCTURE LOCATION ARE AT E.O.P. UNLESS STRUCTURE IS NOT AT E.O.P. FOR WHICH THE OFFSET WILL BE TO THE CENTER OF STRUCTURE.
- SEE SCHEDULE FOR ANTICIPATED LOCATIONS OF ASBESTOS WATERMAIN REMOVAL.
- THE GENERAL CONTRACTOR IS REQUIRED TO HIRE AN ENVIRONMENTAL FIRM WITH AT LEAST FIVE (5) DOCUMENTED LEAKING UNDERGROUND STORAGE TANK (LUST) CLEANUPS OR THAT IS PRE-QUALIFIED IN HAZARDOUS WASTE BY THE DEPARTMENT TO REMEDIATE THE SOIL CONTAMINATION AND MONITOR FOR WORKER PROTECTION.

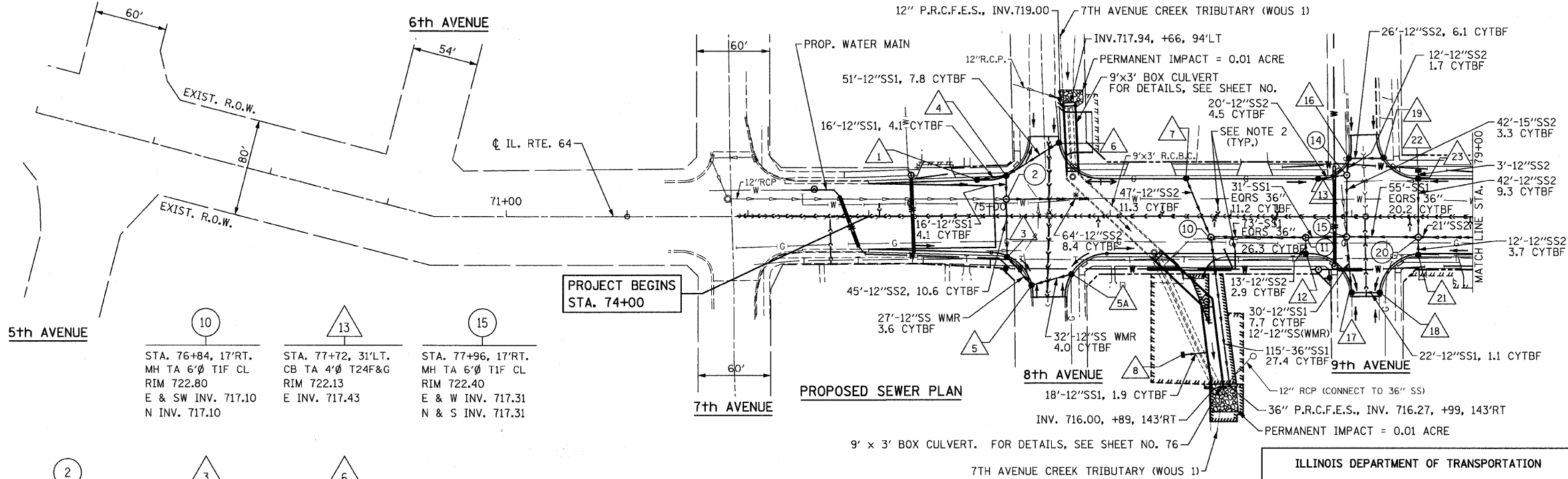

**PROPOSED SEWER PLAN**

5A	9	12	10	13	15
STA. 75+68, 48'RT. CB TY C T1F OL RIM 722.55 INV. 719.70	NOT USED	STA. 77+62, 31'RT. CB TA 4'Ø T24F&G RIM 722.16 N INV. 717.64	STA. 76+84, 17'RT. MH TA 6'Ø T1F CL RIM 722.80 E & SW INV. 717.10 N INV. 717.10	STA. 77+72, 31'LT. CB TA 4'Ø T24F&G RIM 722.13 E INV. 717.43	STA. 77+96, 17'RT. MH TA 6'Ø T1F CL RIM 722.40 E & W INV. 717.31 N & S INV. 717.31
1	2	3	6		
STA. 74+90, 29.6' LT. CB TA 4'Ø T1F OL RIM 723.79 NE & S INV. 719.05	STA. 75+14, 14'LT. MH TA 5'Ø T1F CL RIM 724.17 W INV. (718.90) E INV. 718.90 N & S INV. 718.90	STA. 75+15, 33'RT. CB TA 4'Ø T1F OL RIM 723.55 SE & N INV. 719.35	STA. 75+58, 61'LT. CB TY C T1F OL RIM 722.80 W INV. 719.60		

\* MATCH EXIST. INV. OF 12" SEWER AT 9'x3' BOX CULVERT

- NOTES:**
- FOR DRAINAGE PROFILE SEE SHEET NO. 70.
  - WATER AND SANITARY SERVICES, APPROX. LOCATIONS.

Rev. 1-11-12

**CHRISTIAN-ROGE & ASSOCIATES, INC.**  
ENGINEERS-PLANNERS-SURVEYORS  
211 WEST WACKER DRIVE  
CHICAGO, ILLINOIS 60606  
1-312-372-2023 FAX: 1-312-372-5274

REVISIONS	
NAME	DATE

**ILLINOIS DEPARTMENT OF TRANSPORTATION**

**EXISTING AND PROPOSED DRAINAGE AND UTILITIES**  
STA. 71+00 TO STA. 79+00  
ILLINOIS ROUTE 64

SCALE: 1" = 50'  
DATE: SEPTEMBER 22, 2011

DRAWN BY B.K.  
CHECKED BY S.J.P.

FILE NAME = r:\06\Auto\121.dgn  
PLOT DATE = 9/23/2011  
PLOT SCALE = 60.0000 Ft. / IN.