

F.A.P. RTE.	SECTION	COUNTY	TOTAL SHEETS	SHEET NO.
307	130 R-2	DUPAGE, KANE	647	126
STA.		TO STA.		
FED. ROAD DIST. NO.	ILLINOIS	FED. AID PROJECT		

62410

MATCH LINE STA 9852+50
 SEE SHEET NO. MOT-1A-01

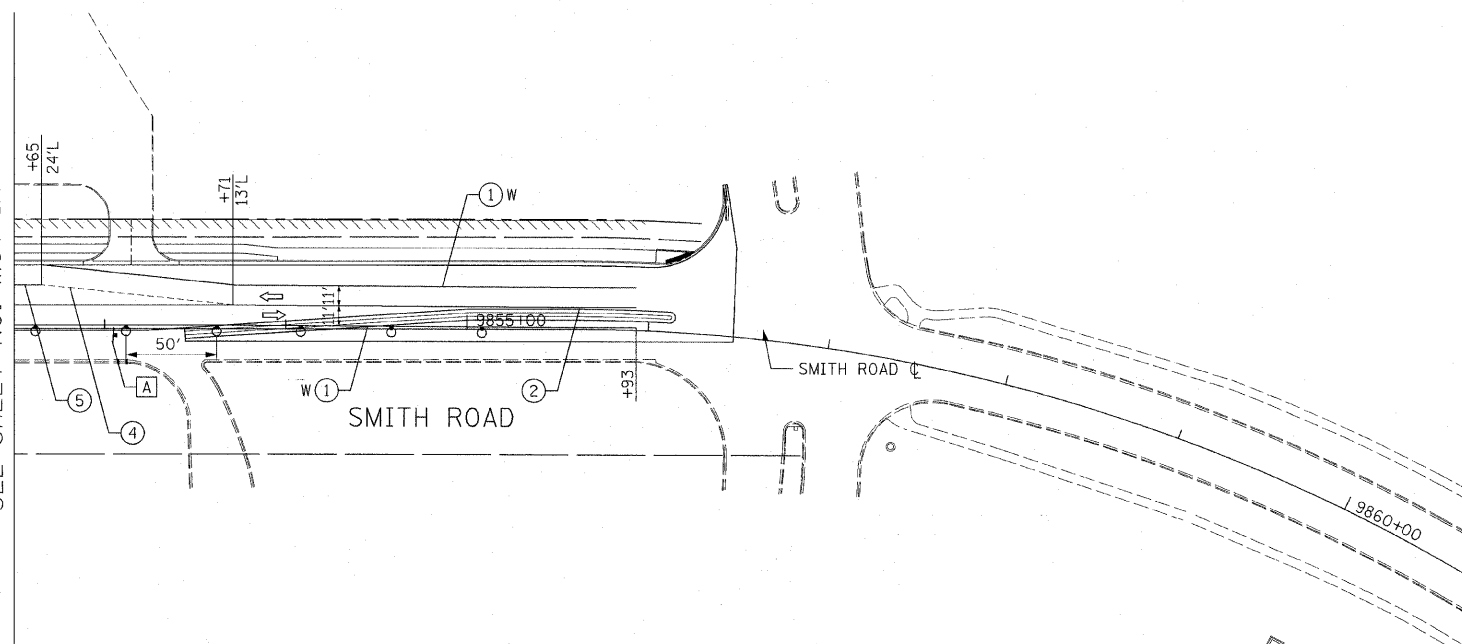

- LEGEND:**
- TEMPORARY PAVEMENT
 - DIRECTION OF TRAFFIC
 - TYPE I OR II BARRICADES
 - TEMPORARY CONCRETE BARRIER
 - IMPACT ATTENUATOR
 - TYPE III BARRICADES
 - 4" EDGE LINE
 - 4" DOUBLE CENTER LINE - YELLOW
 - 4" SKIP DASH LINE (30' SKIP/10' DASH) - WHITE
 - 4" SKIP DASH LINE (6' SKIP/2' DASH) - WHITE
 - 6" LANE LINE - WHITE
 - 24" STOP BAR - WHITE
 - LETTERS AND SYMBOLS

TEMPORARY INFORMATION SIGN LEGEND

- DRIVEWAY ENTRANCE - 1

NOTES:

1. ALL APPLICABLE STATE STANDARDS SHALL BE APPLIED AT ALL CROSS STREETS AND AT THE PROJECT LIMITS.

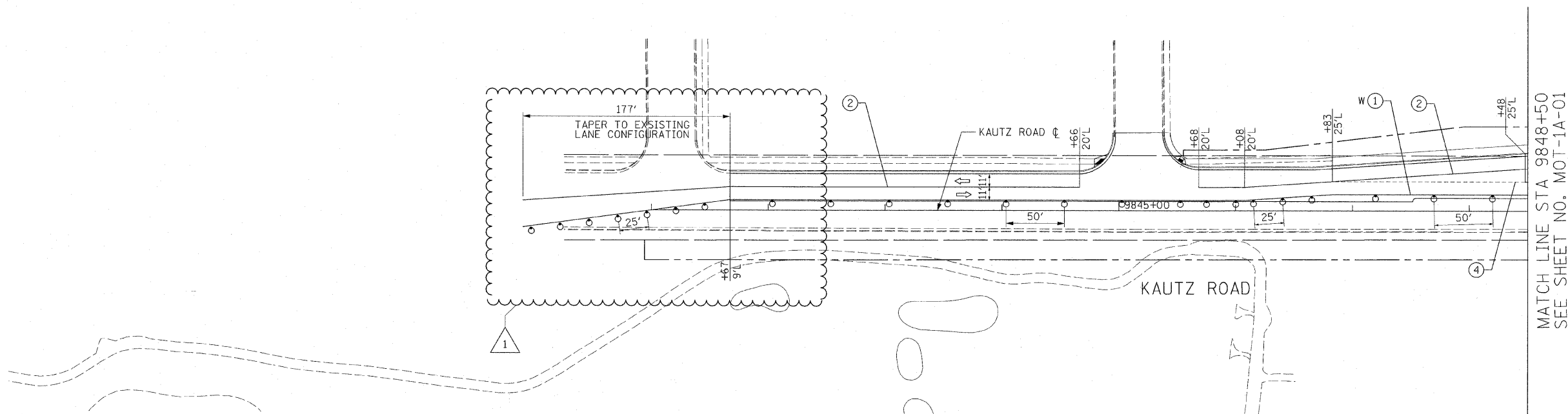

MATCH LINE STA 9848+50
 SEE SHEET NO. MOT-1A-01

MOT-1A-10

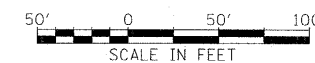

REVISIONS	
NAME	DATE
ADDENDUM NO. 1	12/23/11

ILLINOIS DEPARTMENT OF TRANSPORTATION
 F.A.P. ROUTE 307 (ILLINOIS ROUTE 64)

**SUGGESTED STAGES OF CONSTRUCTION AND TRAFFIC CONTROL
 STAGE 1A**

SCALE: VERT: NONE
 HORIZ: 1"=50'
 DATE: NOVEMBER 1, 2011

DRAWN BY: RMG
 CHECKED BY: JWM