

F.A.P. RTE.	SECTION	COUNTY	TOTAL SHEETS	SHEET NO.
307	130 R-2	DUPAGE, KANE	647	136
STA.	TO STA.			
FED. ROAD DIST. NO.	ILLINOIS	FED. AID PROJECT		

62410

MATCH LINE STA 9852+50  
 SEE SHEET NO. MOT-2-01

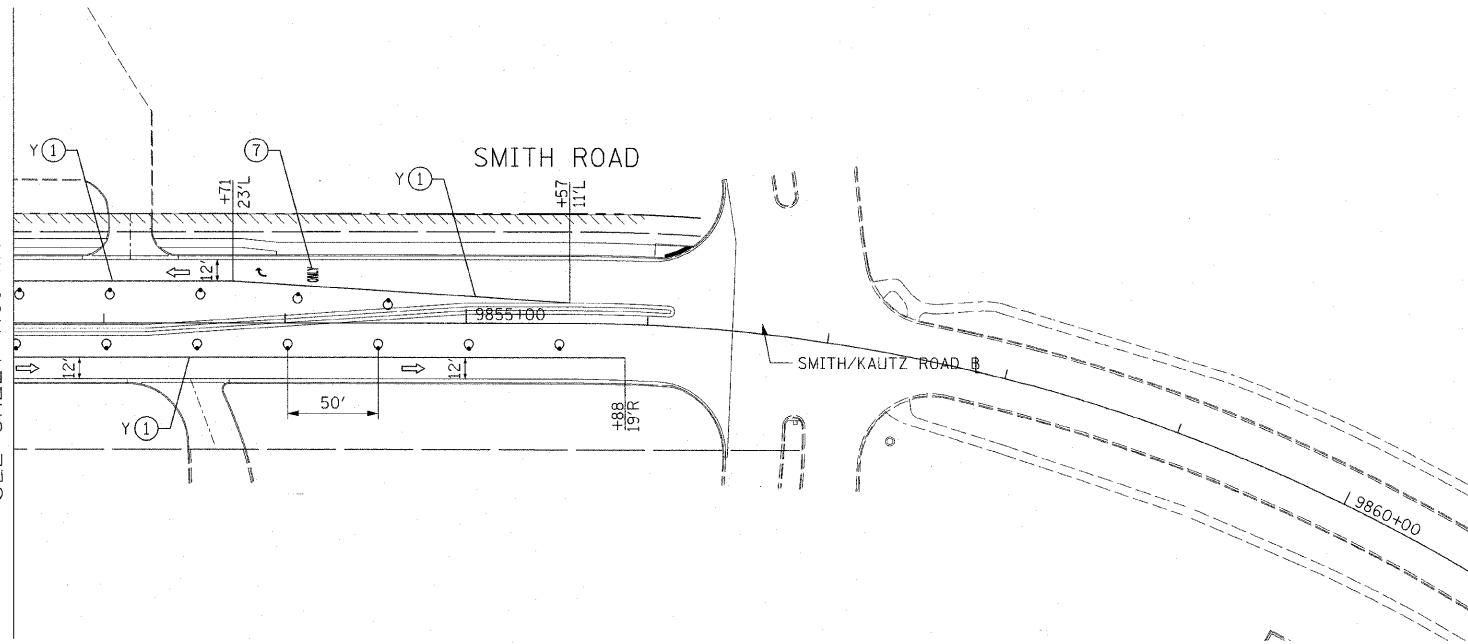

- LEGEND:**
- TEMPORARY PAVEMENT
  - DIRECTION OF TRAFFIC
  - TYPE I OR II BARRICADES
  - TEMPORARY CONCRETE BARRIER
  - IMPACT ATTENUATOR
  - TYPE III BARRICADES
  - 4" EDGE LINE
  - 4" DOUBLE CENTER LINE - YELLOW
  - 4" SKIP DASH LINE (30' SKIP/10' DASH) - WHITE
  - 4" SKIP DASH LINE (6' SKIP/2' DASH) - WHITE
  - 6" LANE LINE - WHITE
  - 24" STOP BAR - WHITE
  - LETTERS AND SYMBOLS

**NOTES:**

1. ALL APPLICABLE STATE STANDARDS SHALL BE APPLIED AT ALL CROSS STREETS AND AT THE PROJECT LIMITS.

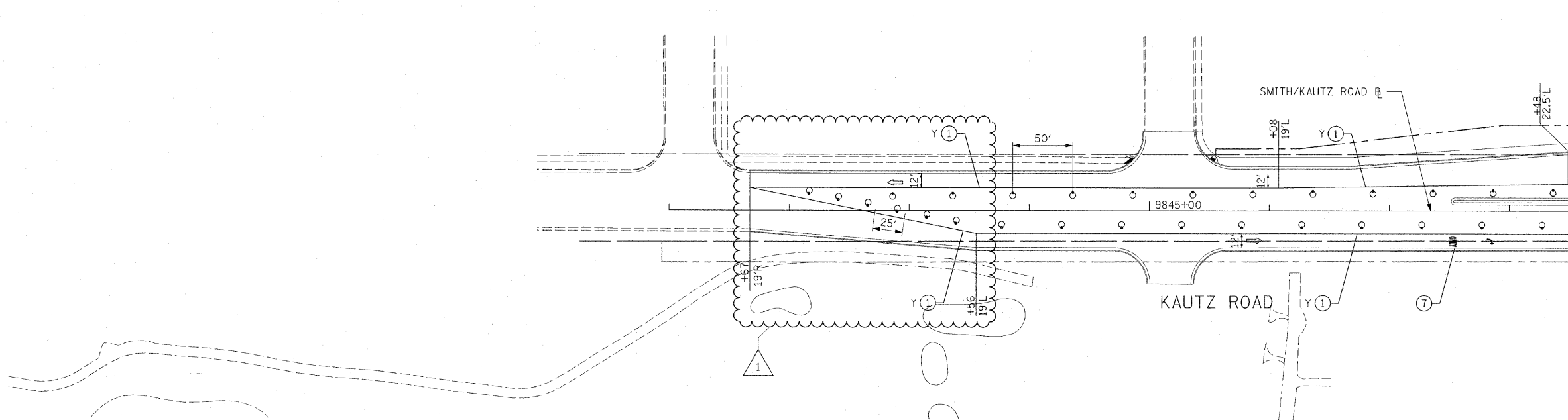

MATCH LINE STA 9848+50  
 SEE SHEET NO. MOT-2-01

MOT-2-10

REVISIONS	
NAME	DATE
ADDENDUM NO. 1	12/23/11

ILLINOIS DEPARTMENT OF TRANSPORTATION  
 F.A.P. ROUTE 307 (ILLINOIS ROUTE 64)

**SUGGESTED STAGES OF CONSTRUCTION AND TRAFFIC CONTROL**  
 STAGE 2

SCALE: VERT: NONE  
 HORIZ: 1"=50'  
 DATE: NOVEMBER 1, 2011

DRAWN BY: RMG  
 CHECKED BY: JWM

