

F.A.P. RTE.	SECTION	COUNTY	TOTAL SHEETS	SHEET NO.
307	130 R-2	DUPAGE, KANE	647	416
STA.		TO STA.		
FED. ROAD DIST. NO.		ILLINOIS FED. AID PROJECT		

62410

**NOTES:**

- SEE SHEET E-01 FOR ELECTRICAL SYMBOLS, CALL-OUT SAMPLES, ABBREVIATIONS AND GENERAL NOTES.
- SEE TRAFFIC SIGNAL PLANS FOR THE EXACT LOCATIONS OF COMBINATION TRAFFIC SIGNAL/LIGHT POLES.
- THE TYPICAL LIGHT POLE SETBACK, FROM 38TH AVENUE TO KAUTZ/SMITH ROAD, SHALL BE 3 FEET FROM BACK OF CURB TO THE FACE OF LIGHT POLE, UNO.
- REMOVE EXISTING TEMPORARY LIGHTING CONTROLLER CABINET "T1" AFTER INSTALLATION, OPERATION, TESTING, AND APPROVAL OF THE PROPOSED LIGHTING SYSTEM. CONTRACTOR SHALL DELIVER THE EXISTING LIGHTING CONTROLLERS TO BE REMOVED TO THE CITY OF ST. CHARLES.
- REMOVE EXISTING TEMPORARY LIGHTING UNITS AFTER INSTALLATION, OPERATION, TESTING, AND APPROVAL OF THE PROPOSED LIGHTING SYSTEM. SEE TEMPORARY LIGHTING PLAN TL-01.
- EXISTING LIGHTING UNIT OWNED AND OPERATED BY CITY OF ST. CHARLES.
- EXISTING PARKING LOT LIGHTING UNIT OWNED AND OPERATED BY CHARLESTOWNE MALL.
- PROVIDE 1.5" PVC CONDUIT SLEEVES IN THE POLE FOUNDATION FOR LIGHTING UNIT DUCTS. COORDINATE ALL WORK WITH TRAFFIC SIGNAL INSTALLATION.
- THE TYPICAL LIGHT POLE SETBACK, FROM KAUTZ/SMITH ROAD TO ILLINOIS ROUTE 59, SHALL BE 15 FEET FROM EDGE OF PAVEMENT TO THE FACE OF LIGHT POLE, UNO.
- OFFSET LIGHTING UNIT 3 FEET FROM BACK OF CURB TO THE FACE OF LIGHT POLE.
- LUMINAIRE SHALL BE 400W HPS.
- OFFSET LIGHTING UNIT 10 FEET FROM BACK OF CURB TO THE FACE OF LIGHT POLE.
- OFFSET LIGHTING UNIT 7'-6" FROM BACK OF CURB TO THE FACE OF LIGHT POLE.
- OFFSET LIGHTING UNIT 18'-6" FROM EDGE OF PAVEMENT TO THE FACE OF LIGHT POLE.

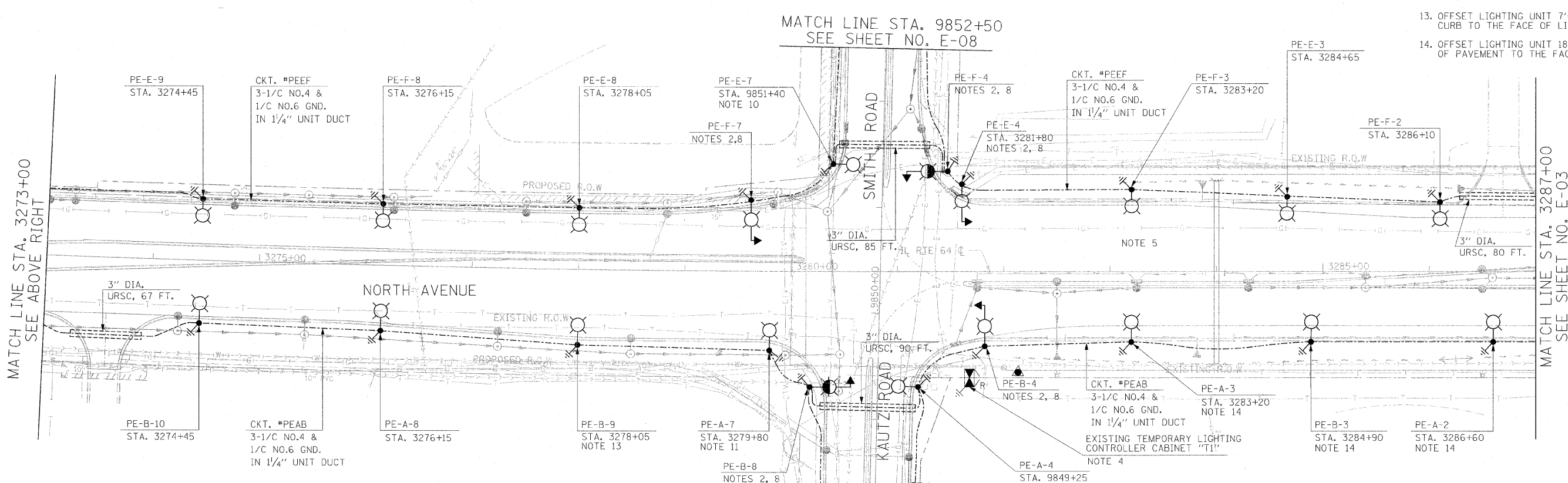
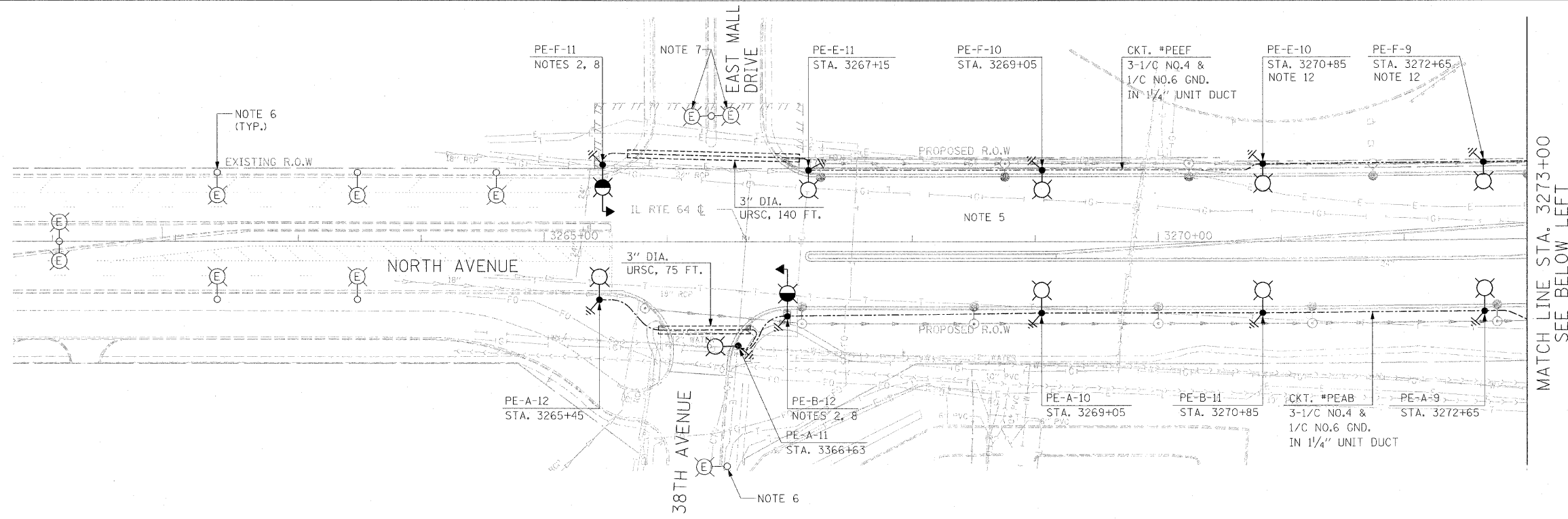

MATCH LINE STA. 3273+00  
SEE ABOVE RIGHT

MATCH LINE STA. 3287+00  
SEE SHEET NO. E-03

MATCH LINE STA. 9852+50  
SEE SHEET NO. E-08

MATCH LINE STA. 9848+30  
SEE SHEET NO. E-08

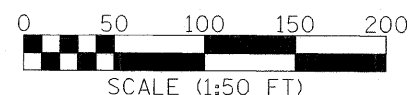

REVISIONS	
NAME	DATE
ADDENDUM NO. 1	12/23/11

ILLINOIS DEPARTMENT OF TRANSPORTATION  
 F.A.P. ROUTE 307 (ILLINOIS ROUTE 64)

ROADWAY LIGHTING PLAN  
 STA. 3260+00 TO STA. 3287+00

SCALE: 1" = 50'  
 DATE: NOVEMBER 1, 2011  
 DRAWN BY: HR  
 CHECKED BY: JPC



E-02