

F.A.P. RTE.	SECTION	COUNTY	TOTAL SHEETS	SHEET NO.
307	130 R-2	DUPAGE, KANE	647	418
STA.		TO STA.		
FED. ROAD DIST. NO.		ILLINOIS FED. AID PROJECT		
		62410		

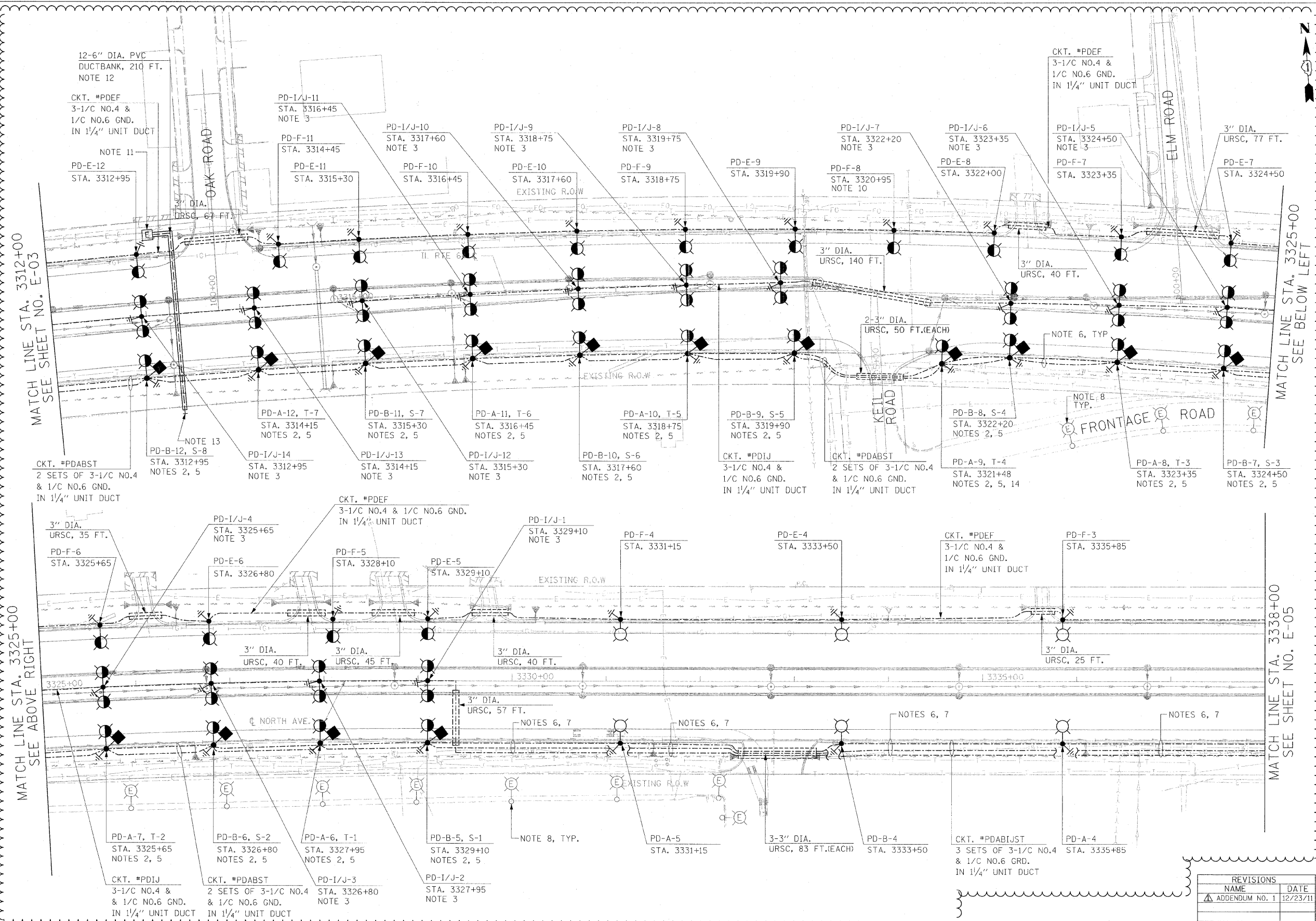

- NOTES:**
- SEE SHEET E-01 FOR ELECTRICAL SYMBOLS, CALL-OUT SAMPLES, ABBREVIATIONS AND GENERAL NOTES.
 - PROVIDE 2 - 3/2" PVC CONDUIT SLEEVES IN THE POLE FOUNDATION FOR LIGHTING UNIT DUCTS.
 - FOR LIGHT POLES LOCATED IN THE MEDIAN AREA, CONTRACTOR SHALL CENTER LIGHT POLES BETWEEN MEDIAN OR ADJUST LIGHT POLES TO MEET MINIMUM 2 FEET CLEARANCE FROM THE BACK OF CURB TO THE FACE OF LIGHT POLE.
 - THE TYPICAL LIGHT POLE SETBACK SHALL BE 15 FEET FROM EDGE OF PAVEMENT TO THE FACE OF LIGHT POLE, UNO.
 - PROVIDE AN AVIATION OBSTRUCTION WARNING LUMINAIRE. THE OBSTRUCTION LUMINAIRE SHALL BE OPERATED AT 240 VOLTS. SEE SHEET E-12 FOR AVIATION OBSTRUCTION WARNING LUMINAIRE MOUNTING DETAILS.
 - PROVIDE THREE 1/4" UNIT DUCTS.
 - THE UNIT DUCTS THAT FEED THE AVIATION OBSTRUCTION WARNING LUMINAIRES AND THE MEDIAN LIGHTING CIRCUITS SHALL SWEEP AROUND THE LIGHT POLE FOUNDATIONS.
 - EXISTING LIGHTING UNIT OWNED AND OPERATED BY DUPAGE COUNTY AIRPORT.
 - OFFSET LIGHTING UNIT 19'-6" FROM THE EDGE OF PAVEMENT TO THE FACE OF LIGHT POLE.
 - OFFSET LIGHTING UNIT 18'-6" FROM THE EDGE OF PAVEMENT TO THE FACE OF LIGHTING UNIT.
 - ROUTE PROPOSED CONCRETE ENCASED DUCTBANK INTO EXISTING ELECTRIC UTILITY MANHOLE.
 - PROVIDE TWELVE 6" DIA. SCHEDULE 40 PVC CONDUITS ENCASED IN REINFORCED CONCRETE DUCTBANK. INSTALL DUCTBANK AT APPROXIMATELY STA. 3313+30. COORDINATE FINAL DUCTBANK INSTALLATION LOCATION AND DEPTH WITH DRAINAGE AND CIVIL WORK. SEE SHEET E-16 FOR DUCTBANK DETAILS.
 - ROUTE DUCTBANK TO THE R.O.W. AND CAP ENDS FOR FUTURE USE. MARK END OF DUCTBANK WITH A SECTION OF 6" DIA. PVC CONDUIT INSTALLED VERTICALLY IN THE GROUND. SEE SHEET E-16 FOR DETAILS.
 - VERIFY EXISTING WATER MAIN HAS BEEN RELOCATED BY OTHERS PRIOR TO INSTALLATION OF LIGHT POLE FOUNDATION.

MATCH LINE STA. 3325+00
SEE ABOVE RIGHT

MATCH LINE STA. 3325+00
SEE BELOW LEFT

MATCH LINE STA. 3338+00
SEE SHEET NO. E-05

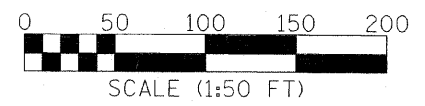

REVISIONS	
NAME	DATE
ADDENDUM NO. 1	12/23/11

ILLINOIS DEPARTMENT OF TRANSPORTATION
 F.A.P. ROUTE 307 (ILLINOIS ROUTE 64)

ROADWAY LIGHTING PLAN
 STA. 3312+00 TO STA. 3338+00

SCALE: 1" = 50'
 DATE: NOVEMBER 1, 2011

DRAWN BY: HR
 CHECKED BY: JPC