

F.A.P. RTE.	SECTION	COUNTY	TOTAL SHEETS	SHEET NO.
307	130 R-2	DUPAGE, KANE	647	60
STA.	3312+00	TO STA.	3325+00	
FED. ROAD DIST. NO.		ILLINOIS FED. AID PROJECT		

62410

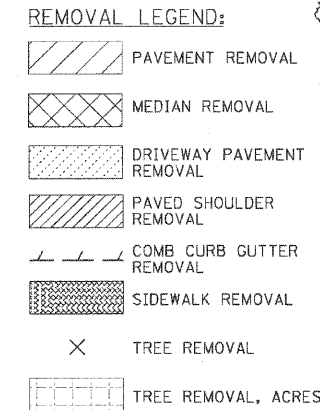

EXISTING CONDITIONS AND REMOVALS

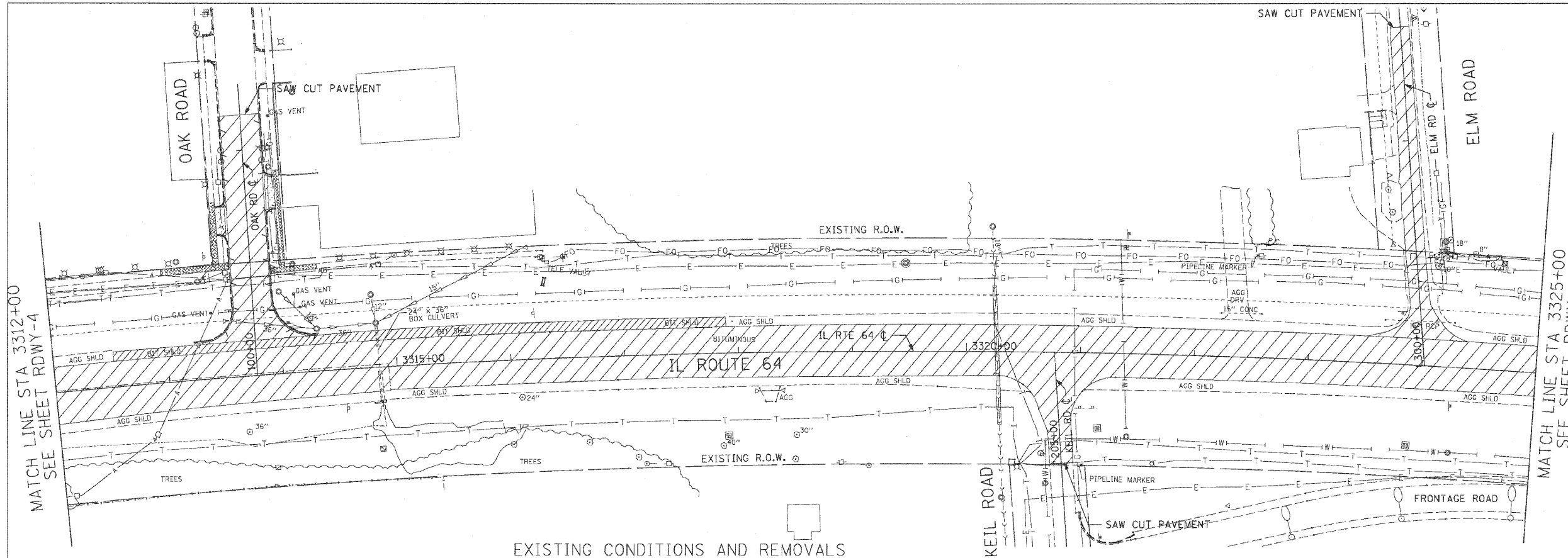
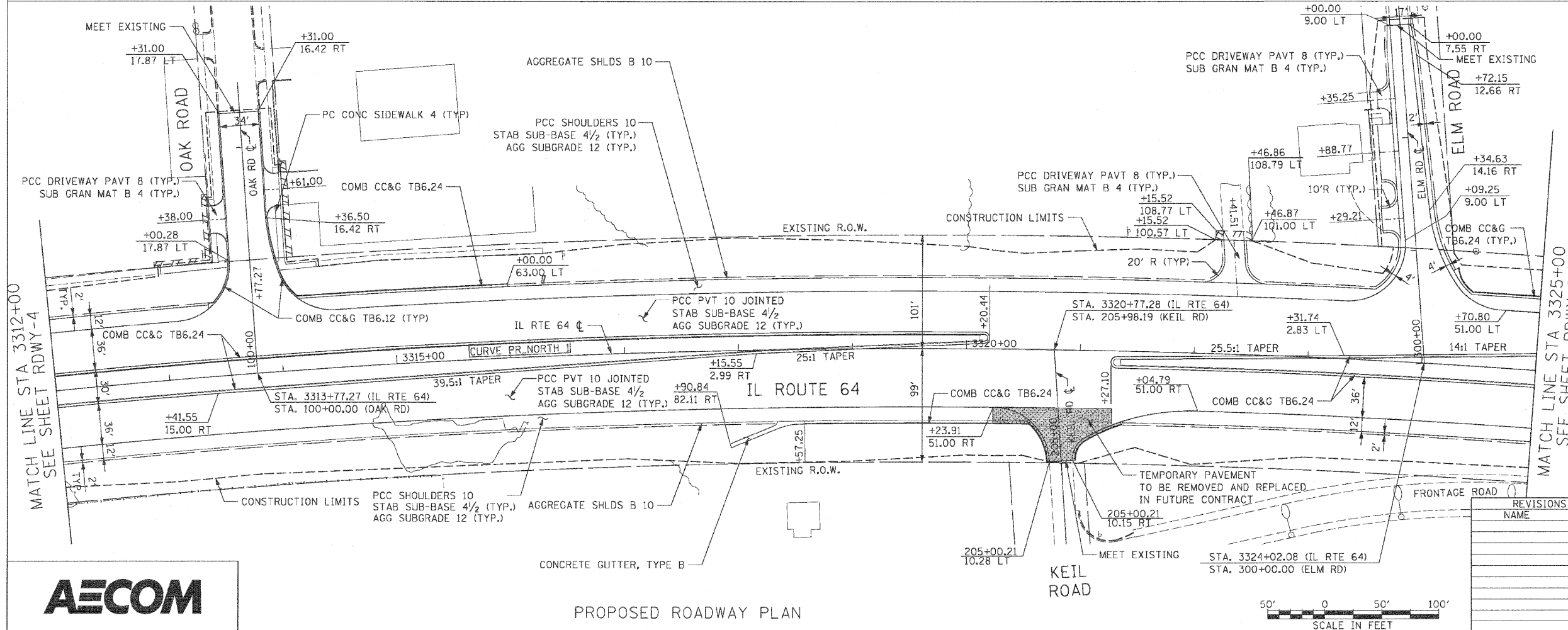

- NOTES:**
- SEE INTERSECTION DETAIL SHEETS FOR GEOMETRIC INFORMATION AT OAK ROAD, KEIL ROAD AND ELM ROAD WITH IL ROUTE 64.
 - FOR SHOULDER AND CURB AND GUTTER RADIUS RETURN TRANSITIONS - SEE SHEET RDWY-1, DETAIL "A".



PROPOSED ROADWAY PLAN



REVISIONS	
NAME	DATE

ILLINOIS DEPARTMENT OF TRANSPORTATION
 F.A.P. ROUTE 307 (ILLINOIS ROUTE 64)

ROADWAY PLAN
 ILLINOIS ROUTE 64
 STA. 3312+00 TO STA. 3325+00

SCALE: 1" = 50'
 DATE: NOVEMBER 1, 2011

DRAWN BY: AFC
 CHECKED BY: NJH

