

F.A.P. RTE.	SECTION	COUNTY	TOTAL SHEETS	SHEET NO.
307	130 R-2	DUPAGE, KANE	647	61
STA.	3325+00	TO STA.	3338+00	
FED. ROAD DIST. NO.	ILLINOIS	FED. AID PROJECT		

62410

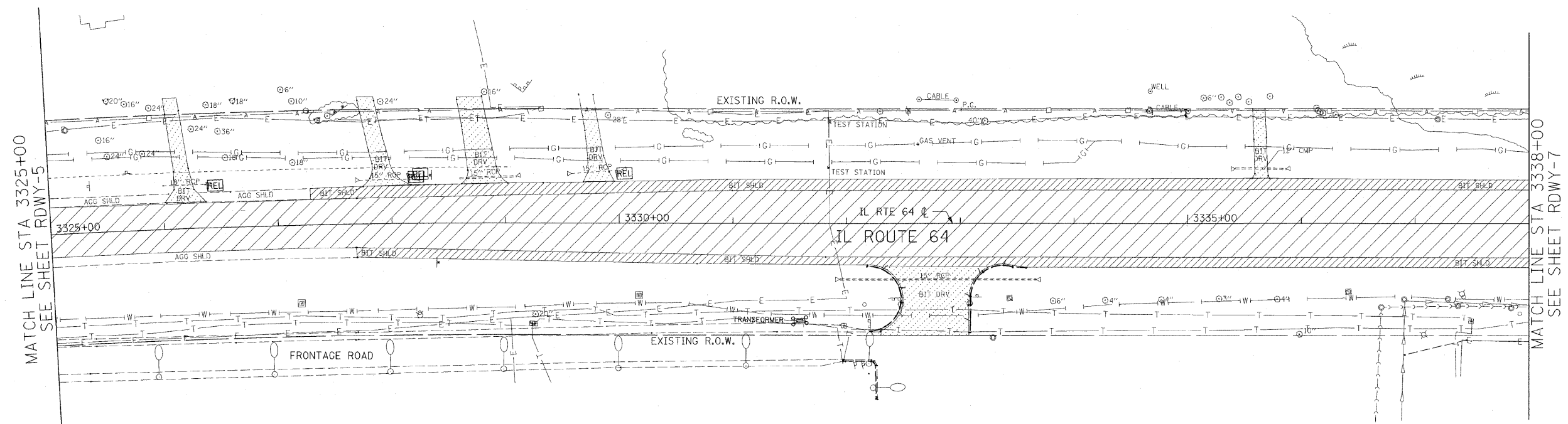

- REMOVAL LEGEND:**
- PAVEMENT REMOVAL
 - MEDIAN REMOVAL
 - DRIVEWAY PAVEMENT REMOVAL
 - PAVED SHOULDER REMOVAL
 - COMB CURB GUTTER REMOVAL
 - SIDEWALK REMOVAL
 - TREE REMOVAL
 - TREE REMOVAL, ACRES

EXISTING CONDITIONS AND REMOVALS

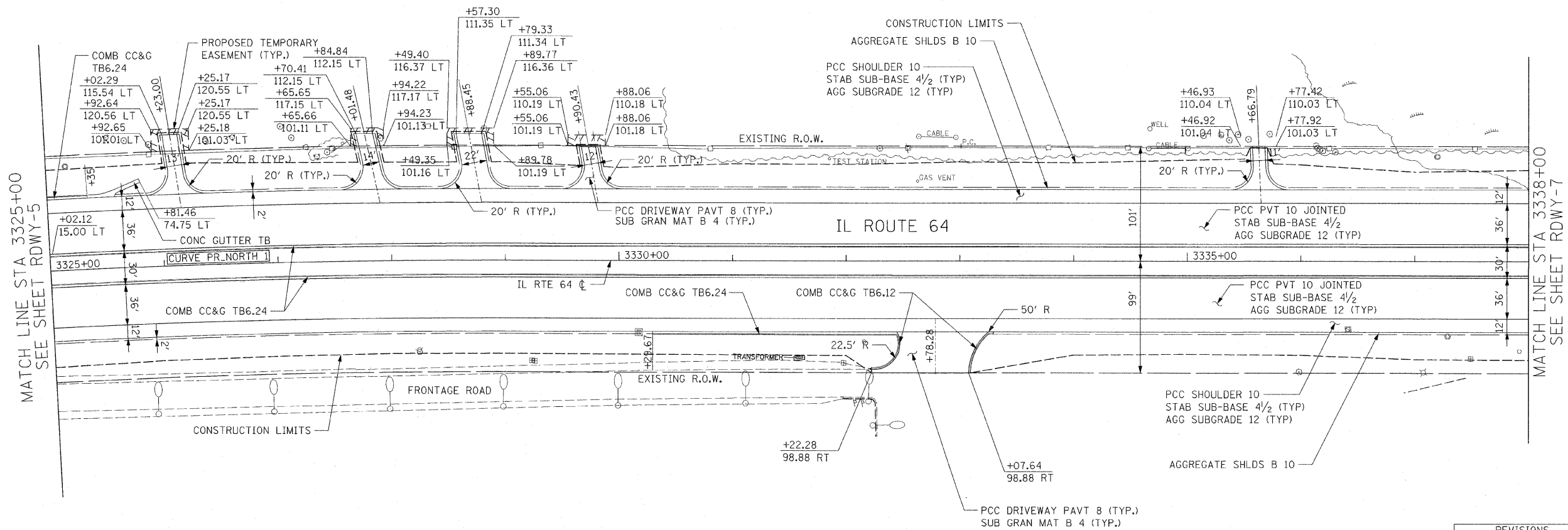

NOTE:
 1. FOR SHOULDER AND CURB AND GUTTER RADIUS RETURN TRANSITIONS - SEE SHEET RDWY-1, DETAIL "A".

RDWY-6



PROPOSED ROADWAY PLAN

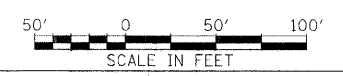

REVISIONS	
NAME	DATE

ILLINOIS DEPARTMENT OF TRANSPORTATION
 F.A.P. ROUTE 307 (ILLINOIS ROUTE 64)

ROADWAY PLAN
 ILLINOIS ROUTE 64
 STA. 3325+00 TO STA. 3338+00

SCALE: 1" = 50'
 DATE: DECEMBER 2, 2011

DRAWN BY: AFC
 CHECKED BY: NJH