

F.A.P. RTE.	SECTION	COUNTY	TOTAL SHEETS	SHEET NO.
307	130 R-2	DUPAGE, KANE	647	72
STA. 9852+50 TO STA. 9856+42.88				
FED. ROAD DIST. NO.			ILLINOIS FED. AID PROJECT	

62410

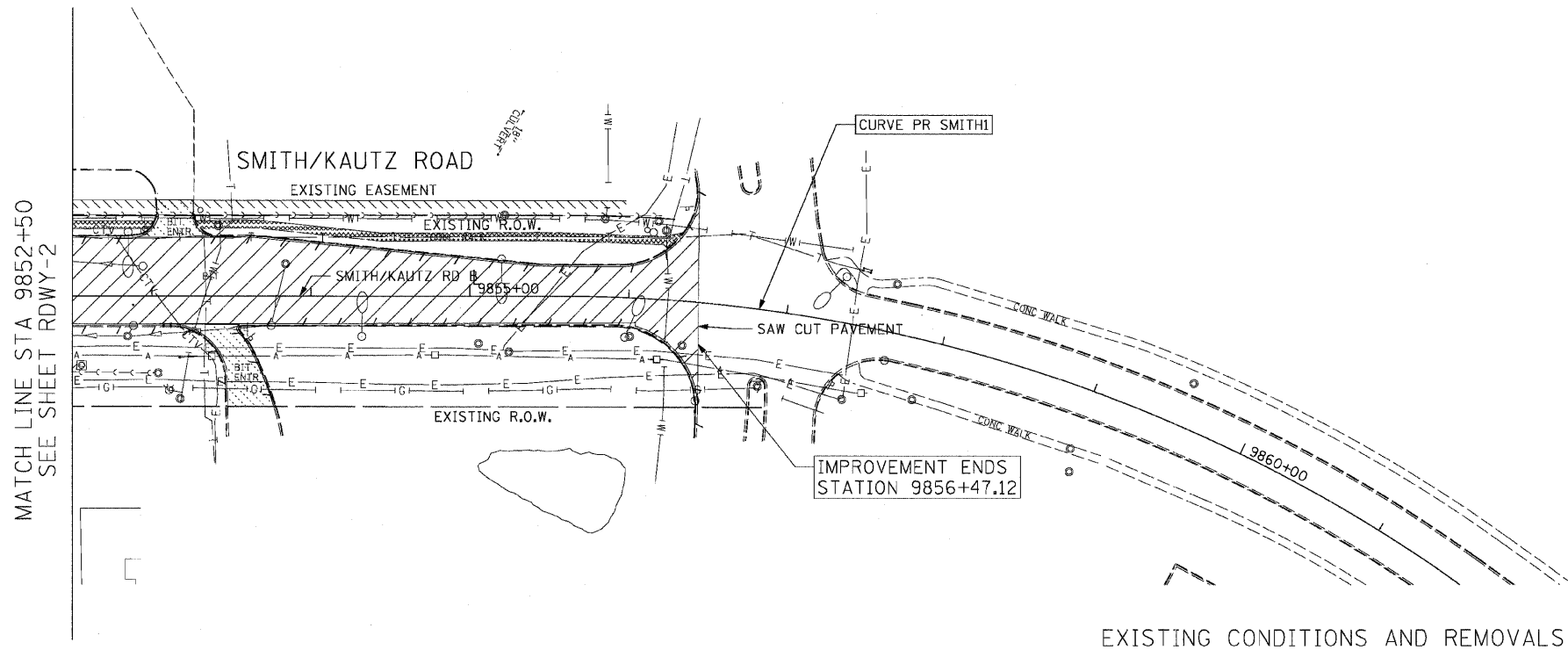

- REMOVAL LEGEND:**
- PAVEMENT REMOVAL
  - MEDIAN REMOVAL
  - DRIVEWAY PAVEMENT REMOVAL
  - PAVED SHOULDER REMOVAL
  - COMB CURB GUTTER REMOVAL
  - SIDEWALK REMOVAL
  - TREE REMOVAL
  - TREE REMOVAL, ACRES

EXISTING CONDITIONS AND REMOVALS

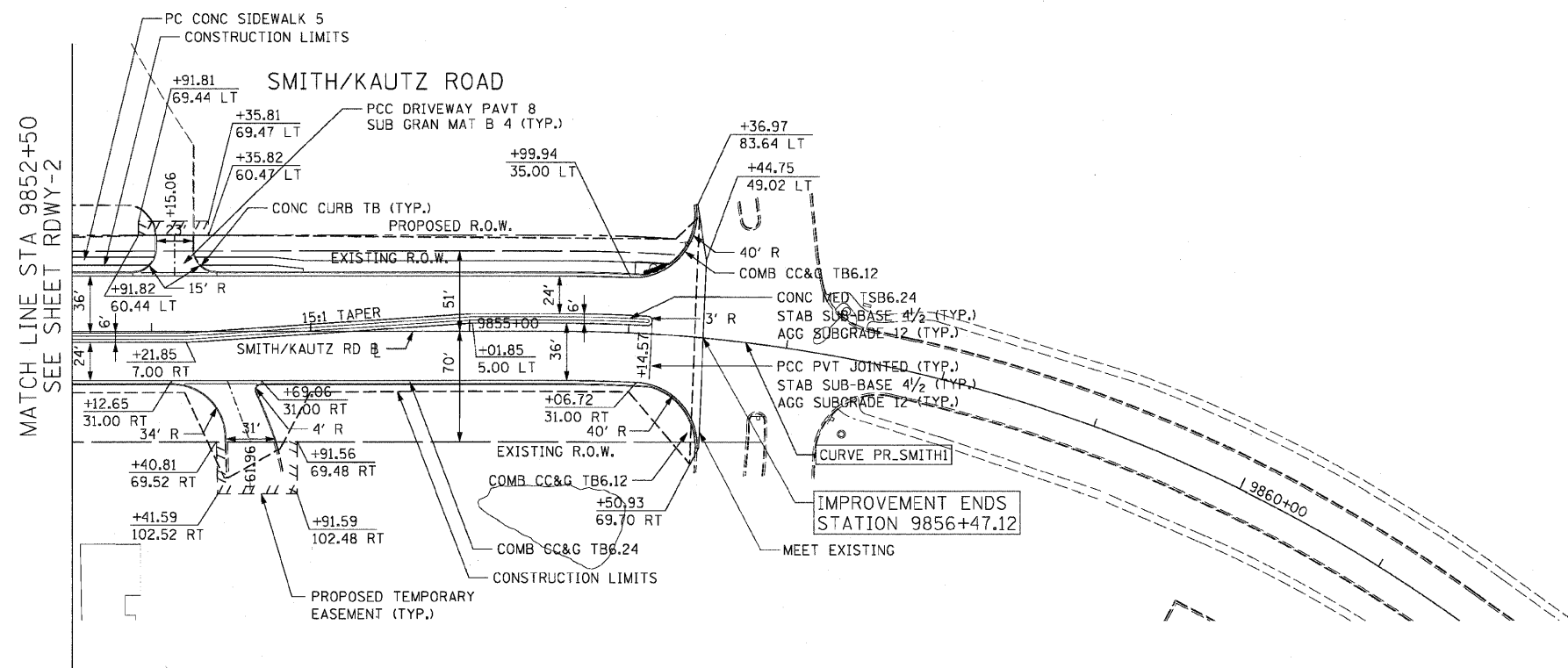

RDWY-17

REVISIONS	
NAME	DATE

ILLINOIS DEPARTMENT OF TRANSPORTATION  
 F.A.P. ROUTE 307 (ILLINOIS ROUTE 64)

**ROADWAY PLAN**  
 SMITH ROAD  
 STA. 9852+50 TO STA. 9856+42.88

SCALE: 1" = 50'  
 DATE: NOVEMBER 1, 2011

DRAWN BY: JWM  
 CHECKED BY: RMG



PROPOSED ROADWAY PLAN

