

F.A.P. RTE.	SECTION	COUNTY	TOTAL SHEETS	SHEET NO.
307	130 R-2	DUPAGE, KANE	647	127
STA.		TO STA.		
FED. ROAD DIST. NO.		ILLINOIS FED. AID PROJECT		

62410

LEGEND:

- TEMPORARY PAVEMENT
- DIRECTION OF TRAFFIC
- TYPE I OR II BARRICADES
- TEMPORARY CONCRETE BARRIER
- IMPACT ATTENUATOR
- TYPE III BARRICADES
- 4" EDGE LINE
- 4" DOUBLE CENTER LINE - YELLOW
- 4" SKIP DASH LINE (30' SKIP/10' DASH) - WHITE
- 4" SKIP DASH LINE (6' SKIP/2' DASH) - WHITE
- 6" LANE LINE - WHITE
- 24" STOP BAR - WHITE
- LETTERS AND SYMBOLS

TEMPORARY INFORMATION SIGN LEGEND

- ONE WAY - 3
- U-TURN PERMITTED - 1
- DETOUR - 8
- KAUTZ ROAD - 5
- SMITH ROAD - 4
- "AHEAD ARROW" - 5
- NORTH - 3
- SOUTH - 5
- "RIGHT TURN AHEAD ARROW" - 2
- END DETOUR - 2
- LANE WEAVE - 1
- RIGHT TURN ARROW - 1

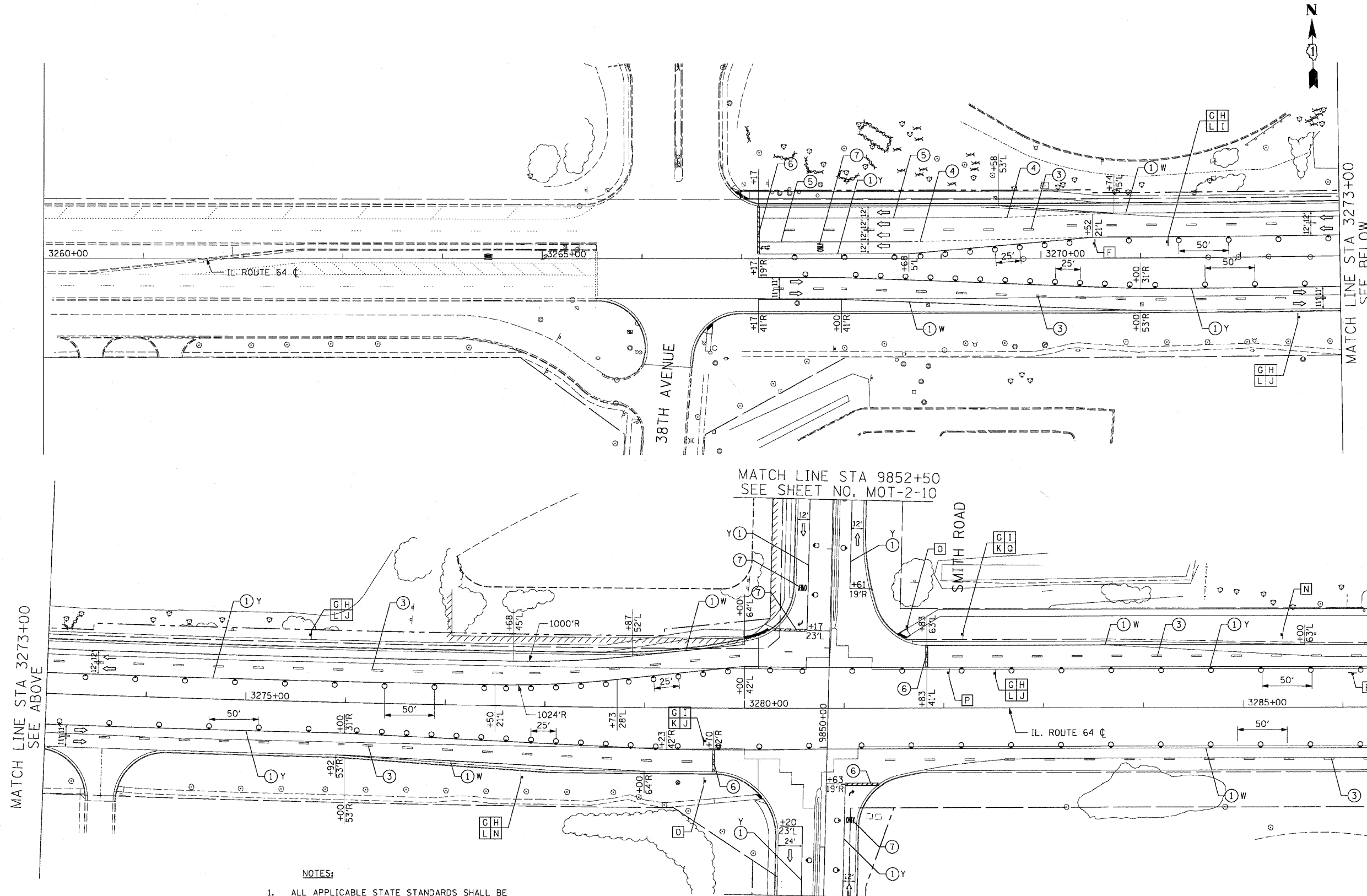

MATCH LINE STA 3273+00
SEE ABOVE

MATCH LINE STA 3273+00
SEE BELOW

MATCH LINE STA 9852+50
SEE SHEET NO. MOT-2-10

MATCH LINE STA 3287+00
SEE SHEET NO. MOT-1-02

MATCH LINE STA 9848+50
SEE SHEET NO. MOT-2-10
KAUTZ ROAD

- NOTES:**
- ALL APPLICABLE STATE STANDARDS SHALL BE APPLIED AT ALL CROSS STREETS AND AT THE PROJECT LIMITS.
 - KAUTZ/SMITH ROAD INTERSECTION SHALL REMAIN OPEN TO TRAFFIC DURING STAGE 2. SUB-STAGES OF CONSTRUCTION WILL BE REQUIRED TO KEEP THE INTERSECTION OPEN TO TRAFFIC.

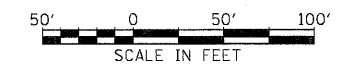

REVISIONS	
NAME	DATE

ILLINOIS DEPARTMENT OF TRANSPORTATION
 F.A.P. ROUTE 307 (ILLINOIS ROUTE 64)

SUGGESTED STAGES OF CONSTRUCTION AND TRAFFIC CONTROL STAGE 2

SCALE: VERT: NONE
 HORIZ: 1/4"=50'
 DATE: MAY 13, 2011

DRAWN BY: RMG
 CHECKED BY: JWM

MOT-2-01