

F.A.P. RTE.	SECTION	COUNTY	TOTAL SHEETS	SHEET NO.
307	130 R-2	DUPAGE, KANE	647	137
STA.		TO STA.		
FED. ROAD DIST. NO.		ILLINOIS FED. AID PROJECT		

62410



- LEGEND:**
- TEMPORARY PAVEMENT
  - DIRECTION OF TRAFFIC
  - TYPE I OR II BARRICADES
  - TEMPORARY CONCRETE BARRIER
  - IMPACT ATTENUATOR
  - TYPE III BARRICADES
  - 4" EDGE LINE
  - 4" DOUBLE CENTER LINE - YELLOW
  - 4" SKIP DASH LINE (30' SKIP/10' DASH) - WHITE
  - 4" SKIP DASH LINE (6' SKIP/2' DASH) - WHITE
  - 6" LANE LINE - WHITE
  - 24" STOP BAR - WHITE
  - LETTERS AND SYMBOLS

**TEMPORARY INFORMATION SIGN LEGEND**

- ONE WAY - 1

**NOTES:**

1. FINAL PAVEMENT MARKINGS SHALL BE INSTALLED ALONG SMITH AND KAUTZ ROAD. SEE PAVEMENT MARKING PLANS FOR DETAILS.
2. ALL APPLICABLE STATE STANDARDS SHALL BE APPLIED AT ALL CROSS STREETS AND AT THE PROJECT LIMITS.

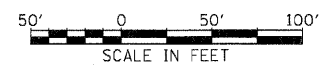
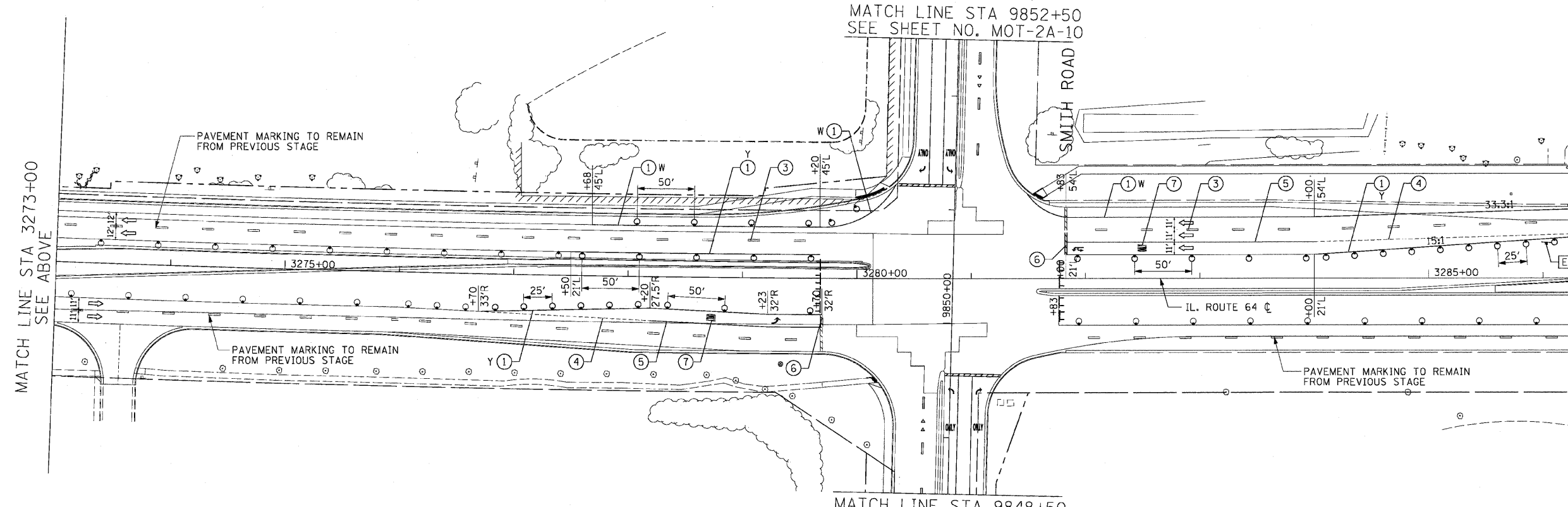
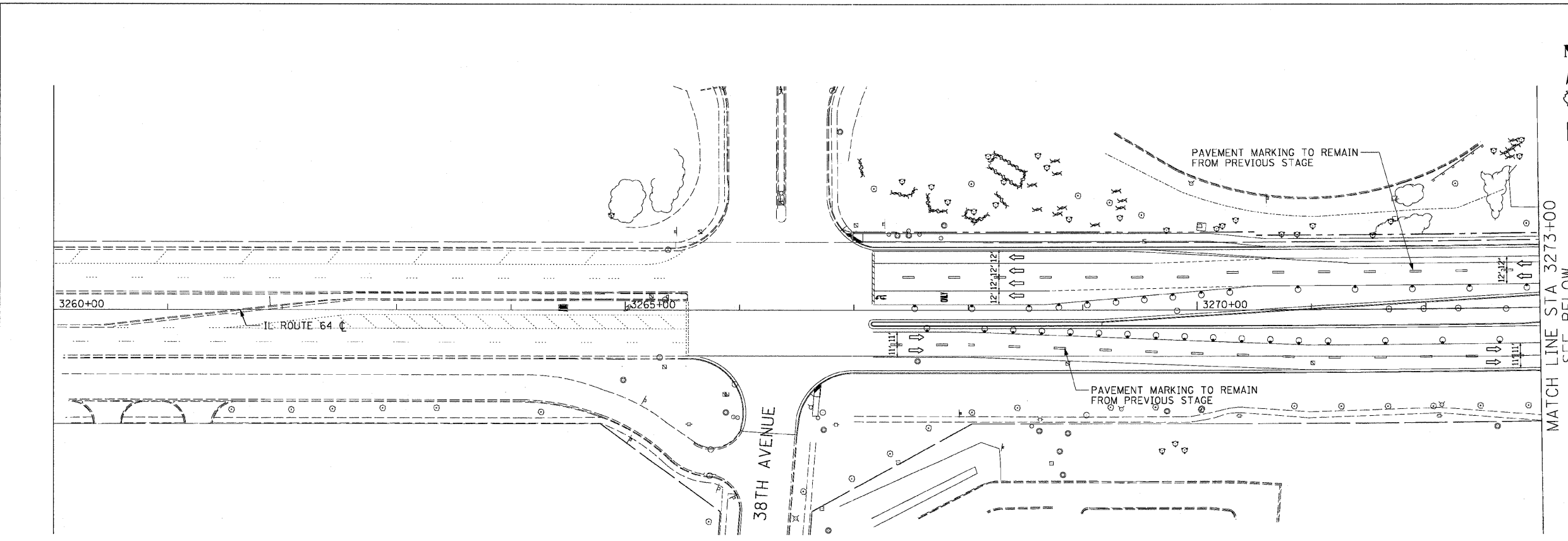

REVISIONS	
NAME	DATE

ILLINOIS DEPARTMENT OF TRANSPORTATION  
 F.A.P. ROUTE 307 (ILLINOIS ROUTE 64)

**SUGGESTED STAGES OF CONSTRUCTION AND TRAFFIC CONTROL STAGE 2A**

SCALE: VERT: NONE  
 HORIZ: 1"=50'  
 DATE: MAY 13, 2011

DRAWN BY: RMG  
 CHECKED BY: JWM

MOT-2A-01