

F.A.P. RTE.	SECTION	COUNTY	TOTAL SHEETS	SHEET NO.
307	130 R-2	DUPAGE, KANE	647	159
STA. 3377+00		TO STA. 3390+00		
FED. ROAD DIST. NO.		ILLINOIS FED. AID PROJECT		

62410

**INLET AND PIPE PROTECTION**

STATION	DESCRIPTION	INLET AND PIPE PROTECTION EACH
3377+12, 89' RT	FES	1
3377+25, 8' RT	IN	1
3377+25, 15' RT	CB	1
3377+37, 89' RT	FES	1
3377+55, 88' LT	FES	1
3377+55, 88' RT	FES	1
3378+00, 87' RT	FES	1
3378+00, 9' RT	CB	1
3379+23, 15' RT	CB	1
3379+23, 2' RT	CB	1
3379+49, 1' RT	CB	1
3379+49, 15' RT	CB	1
3381+00, 15' RT	CB	1
3381+00, 8' LT	CB	1
3381+06, 89' RT	FES	1
3381+78, 88' RT	FES	1
3382+75, 15' LT	CB	1
3382+75, 15' RT	CB	1
3384+75, 15' LT	CB	1
3384+75, 15' RT	CB	1
3385+95, 87' RT	FES	1
3386+67, 87' RT	FES	1
3387+00, 15' RT	CB	1
3387+25, 9' RT	CB	1
3387+75, 83' LT	FES	1
3388+25, 83' LT	FES	1
3388+75, 8' RT	CB	1
3388+75, 15' RT	CB	1

**PERIMETER BARRIER LOCATIONS**

POINT	STATION	OFFSET
1	3381+30.8	100.1' RT
2	3381+59.9	100.1' RT
3	3386+10.2	100.2' RT
4	3386+16.0	130.1' RT
5	3386+27.4	127.8' RT
6	3386+53.8	122.7' RT
7	3386+73.4	118.8' RT
8	3386+69.8	100.2' RT

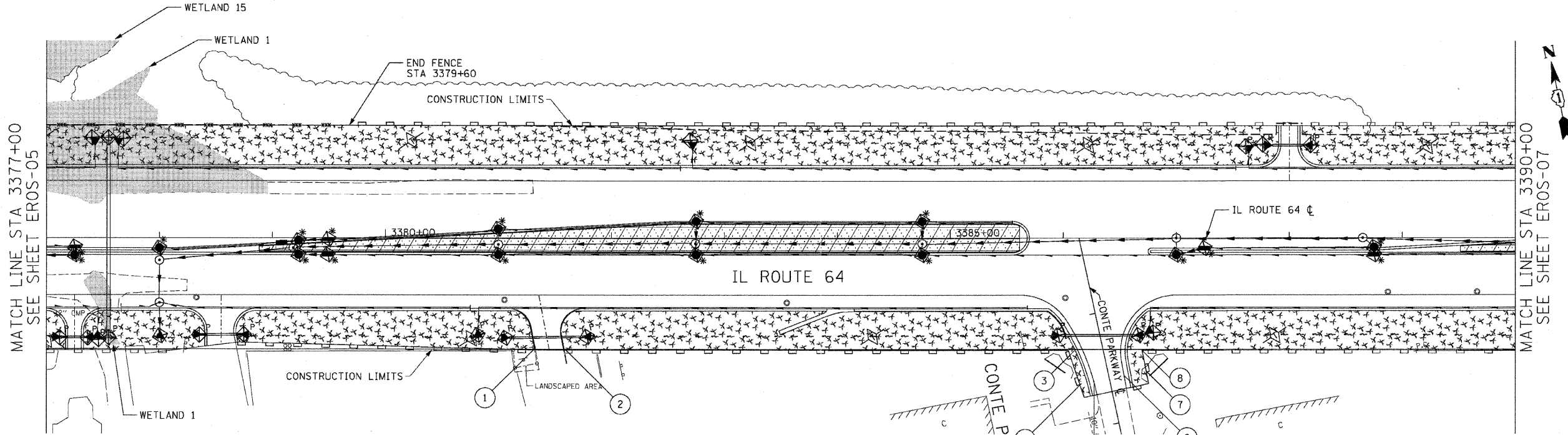

EROSION CONTROL LEGEND	STAGE 1	STAGE 2
INLET FILTER		
PIPE PROTECTION		
TEMPORARY DITCH CHECKS		
PERIMETER EROSION BARRIER		
WETLAND PROTECTION FENCE (SPECIAL)		
AGGREGATE (EROSION CONTROL)		
TEMPORARY EROSION CONTROL SEEDING / MULCH METHOD 2		

**TEMPORARY EROSION CONTROL SEEDING**

STATION	POUND
3377+00 TO 3390+00, LT	613
3377+00 TO 3390+00, RT	736
<b>SUBTOTAL</b>	<b>1,349</b>

**PERIMETER EROSION BARRIER**

STATION	FOOT
3377+00 TO 3390+00, LT	1,040
3377+00 TO 3390+00, RT	1,248
<b>SUBTOTAL</b>	<b>2,288</b>

**TEMPORARY DITCH CHECKS**

STATION	FOOT
3380+24, 87' LT	10
3383+24, 85' LT	10
3386+23, 83' LT	10
3389+23, 82' LT	10
3380+77, 89' RT	10
3384+32, 87' RT	10
3387+88, 86' RT	10
<b>SUBTOTAL</b>	<b>70</b>

**WETLAND PROTECTION FENCE**

STATION	FOOT
3377+00 TO 3390+00, LT	260
<b>SUBTOTAL</b>	<b>260</b>

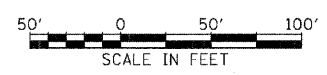

REVISIONS	
NAME	DATE

ILLINOIS DEPARTMENT OF TRANSPORTATION  
 F.A.P. ROUTE 307 (ILLINOIS ROUTE 64)

**EROSION CONTROL PLAN**  
 IL ROUTE 64  
 STA. 3377+00 TO STA. 3390+00

SCALE: VERT: NONE  
 HORIZ: 1"=50'  
 DATE: NOVEMBER 1, 2011

DRAWN BY: AFC  
 CHECKED BY: NJH