

F.A.P. RTE.	SECTION	COUNTY	TOTAL SHEETS	SHEET NO.
307	130 R-2	DUPAGE, KANE	647	161
STA. 3404+00		TO STA. 3422+54		
FED. ROAD DIST. NO.		ILLINOIS FED. AID PROJECT		

62410

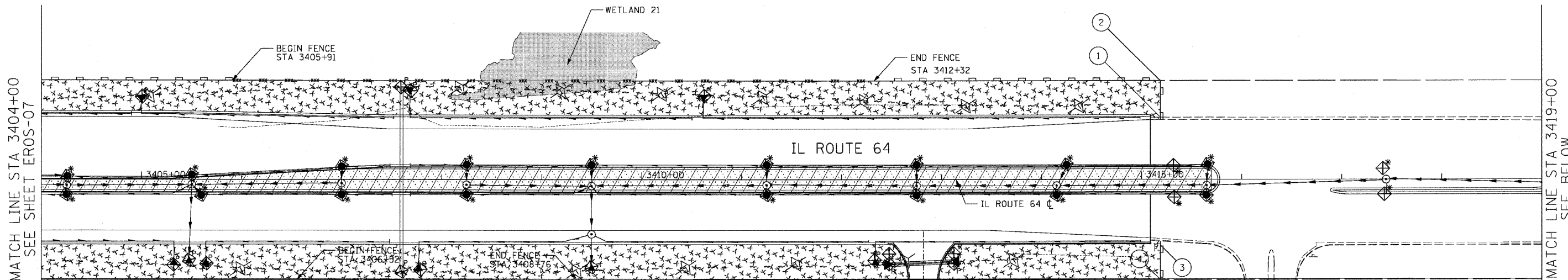

MATCH LINE STA 3404+00
SEE SHEET EROS-07

MATCH LINE STA 3419+00
SEE BELOW

EROSION CONTROL LEGEND	STAGE 1	STAGE 2
INLET FILTER		
PIPE PROTECTION		
TEMPORARY DITCH CHECKS		
PERIMETER EROSION BARRIER		
WETLAND PROTECTION FENCE (SPECIAL)		
AGGREGATE (EROSION CONTROL)		
TEMPORARY EROSION CONTROL SEEDING / MULCH METHOD 2		

TEMPORARY EROSION CONTROL SEEDING

STATION	POUND
3404+00 TO 3419+00, LT	515
3404+00 TO 3419+00, RT	893
3419+00 TO 3423+00, LT	0
3419+00 TO 3423+00, RT	51
SUBTOTAL	1,459

PERIMETER EROSION BARRIER

STATION	FOOT
3404+00 TO 3419+00, LT	516
3404+00 TO 3419+00, RT	934
3419+00 TO 3423+00, LT	0
3419+00 TO 3423+00, RT	0
SUBTOTAL	1,450

TEMPORARY DITCH CHECKS

STATION	FOOT
3405+09, 85' LT	10
3408+19, 93' LT	10
3409+20, 90' LT	10
3410+21, 86' LT	10
3411+22, 83' LT	10
3412+23, 80' LT	10
3413+25, 75' LT	10
3414+38, 75' LT	10

TEMPORARY DITCH CHECKS CONT.

STATION	FOOT
3406+00, 89' RT	10
3409+36, 92' RT	10
3410+45, 88' RT	10
3411+55, 84' RT	10
3412+64, 81' RT	10
3413+73, 81' RT	10
SUBTOTAL	140

INLET AND PIPE PROTECTION

STATION	DESCRIPTION	INLET AND PIPE PROTECTION EACH
3404+25, 15' RT	CB	1
3404+25, 3' LT	CB	1
3405+48, 81' RT	FES	1
3405+50, 5' LT	CB	1
3405+60, 15' RT	CB	1
3407+00, 13' LT	CB	1
3407+00, 15' RT	CB	1
3407+60, 92' LT	FES	1
3407+60, 93' RT	FES	1
3408+25, 15' LT	CB	1
3408+25, 15' RT	CB	1
3409+50, 15' LT	CB	1
3409+50, 88' RT	FES	1
3411+25, 15' LT	CB	1
3411+25, 15' RT	CB	1
3412+50, 81' RT	FES	1
3412+75, 15' LT	CB	1
3412+75, 15' RT	CB	1
3413+15, 80' RT	FES	1
3414+15, 15' RT	CB	1
3414+25, 15' LT	CB	1
3415+65, 15' LT	CB	1
3415+65, 15' RT	CB	1
3415+80, 80' RT	FES	1
3415+99, 77' LT	FES	1
3416+69, 77' LT	FES	1
3416+77, 79' RT	FES	1
3417+43, 15' RT	EX IN	1
3419+70, 79' RT	FES	1
3419+72, 80' LT	FES	1
3419+95, 15' RT	EX IN	1
3420+25, 2' LT	CB	1
3420+51, 79' RT	FES	1
3420+53, 80' LT	FES	1
3421+95, 12' LT	EX IN	1
3421+95, 15' RT	EX IN	1

MATCH LINE STA 3419+00
SEE ABOVE

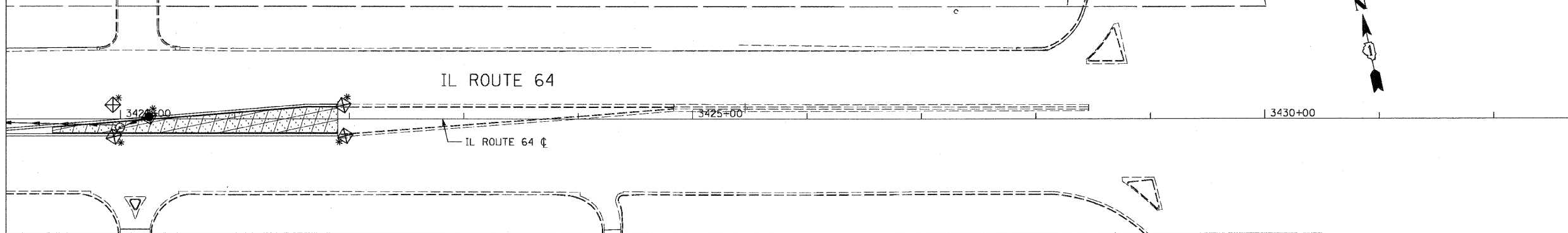

WETLAND PROTECTION FENCE

STATION	FOOT
3404+00 TO 3419+00, LT	642
3404+00 TO 3419+00, RT	224
SUBTOTAL	866

PERIMETER BARRIER LOCATIONS

POINT	STATION	OFFSET
1	3415+18.7	62.4' LT
2	3415+18.7	99.1' LT
3	3415+18.7	66.1' RT
4	3415+18.7	100.9' RT

EROS-08



REVISIONS	NAME	DATE

ILLINOIS DEPARTMENT OF TRANSPORTATION
 F.A.P. ROUTE 307 (ILLINOIS ROUTE 64)
EROSION CONTROL PLAN
 IL ROUTE 64
 STA. 3404+00 TO STA. 3422+54
 SCALE: VERT: NONE
 HORIZ: 1"=50'
 DATE: NOVEMBER 1, 2011
 DRAWN BY: AFC
 CHECKED BY: NJH