

F.A.P. RTE.	SECTION	COUNTY	TOTAL SHEETS	SHEET NO.
307	130 R-2	DUPAGE, KANE	647	247
STA.		TO STA.		
FED. ROAD DIST. NO.		ILLINOIS FED. AID PROJECT		

62410

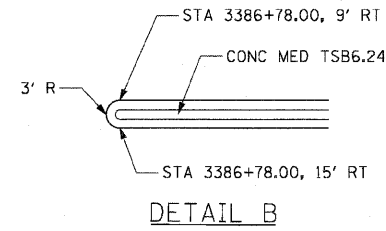

IL ROUTE 64

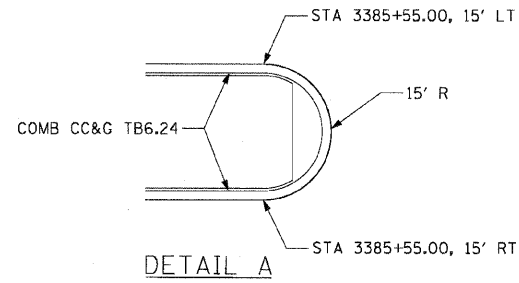
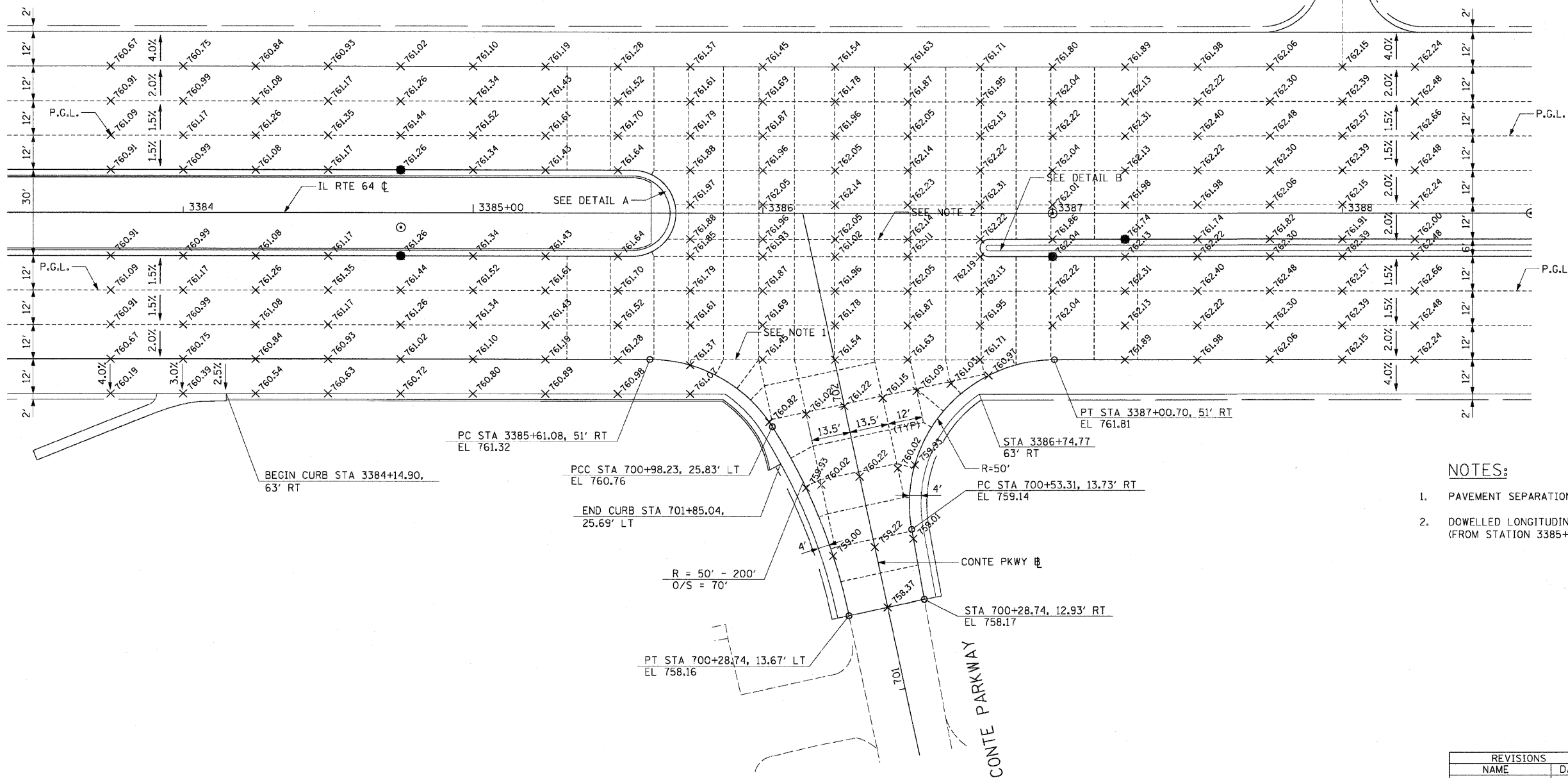

NOTES:

1. PAVEMENT SEPARATION JOINT IN ACCORDANCE WITH DETAIL BD52.
2. DOWELLED LONGITUDINAL JOINT FROM MEDIAN TO MEDIAN (FROM STATION 3385+67.00 TO STATION 3386+75.85).



REVISIONS	
NAME	DATE

ILLINOIS DEPARTMENT OF TRANSPORTATION
 F.A.P. ROUTE 307 (ILLINOIS ROUTE 64)

INTERSECTION DETAILS
 IL ROUTE 64 AND
 CONTE PARKWAY

SCALE: VERT: NONE
 HORIZ: 1"=20'
 DATE: NOVEMBER 1, 2011

DRAWN BY: AFC
 CHECKED BY: NJH

INT-09