

F.A.P. RTE.	SECTION	COUNTY	TOTAL SHEETS	SHEET NO.
307	130 R-2	DUPAGE, KANE	647	318
STA. 6579+61		TO STA. 6602+50		
FED. ROAD DIST. NO.		ILLINOIS FED. AID PROJECT		

62410

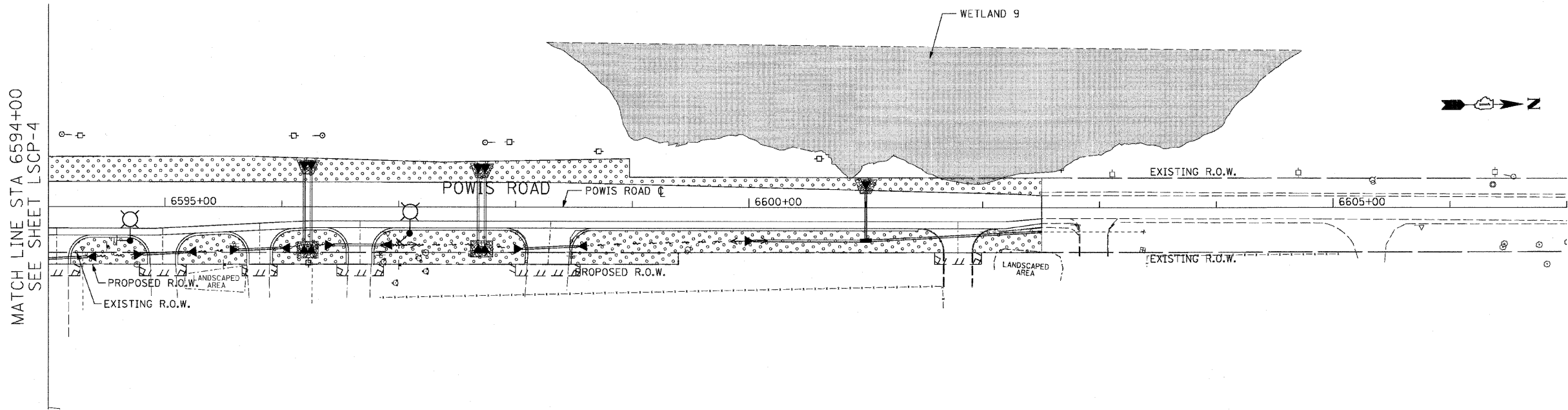

MATCH LINE STA 6594+00
SEE SHEET LSCP-4

- LEGEND:**
- FURNISHING AND PLACING TOPSOIL, 4" AND SEEDING CLASS 2A EROSION CONTROL BLANKET
 - FURNISHING AND PLACING TOPSOIL, 4" AND SODDING, SALT TOLERANT EROSION CONTROL BLANKET
 - FURNISHING AND PLACING TOPSOIL, 24" AND SEEDING CLASS 2A EROSION CONTROL BLANKET
 - COMPOST, 2" SEEDING CLASS 4 (PRAIRIE GRASS) EROSION CONTROL BLANKET
 - COMPOST, 2" SEEDING CLASS 4B (MODIFIED) WETLAND MIX EROSION CONTROL BLANKET
 - SELECTIVE MOWING STAKE WITH SIGN

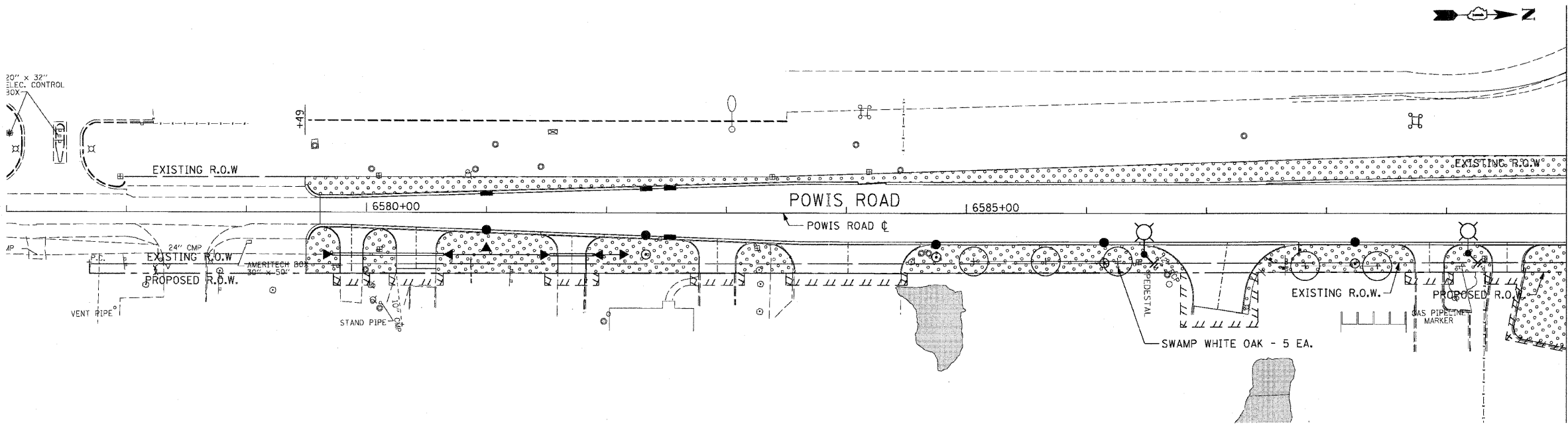

MATCH LINE STA 6590+00
SEE SHEET LSCP-4

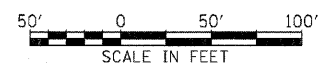

REVISIONS	
NAME	DATE
S. LIPKIE	06/11

ILLINOIS DEPARTMENT OF TRANSPORTATION
 F.A.P. ROUTE 307 (ILLINOIS ROUTE 64)

LANDSCAPING PLAN
 POWIS ROAD
 STA. 6579+61 TO STA. 6602+50

SCALE: VERT: NONE
 HORIZ: 1"=50'
 DATE: NOVEMBER 1, 2011

DRAWN BY: AFC
 CHECKED BY: NJH

LSCP-9