

F.A.P. RTE.	SECTION	COUNTY	TOTAL SHEETS	SHEET NO.
307	130 R-2	DUPAGE, KANE	647	340
STA.		TO STA.		
FED. ROAD DIST. NO.		ILLINOIS FED. AID PROJECT		

62410

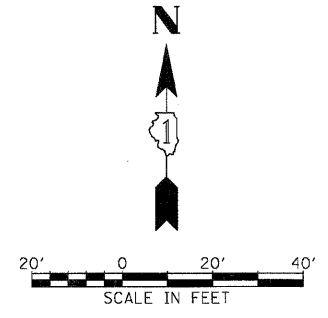

CROSS MEDIAN ACCESS WILL NOT BE ALLOWED DURING STAGE 2. CROSS MEDIAN TRAFFIC WILL BE DETOURED TO AN ADJACENT INTERSECTION OR MEDIAN OPENING WITH U-TURN ACCESS. EASTBOUND AND WESTBOUND LEFT TURN SIGNALS SHALL BE DISCONNECTED AND BAGGED DURING STAGE 2. SEE TEMPORARY PHASE DESIGNATION DIAGRAM (SHEET 6 OF 9) FOR STAGE 2 SIGNAL PHASING.

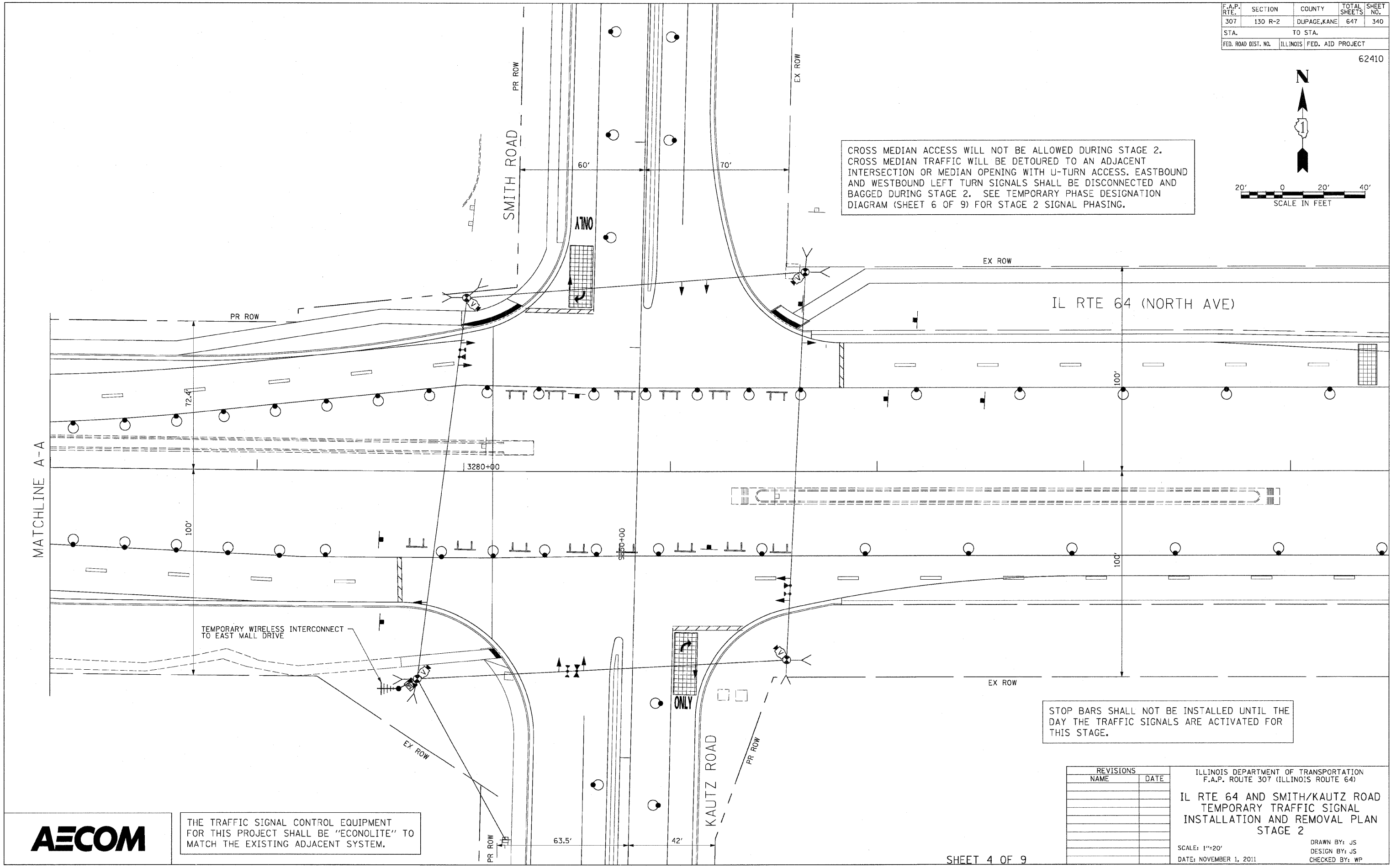

STOP BARS SHALL NOT BE INSTALLED UNTIL THE DAY THE TRAFFIC SIGNALS ARE ACTIVATED FOR THIS STAGE.

THE TRAFFIC SIGNAL CONTROL EQUIPMENT FOR THIS PROJECT SHALL BE "ECONOLITE" TO MATCH THE EXISTING ADJACENT SYSTEM.

REVISIONS	
NAME	DATE

ILLINOIS DEPARTMENT OF TRANSPORTATION
 F.A.P. ROUTE 307 (ILLINOIS ROUTE 64)
**IL RTE 64 AND SMITH/KAUTZ ROAD
 TEMPORARY TRAFFIC SIGNAL
 INSTALLATION AND REMOVAL PLAN
 STAGE 2**
 SCALE: 1"=20'
 DATE: NOVEMBER 1, 2011
 DRAWN BY: JS
 DESIGN BY: JS
 CHECKED BY: WP

