

F.A.P. RTE.	SECTION	COUNTY	TOTAL SHEETS	SHEET NO.
307	130 R-2	DUPAGE, KANE	647	356
STA.		TO STA.		
FED. ROAD DIST. NO.		ILLINOIS FED. AID PROJECT		

62410

CROSS MEDIAN ACCESS WILL NOT BE ALLOWED DURING STAGE 2A. CROSS MEDIAN TRAFFIC WILL BE DETOURED TO AN ADJACENT INTERSECTION OR MEDIAN OPENING WITH U-TURN ACCESS. EASTBOUND AND WESTBOUND LEFT TURN SIGNALS SHALL BE DISCONNECTED AND BAGGED DURING STAGE 2A. SEE TEMPORARY PHASE DESIGNATION DIAGRAM (SHEET 10 OF 10) FOR STAGE 2A SIGNAL PHASING.

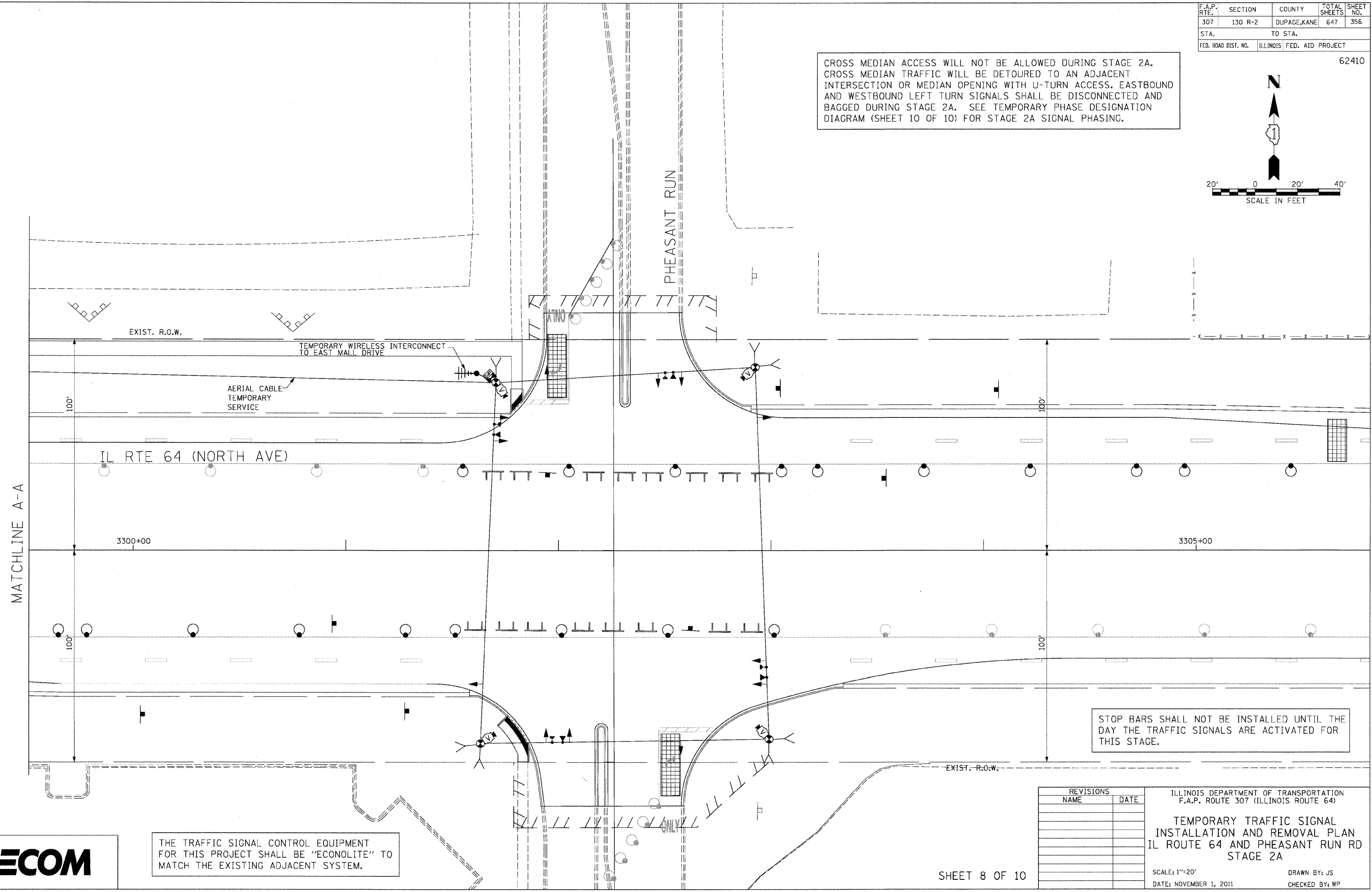
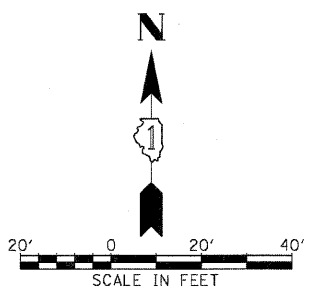

EXIST. R.O.W.

TEMPORARY WIRELESS INTERCONNECT TO EAST MALL DRIVE

AERIAL CABLE TEMPORARY SERVICE

IL RTE 64 (NORTH AVE)

3300+00

3305+00

EXIST. R.O.W.

STOP BARS SHALL NOT BE INSTALLED UNTIL THE DAY THE TRAFFIC SIGNALS ARE ACTIVATED FOR THIS STAGE.

THE TRAFFIC SIGNAL CONTROL EQUIPMENT FOR THIS PROJECT SHALL BE "ECONOLITE" TO MATCH THE EXISTING ADJACENT SYSTEM.

REVISIONS	
NAME	DATE

ILLINOIS DEPARTMENT OF TRANSPORTATION  
 F.A.P. ROUTE 307 (ILLINOIS ROUTE 64)  
 TEMPORARY TRAFFIC SIGNAL  
 INSTALLATION AND REMOVAL PLAN  
 IL ROUTE 64 AND PHEASANT RUN RD  
 STAGE 2A  
 SCALE: 1"=20'  
 DATE: NOVEMBER 1, 2011  
 DRAWN BY: JS  
 CHECKED BY: WP

