

F.A.P. RTE.	SECTION	COUNTY	TOTAL SHEETS	SHEET NO.
307	130 R-2	DUPAGE, KANE	647	388
STA. 3260+00		TO STA. 3290+00		
FED. ROAD DIST. NO.		ILLINOIS FED. AID PROJECT		

62410

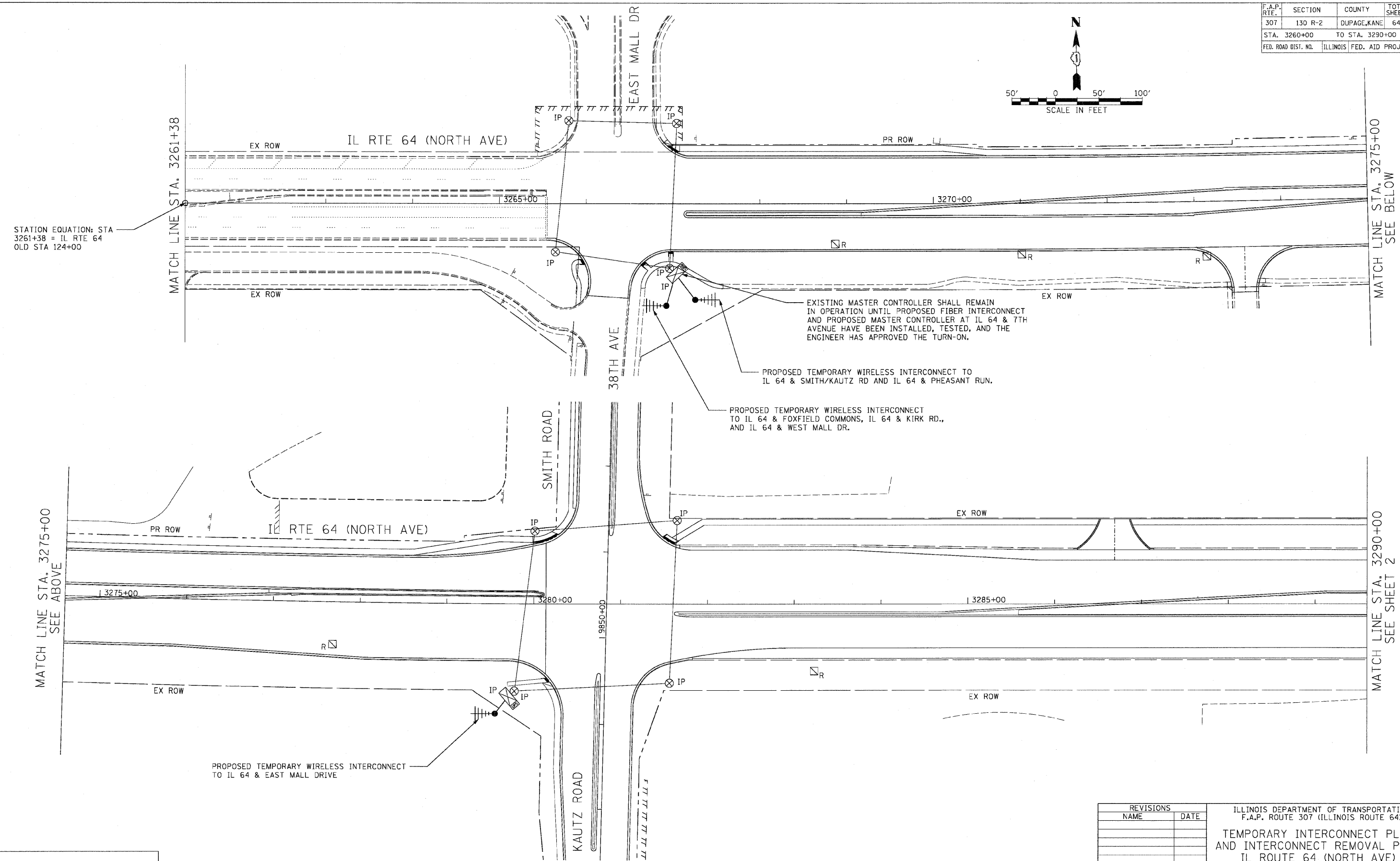
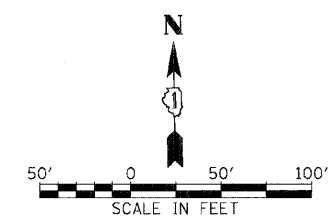

STATION EQUATION: STA 3261+38 = IL RTE 64
 OLD STA 124+00

MATCH LINE STA. 3275+00
 SEE ABOVE

MATCH LINE STA. 3290+00
 SEE SHEET 2



REVISIONS	
NAME	DATE

ILLINOIS DEPARTMENT OF TRANSPORTATION
 F.A.P. ROUTE 307 (ILLINOIS ROUTE 64)
**TEMPORARY INTERCONNECT PLAN
 AND INTERCONNECT REMOVAL PLAN**
 IL ROUTE 64 (NORTH AVE)
 STA. 3261+38 TO STA. 3290+00
 SCALE: 1"=50'
 DATE: NOVEMBER 1, 2011
 DRAWN BY: JS
 DRAWN BY: JS
 CHECKED BY: WP