

CIVIL ENGINEERING CONSULTANTS
RWA
 Regina Webster & Associates, Inc.
 8619 W. Bryn Mawr Ave., Suite 602
 Chicago, IL 60631-3551
 773-283-2600 Fax: 773-283-2602
 www.RWAEngineers.com

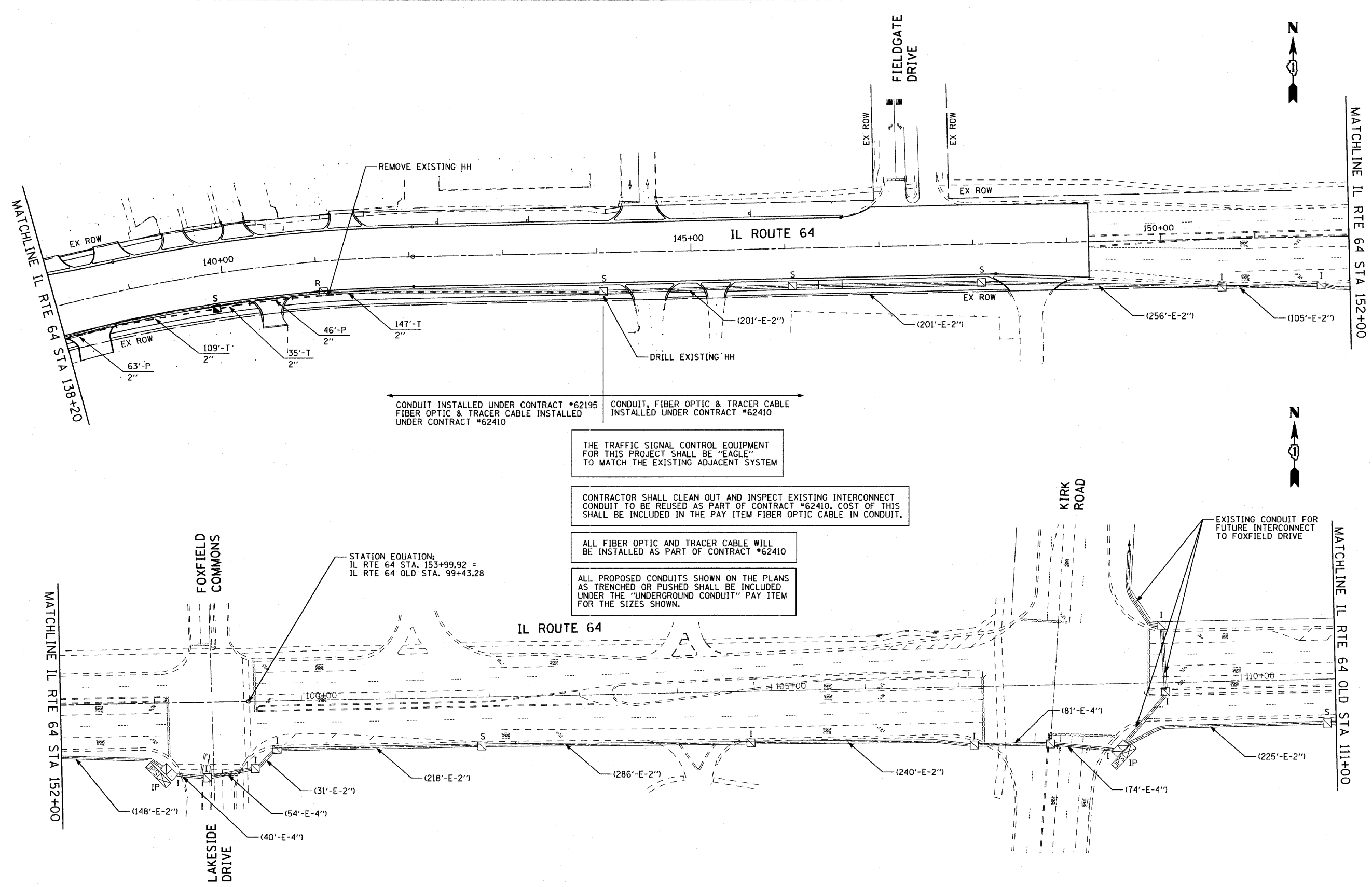

CONDUIT INSTALLED UNDER CONTRACT #62195
 FIBER OPTIC & TRACER CABLE INSTALLED
 UNDER CONTRACT #62410

CONDUIT, FIBER OPTIC & TRACER CABLE
 INSTALLED UNDER CONTRACT #62410

THE TRAFFIC SIGNAL CONTROL EQUIPMENT
 FOR THIS PROJECT SHALL BE "EAGLE"
 TO MATCH THE EXISTING ADJACENT SYSTEM

CONTRACTOR SHALL CLEAN OUT AND INSPECT EXISTING INTERCONNECT
 CONDUIT TO BE REUSED AS PART OF CONTRACT #62410. COST OF THIS
 SHALL BE INCLUDED IN THE PAY ITEM FIBER OPTIC CABLE IN CONDUIT.

ALL FIBER OPTIC AND TRACER CABLE WILL
 BE INSTALLED AS PART OF CONTRACT #62410

ALL PROPOSED CONDUITS SHOWN ON THE PLANS
 AS TRENCHED OR PUSHED SHALL BE INCLUDED
 UNDER THE "UNDERGROUND CONDUIT" PAY ITEM
 FOR THE SIZES SHOWN.

STATION EQUATION:
 IL RTE 64 STA. 153+99.92 =
 IL RTE 64 OLD STA. 99+43.28

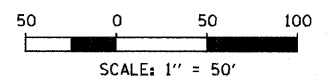

SHEET 4 OF 8

FILE NAME =	USER NAME = #USER#	DESIGNED - DW	REVISED -
#FILEL#		DRAWN - DW	REVISED -
	PLOT SCALE = #SCALE#	CHECKED - JS	REVISED -
	PLOT DATE = #DATE#	DATE -	REVISED -

STATE OF ILLINOIS
DEPARTMENT OF TRANSPORTATION

INTERCONNECT PLAN IL ROUTE 64
EAST OF DUNHAM ROAD TO WEST OF KIRK ROAD

SCALE: 1"=50'-0" SHEET NO. OF SHEETS STA. TO STA.

F.A. RTE.	SECTION	COUNTY	TOTAL SHEETS	SHEET NO.
307	130 R-2	KANE	647	398
CONTRACT NO. 62410				
ILLINOIS FED. AID PROJECT				