

F.A.P. RTE.	SECTION	COUNTY	TOTAL SHEETS	SHEET NO.
307	130 R-2	DUPAGE, KANE	647	418
STA. TO STA.		ILLINOIS FED. AID PROJECT		
FED. ROAD DIST. NO.		62410		

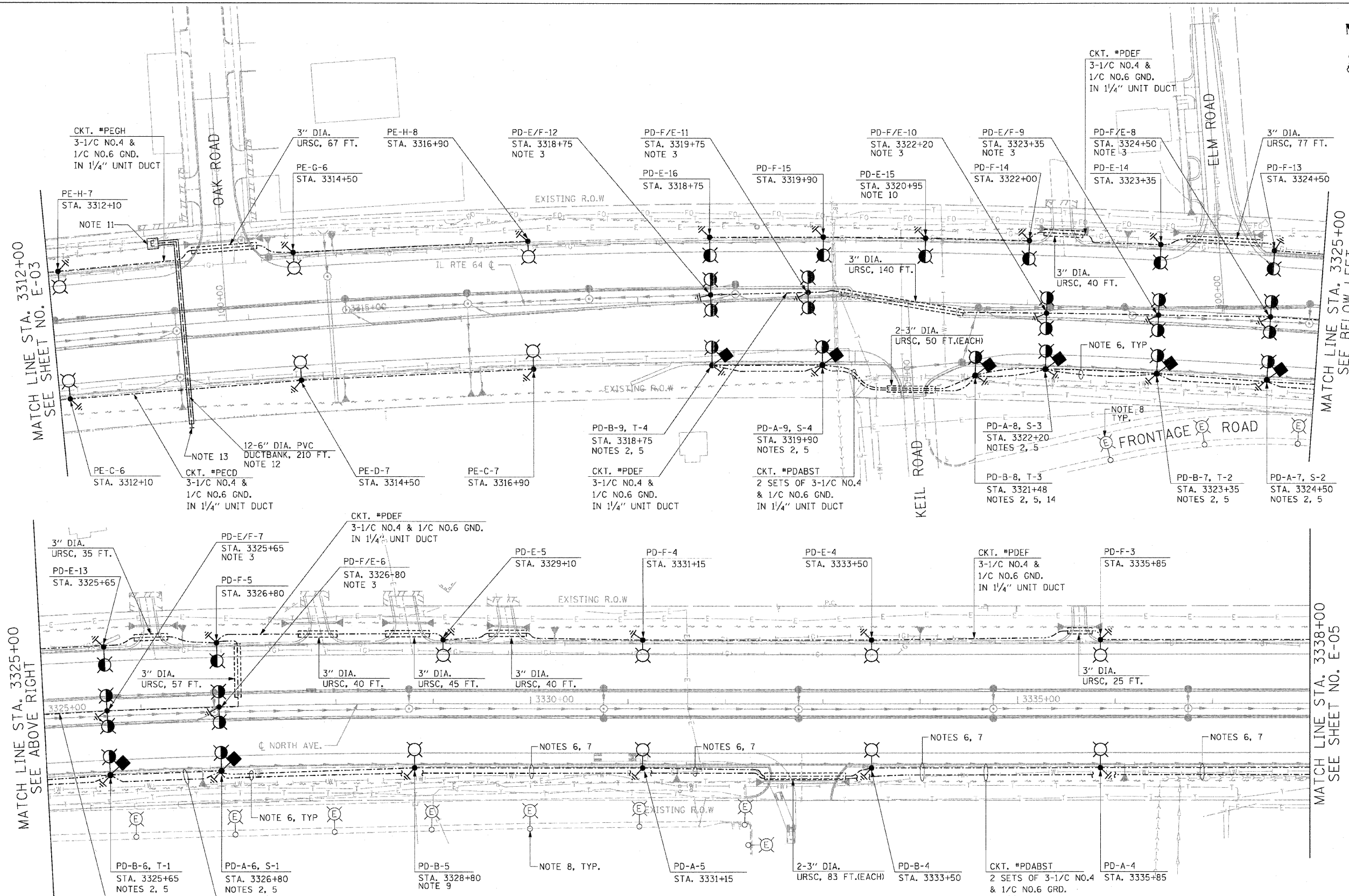

- NOTES:**
- SEE SHEET E-01 FOR ELECTRICAL SYMBOLS, CALL-OUT SAMPLES, ABBREVIATIONS AND GENERAL NOTES.
  - PROVIDE 2 - 3/2" PVC CONDUIT SLEEVES IN THE POLE FOUNDATION FOR LIGHTING UNIT DUCTS.
  - FOR LIGHT POLES LOCATED IN THE MEDIAN AREA, CONTRACTOR SHALL CENTER LIGHT POLES BETWEEN MEDIAN OR ADJUST LIGHT POLES TO MEET MINIMUM 2 FEET CLEARANCE FROM THE BACK OF CURB TO THE FACE OF LIGHT POLE.
  - THE TYPICAL LIGHT POLE SETBACK SHALL BE 15 FEET FROM EDGE OF PAVEMENT TO THE FACE OF LIGHT POLE, UNO.
  - PROVIDE AN AVIATION OBSTRUCTION WARNING LUMINAIRE. THE OBSTRUCTION LUMINAIRE SHALL BE OPERATED AT 240 VOLTS. SEE SHEET E-12 FOR AVIATION OBSTRUCTION WARNING LUMINAIRE MOUNTING DETAILS.
  - PROVIDE TWO 1/4" UNIT DUCTS.
  - THE UNIT DUCT THAT FEEDS AVIATION OBSTRUCTION WARNING LUMINAIRE SHALL SWEEP AROUND THE LIGHT POLE FOUNDATIONS.
  - EXISTING LIGHTING UNIT OWNED AND OPERATED BY DUPAGE COUNTY AIRPORT.
  - OFFSET LIGHTING UNIT 19'-6" FROM THE EDGE OF PAVEMENT TO THE FACE OF LIGHT POLE.
  - OFFSET LIGHTING UNIT 18'-6" FROM THE EDGE OF PAVEMENT TO THE FACE OF LIGHTING UNIT.
  - ROUTE PROPOSED CONCRETE ENCASED DUCTBANK INTO EXISTING ELECTRIC UTILITY MANHOLE.
  - PROVIDE TWELVE 6" DIA. SCHEDULE 40 PVC CONDUITS ENCASED IN REINFORCED CONCRETE DUCTBANK. INSTALL DUCTBANK AT APPROXIMATELY STA. 3313+30. COORDINATE FINAL DUCTBANK INSTALLATION LOCATION AND DEPTH WITH DRAINAGE AND CIVIL WORK. SEE SHEET E-16 FOR DUCTBANK DETAILS.
  - ROUTE DUCTBANK TO THE R.O.W. AND CAP ENDS FOR FUTURE USE. MARK END OF DUCTBANK WITH A SECTION OF 6" DIA. PVC CONDUIT INSTALLED VERTICALLY IN THE GROUND. SEE SHEET E-16 FOR DETAILS.
  - VERIFY EXISTING WATER MAIN HAS BEEN RELOCATED BY OTHERS PRIOR TO INSTALLATION OF LIGHT POLE FOUNDATION.

MATCH LINE STA. 3325+00  
 SEE ABOVE RIGHT

MATCH LINE STA. 3325+00  
 SEE BELOW LEFT

MATCH LINE STA. 3338+00  
 SEE SHEET NO. E-05

E-04

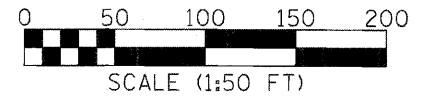

REVISIONS	
NAME	DATE

ILLINOIS DEPARTMENT OF TRANSPORTATION  
 F.A.P. ROUTE 307 (ILLINOIS ROUTE 64)

**ROADWAY LIGHTING PLAN**  
 STA. 3312+00 TO STA. 3338+00

SCALE: 1" = 50'  
 DATE: NOVEMBER 1, 2011

DRAWN BY: HR  
 CHECKED BY: JPC