

STATE OF ILLINOIS
 DEPARTMENT OF TRANSPORTATION

Benchmark: "C" Cut in SW Corner Concrete Base of Traffic Signal Box in NW Corner IL Rte. 64 & Powis Rd. Elev. 758.46

Existing Structure: None.

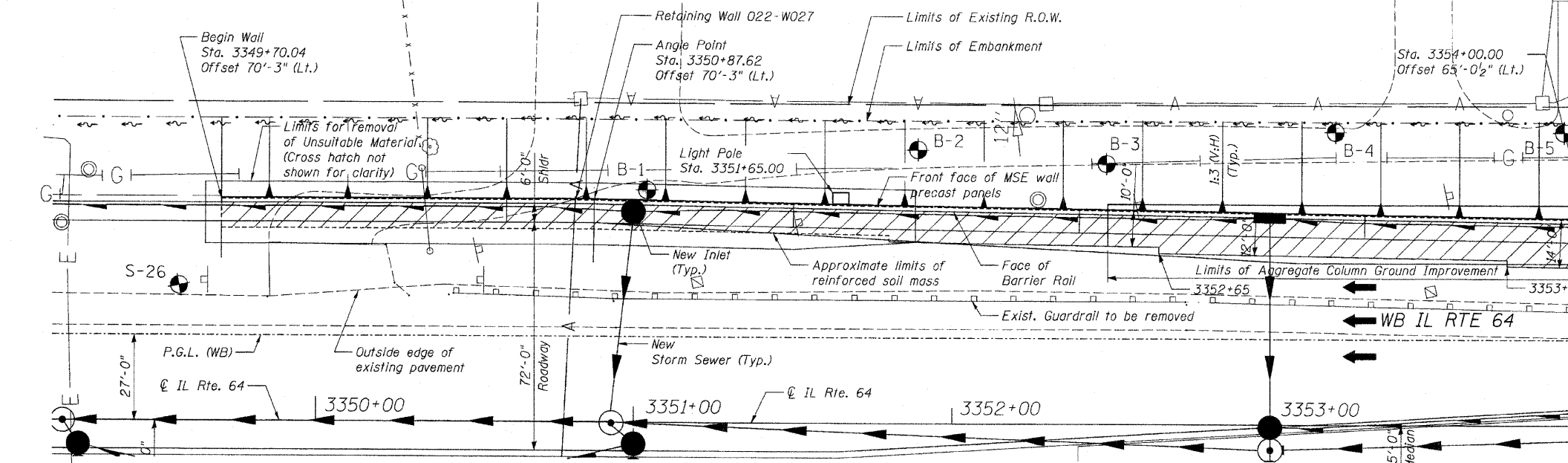

PLAN

Match Line Sta. 3354+00 See Sheet NW2

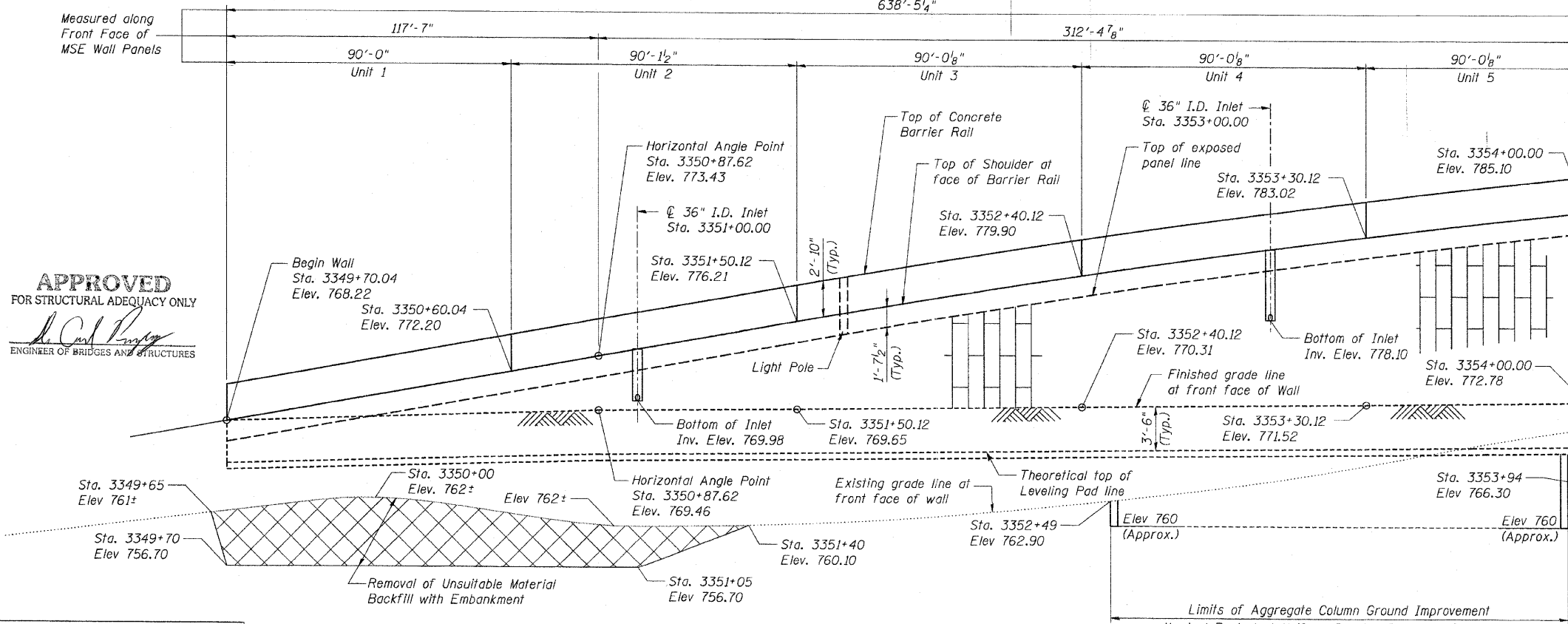

ELEVATION

(Looking North at back face of Wall)

APPROVED FOR STRUCTURAL ADEQUACY ONLY
 [Signature]
 ENGINEER OF BRIDGES AND STRUCTURES



F.A.P. RTE.	SECTION	COUNTY	TOTAL SHEETS	SHEET NO.
307	130 R-2	DUPAGE, KANE	647	500
STA. 3356+37.74		TO STA. 3359+24.72		
FED. ROAD DIST. NO.		ILLINOIS FED. AID PROJECT		62410

DESIGN SPECIFICATIONS

AASHTO Standard Specifications for Highway Bridges, 17th Edition-2002

DESIGN STRESSES

FIELD UNITS

f'c = 3,500 psi
 fy = 60,000 psi (Reinforcement)

PRECAST UNITS

f'c = 4,500 psi (Precast Face Panels)

INDEX OF SHEETS:

- NW1 General Plan
- NW2 General Plan
- NW3 Typical Sections
- NW4 Typical Sections
- NW5 Moment Slab Details
- NW6 Moment Slab Details
- NW7 Moment Slab Details at Drainage Structure
- NW8 Coping Details
- NW9 Reinforcement Details and Bill of Material

NOTES:

1. For General Notes see Sheet NW2.
2. The face of abutment station is measured to an offset equal to 63'-9" (The assumed back face of the MSE wall panels).
3. The vertical scale of the Elevation view has been exaggerated to show detail.

BILL OF MATERIAL

Item	Unit	Quantity
Removal and Disposal of Unsuitable Material	Cu Yd	525
Structure Excavation	Cu Yd	300
Concrete Structures	Cu Yd	271.5
Protective Coat	Sq Yd	648
Reinforcement Bars, Epoxy Coated	Pound	44,420
Mechanically Stabilized Earth Retaining Wall	Sq Ft	6,703
Aggregate Column Ground Improvement	L. Sum	0.25
Conduit Embedded in Structure, 2" Dia., PVC	Foot	606



EXPIRATION DATE: 11-30-2012

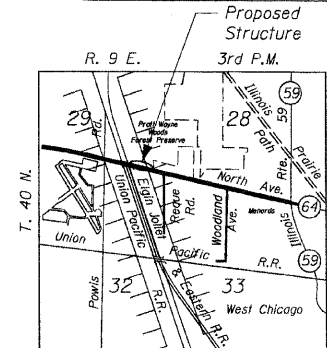

REVISIONS	
NAME	DATE

F.A.P. ROUTE 307 ILLINOIS ROUTE 64 (NORTH AVENUE) OVER E.J.&E. AND U.P. R.R. GENERAL PLAN NORTH AVENUE STRUCTURE NUMBER 022-W027 FAP 307 SECTION 130 R-2 DUPAGE COUNTY STA. 3349+70.04 TO 3356+08.49 SCALE: None DRAWN BY: MRK DATE: NOVEMBER 1, 2011 CHECKED BY: MJP