

STATE OF ILLINOIS
 DEPARTMENT OF TRANSPORTATION

F.A.P. RTE.	SECTION	COUNTY	TOTAL SHEETS	SHEET NO.
307	130 R-2	DUPAGE, KANE	647	509
STA. 3356+37.74		TO STA. 3359+24.72		
FED. ROAD DIST. NO.		ILLINOIS FED. AID PROJECT		

Benchmark: "C" Cut in SW Corner Concrete Base of Traffic Signal Box in NW Corner IL Rte. 64 & Powis Rd. Elev. 758.46

Existing Structure: None.

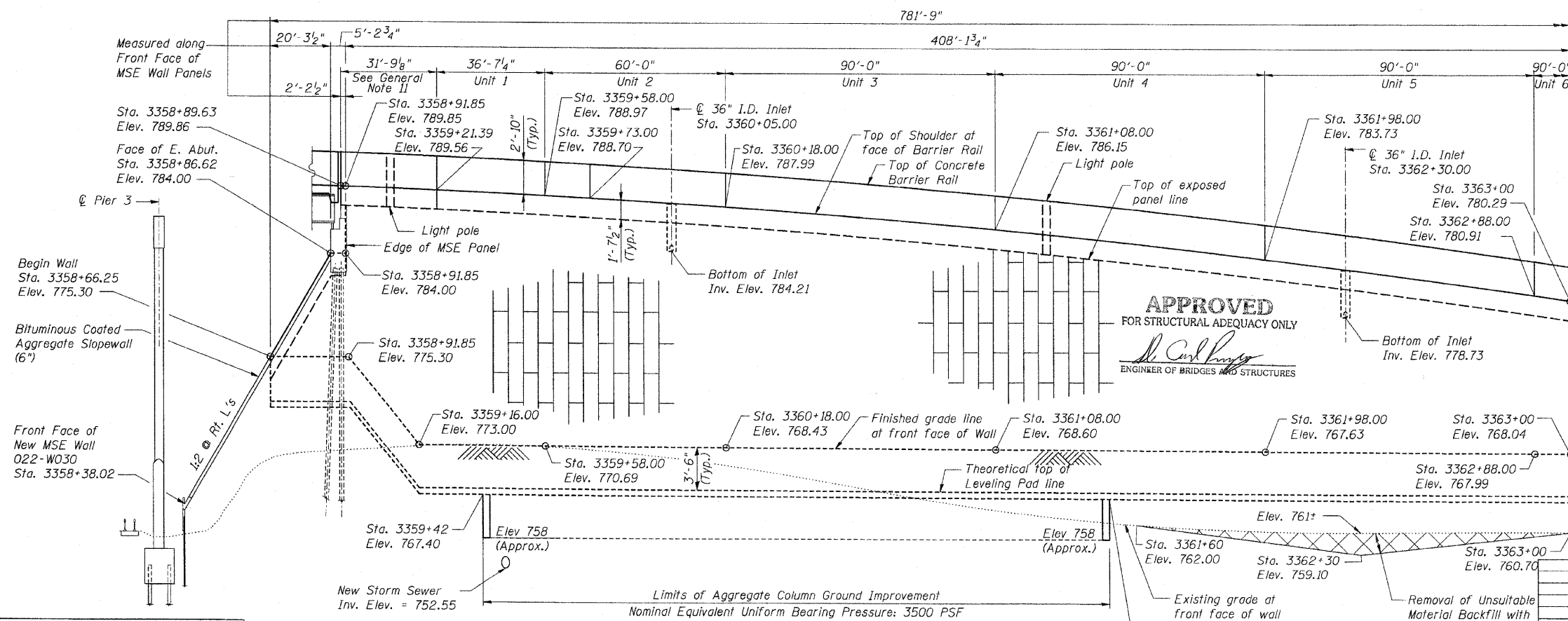
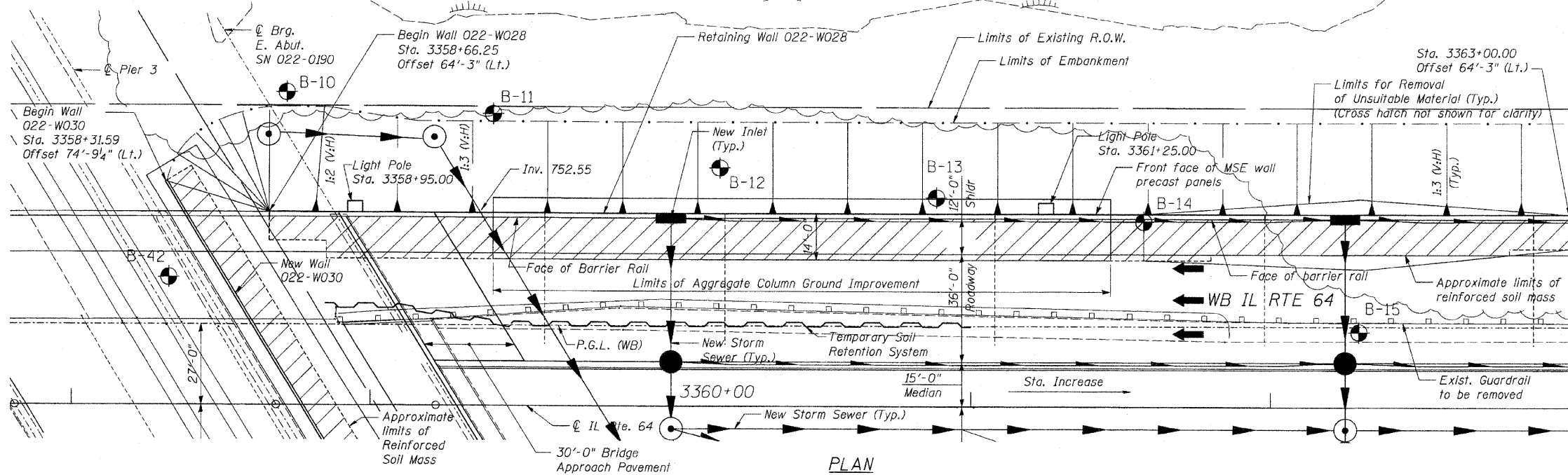

11-10-11

DESIGN SPECIFICATIONS 62410

AASHTO Standard Specifications for Highway Bridges, 17th Edition-2002

DESIGN STRESSES

FIELD UNITS

f'c = 3,500 psi
 fy = 60,000 psi (Reinforcement)

PRECAST UNITS

f'c = 4,500 psi (Precast Face Panels)

INDEX OF SHEETS:

- NE1 General Plan
- NE2 General Plan
- NE3 Typical Sections
- NE4 Typical Sections
- NE5 Moment Slab Details
- NE6 Moment Slab Details at Drainage Structure
- NE7 Coping Details
- NE8 Reinforcement Details and Bill of Material

NOTES:

1. For General Notes, see Sheet NE2.
2. The face of abutment station is measured to an offset equal to 63'-9" (The assumed back face of the MSE wall panels).
3. The vertical scale of the Elevation view has been exaggerated to show detail.
4. For Temporary Soil Retention System, see Sheet TS2.

BILL OF MATERIAL

Item	Unit	Quantity
Removal and Disposal of Unsuitable Material	Cu Yd	156
Structure Excavation	Cu Yd	1461
Concrete Structures	Cu Yd	330.9
Protective Coat	Sq Yd	788
Reinforcement Bars, Epoxy Coated	Pound	54,680
Temporary Soil Retention System	Sq Ft	2,331
Mechanically Stabilized Earth Retaining Wall	Sq Ft	10,589
Aggregate Column	L. Sum	0.25
Ground Improvement		
Conduit Embedded in Structure, 2" Dia., PVC	Foot	747

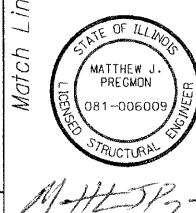

APPROVED
 FOR STRUCTURAL ADEQUACY ONLY
Matthew J. Pregon
 ENGINEER OF BRIDGES AND STRUCTURES

EXPIRATION DATE: 11-30-2012

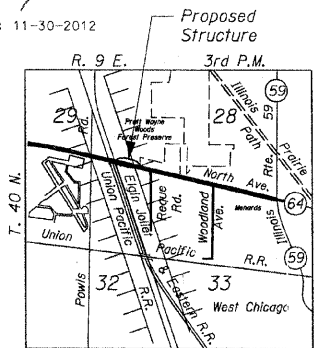

LOCATION SKETCH Not to Scale Sheet NE1 of 8

REVISIONS	NAME	DATE

F.A.P. ROUTE 307 ILLINOIS ROUTE 64 (NORTH AVENUE) OVER E.J.&E. AND U.P. R.R. GENERAL PLAN
 STRUCTURE NUMBER 022-W028
 FAP 307 SECTION 130 R-2
 DUPAGE COUNTY
 STA. 3358+66.25 TO 3366+48.00
 SCALE: DRAWN BY: MRK
 DATE: NOVEMBER 1, 2011 CHECKED BY: MJP