

### STATE OF ILLINOIS DEPARTMENT OF TRANSPORTATION

F.A.P. RTE.	SECTION	COUNTY	TOTAL SHEETS	SHEET NO.
307	130 R-2	DUPAGE, KANE	647	516
STA. 3356+37.74		TO STA. 3359+24.72		
FED. ROAD DIST. NO.		ILLINOIS FED. AID PROJECT		

62410

**BILL OF MATERIAL**

Bar	No.	Size	Length	Shape
a1(E)	1090	#5	8'-7"	
a2(E)	1090	#5	7'-6"	
a3(E)	9	#6	4'-9"	
a4(E)	64	#5	4'-8"	
a5(E)	2	#5	6'-6"	
a7(E)	9	#6	7'-11"	
b1(E)	391	#5	33'-8"	
b2(E)	34	#5	21'-8"	
d1(E)	1094	#5	5'-7"	
d2(E)	1094	#5	6'-2"	
d3(E)	362	#6	2'-6"	
d4(E)	15	#6	8'-11"	
d5(E)	9	#6	4'-5"	
e1(E)	161	#4	29'-6"	
e2(E)	23	#4	32'-1"	
e3(E)	23	#8	39'-5"	
e5(E)	7	#4	21'-1"	
e6(E)	1	#4	36'-1"	
e7(E)	1	#8	36'-1"	
e9(E)	7	#4	14'-6"	
Item				Unit
Reinforcement Bars, Epoxy Coated				Pound
				54,680

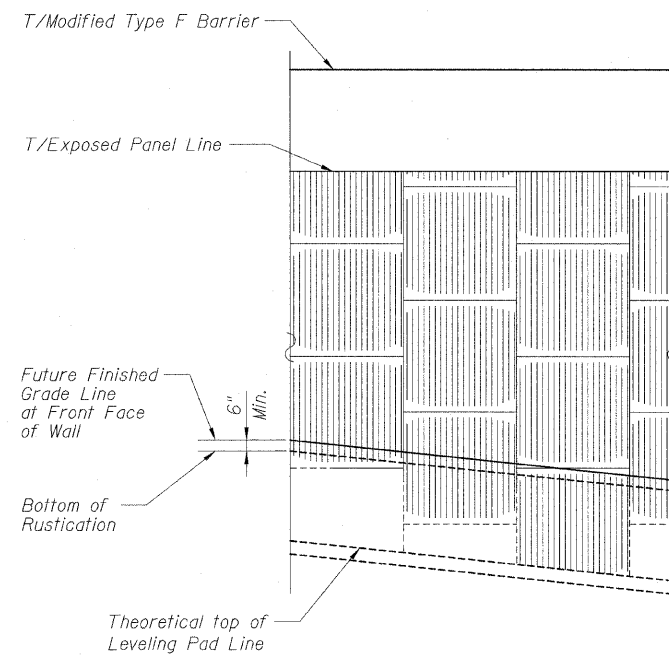

**ELEVATION  
TYPICAL ARCHITECTURAL FINISH**

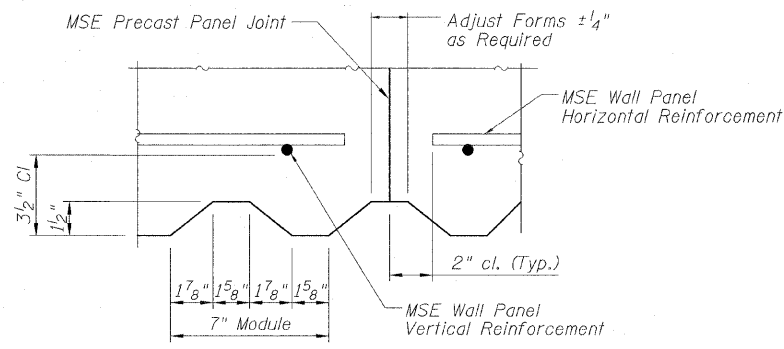

**MSE WALL PANEL FLUTE DETAIL  
Full Height of Wall**

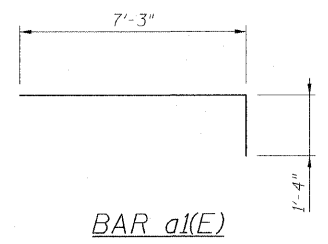

BAR a1(E)

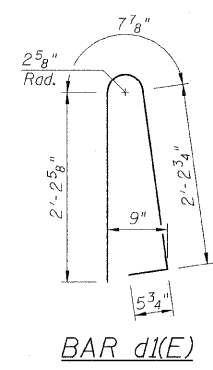

BAR d1(E)

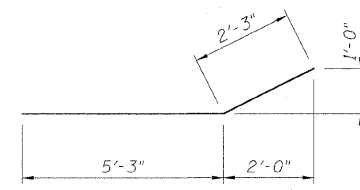

BAR d2(E)

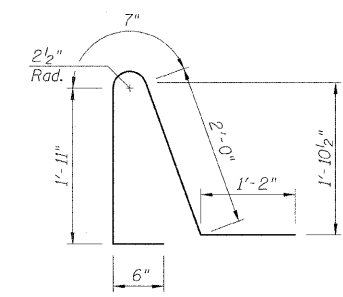

BAR d2(E)

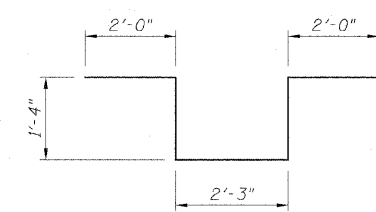

BAR d4(E)

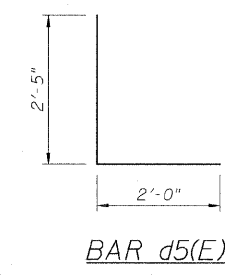

BAR d5(E)

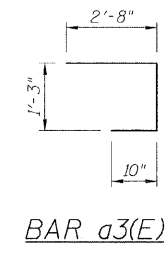

BAR a3(E)

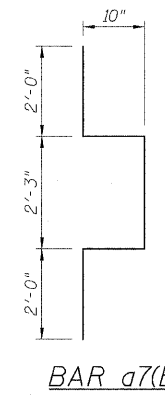

BAR a7(E)

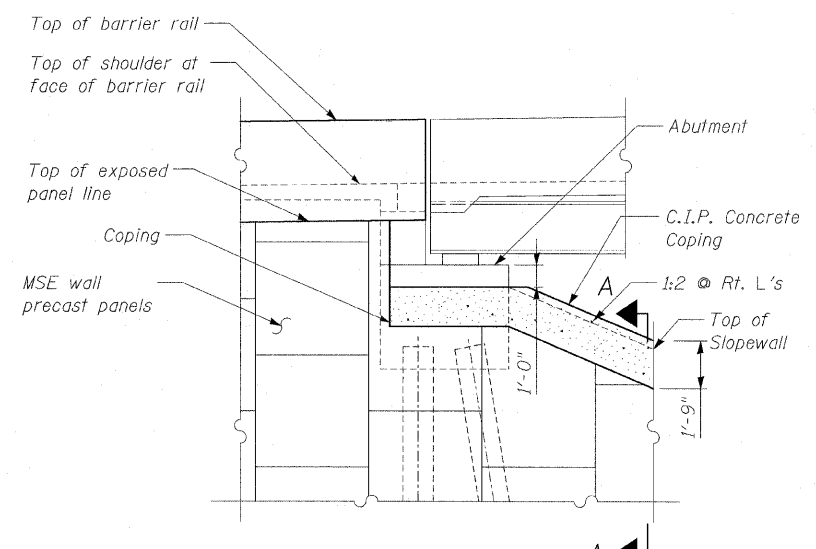

**DETAIL 1  
(Looking North)**

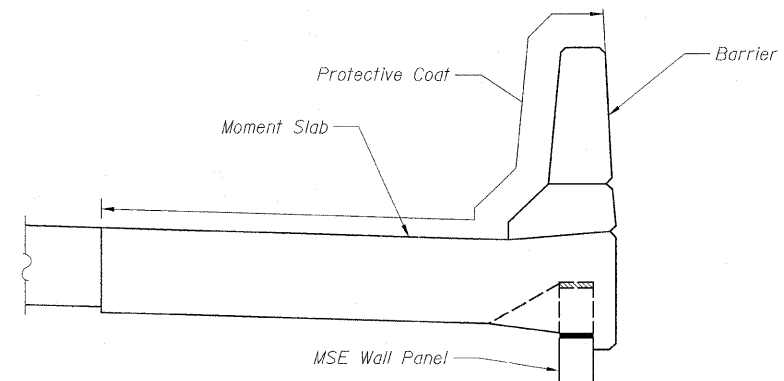

**PROTECTIVE COAT**

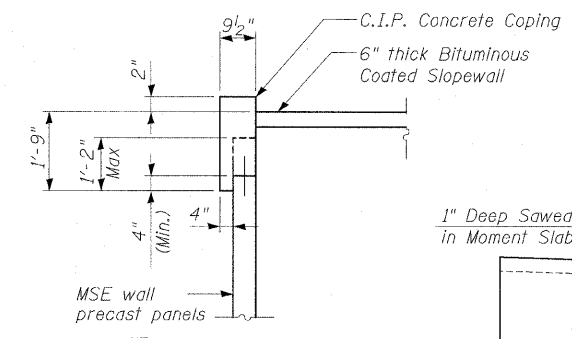

**SECTION A-A**

Non-staining gray one component non-sag elastomeric gun grade polyurethane sealant meeting the requirements of ASTM C-920, Type S, Grade NS, Class 25, Use T.

1/2 inch Preformed Self-Expanding Cork Joint Filler according to Article 1051.07 of the Std. Spec. Cost included with Concrete Structures.

\* Const. Jts. at ends of Units 1/8 inch Aluminum sheet ASTM B 209 alloy 3003-H14. Cost included with Concrete Structures.

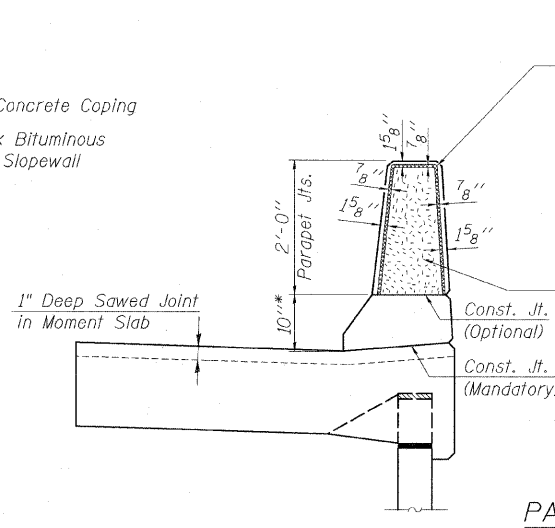

**PARAPET JOINT DETAILS**

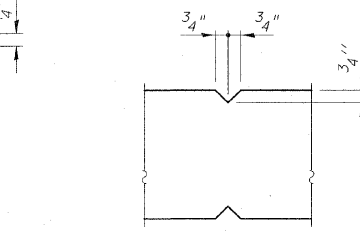

**3/4 inch V-GROOVED JOINT DETAIL**

**NOTES:**

1. For General Notes, see Sheet NE2.

REVISIONS	
NAME	DATE

F.A.P. ROUTE 307 ILLINOIS ROUTE 64  
 (NORTH AVENUE)  
 OVER E.J.&E. AND U.P. R.R.  
 REINFORCEMENT DETAILS  
 AND BILL OF MATERIAL  
 STRUCTURE NUMBER 022-W028  
 FAP 307 SECTION 130 R-2  
 DUPAGE COUNTY  
 STA. 3349+70.04 TO 3356+08.49  
 SCALE: None DRAWN BY: MRK  
 DATE: NOVEMBER 1, 2011 CHECKED BY: MJP

