

F.A.P. RTE.	SECTION	COUNTY	TOTAL SHEETS	SHEET NO.
307	130 R-2	DUPAGE, KANE	647	646
STA. 9853+36.17		TO STA. 9855+00.00		
FED. ROAD DIST. NO.		ILLINOIS FED. AID PROJECT		

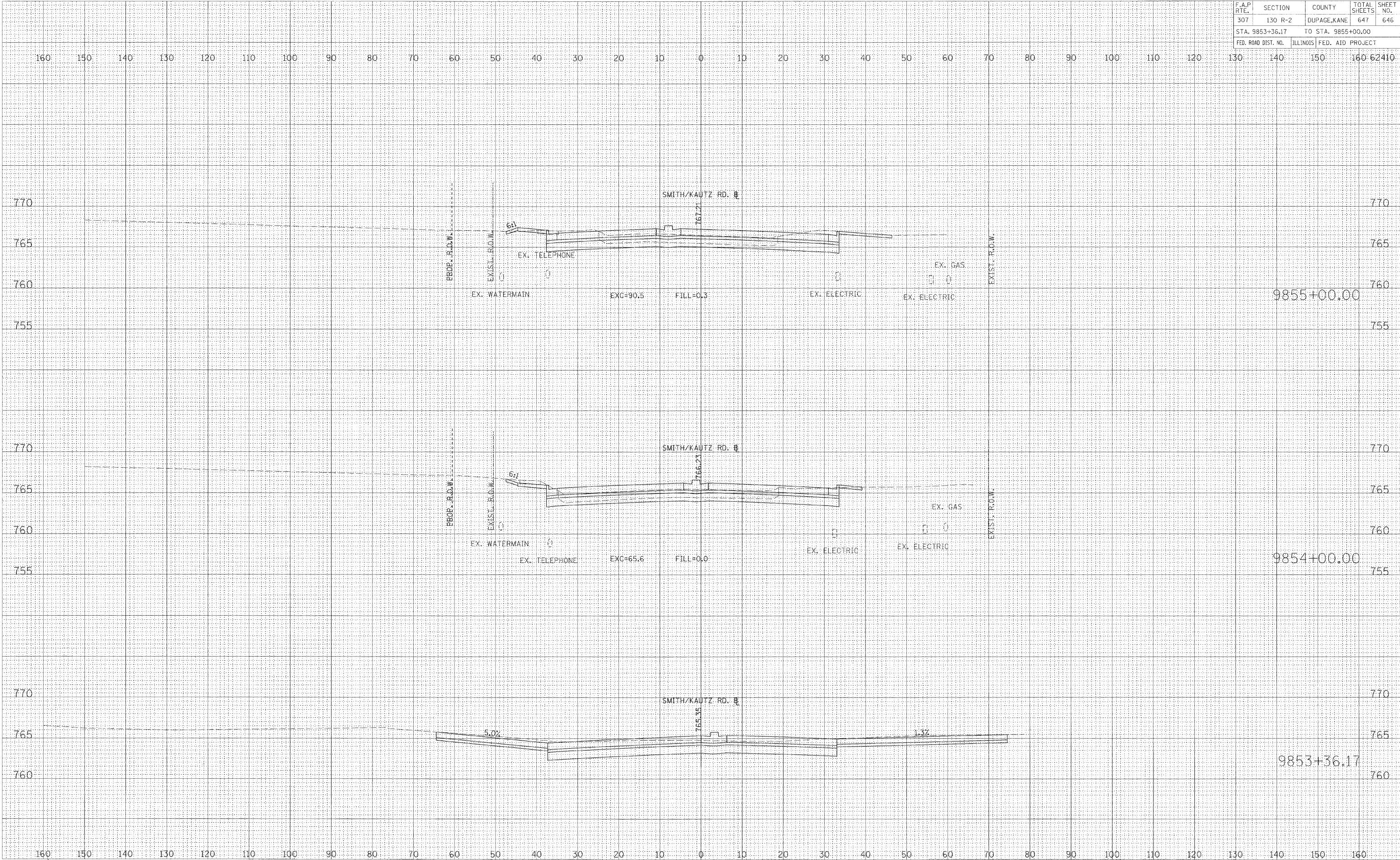

DATE	BY

DATE	BY



CROSS SECTIONS - SMITH AND KAUTZ ROAD