

**CONSTRUCTION NOTES:**

- 1 RELOCATE EXISTING SIGNAL POST AND SIGNAL HEAD, 1-FACE, 3-SECTION. INSTALL NEW PEDESTRIAN SIGNAL HEAD, 1-FACE, BRACKET MOUNTED WITH COUNTDOWN TIMER AND PEDESTRIAN PUSHBUTTON ON RELOCATED POST. INSTALL NEW TYPE A CONCRETE FOUNDATION AND REMOVE EXISTING CONCRETE FOUNDATION. REMOVE EXISTING 5C CABLE AND INSTALL NEW 2C, 3C, AND 5C CABLES.
- 2 SAWCUT NEW DETECTOR LOOPS. REMOVE EXISTING LEAD-IN CABLE FROM CONDUIT AND INSTALL NEW LEAD-IN CABLE.
- 3 INSTALL NEW PEDESTRIAN SIGNAL HEAD, 1-FACE, BRACKET MOUNTED WITH COUNTDOWN TIMER AND PEDESTRIAN PUSHBUTTON ON EXISTING MAST ARM. INSTALL NEW 2C AND 3C CABLES.

4 THE GENERAL CONTRACTOR IS REQUIRED TO HIRE AN ENVIRONMENTAL FIRM WITH AT LEAST FIVE (5) DOCUMENTAED LEAKING UNDERGROUND STORAGE TANKS (LUST) CLEANUPS OR THAT IS PRE-QUALIFIED IN HAZARDOUS WASTE BY THE DEPARTMENT TO REMEDIATE THE SOIL CONTAMINATION AND MONITOR FOR WORKER PROTECTION.

**RESTORATION OF WORK AREA:**

RESTORATION OF THE TRAFFIC SIGNAL WORK AREA SHALL BE INCIDENTAL TO THE RELATED PAY ITEM SUCH AS FOUNDATION, CONDUIT, HANDHOLE, TRENCH AND BACKFILL, ETC. AND NO EXTRA COMPENSATION SHALL BE ALLOWED. ALL ROADWAY SURFACES SUCH AS SHOULDERS, MEDIANS, SIDEWALKS, PAVEMENT, ETC. SHALL BE REPLACED IN KIND. ALL DAMAGE TO MOWED LAWNS SHALL BE REPLACED WITH AN APPROVED SOD, AND ALL DAMAGE TO UNMOWED FIELDS SHALL BE SEEDDED IN ACCORDANCE WITH STANDARD SPECIFICATIONS 252 AND 250 RESPECTIVELY.

ALL SIGNAL FOUNDATIONS AND UNDERGROUND WORK SHALL BE COMPLETED PRIOR TO THE REMOVAL OF THE EXISTING SIGNAL POST OR EXISTING FOUNDATIONS.

**TRAFFIC SIGNAL LEGEND**

	PROPOSED	EXISTING
CONTROLLER		
SERVICE INSTALLATION		
SIGNAL HEAD		
SIGNAL HEAD WITH BACKPLATE		
SIGNAL HEAD, PEDESTRIAN		
SIGNAL POST		
MAST ARM ASSEMBLY AND POLE, STEEL		
MAST ARM ASSEMBLY AND POLE, ALUMINUM		
COMBINATION MAST ARM ASSEMBLY AND POLE, STEEL WITH LUMINAIRE		
UNIT DUCT		
COMMON TRENCH		
HANDHOLE		
HEAVY DUTY HANDHOLE		
DOUBLE HANDHOLE		
UNDERGROUND CONDUIT		
PEDESTRIAN PUSHBUTTON DETECTOR		
DETECTOR LOOP		
CAST IRON JUNCTION BOX		
EMERGENCY VEHICLE LIGHT DETECTOR		
CONFIRMATION BEACON		
SIGNAL HEAD OPTICALLY PROGRAMMED		
CONDUIT SPLICE		
WOOD POLE		
RACEWAY FOR MAGNETIC DETECTOR, TYPE I OR TYPE II		
VEHICLE DETECTOR, NON COMPENSATED MAGNETIC TYPE		
RAILROAD CONTROL CABINET		
TELEPHONE CONNECTION		
ILLUMINATED SIGN - "NO LEFT TURN"		
ILLUMINATED SIGN - "NO RIGHT TURN"		

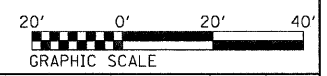
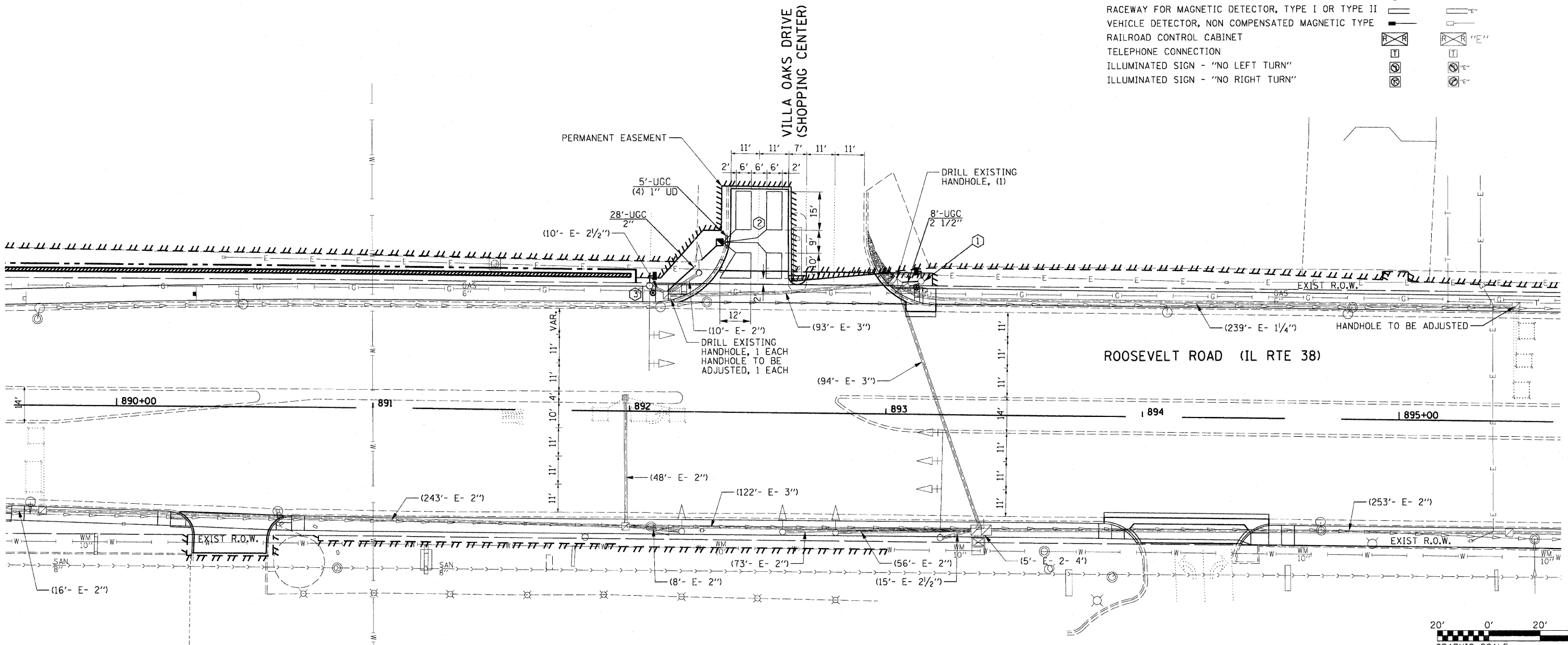
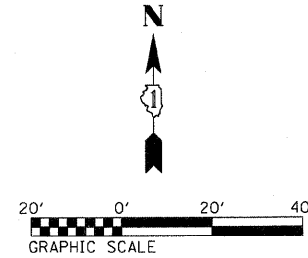

FILE NAME =	USER NAME #USER#	DESIGNED TM	REVISED 10/24/2011	<b>STATE OF ILLINOIS DEPARTMENT OF TRANSPORTATION</b>	<b>TRAFFIC SIGNAL MODIFICATION PLAN ROOSEVELT RD. AT VILLA OAKS DR. INTERSECTION</b>	F.A.P. RTE.	SECTION	COUNTY	TOTAL SHEETS	SHEET NO.	
#FILE#	DRAWN BM/CC/BB	CHECKED DA	REVISED 01/03/2012 ADDENDUM A			347	02-00077-00-SW	DUPAGE	73	49	
PLOT SCALE #SCALE#	DATE 06/08/2011	REVISOR				CONTRACT NO. 63197					
PLOT DATE #DATE#						FED. ROAD DIST. NO. ILLINOIS FED. AID PROJECT					
				SCALE: AS SHOWN SHEET NO. 3 OF 6 SHEETS							