

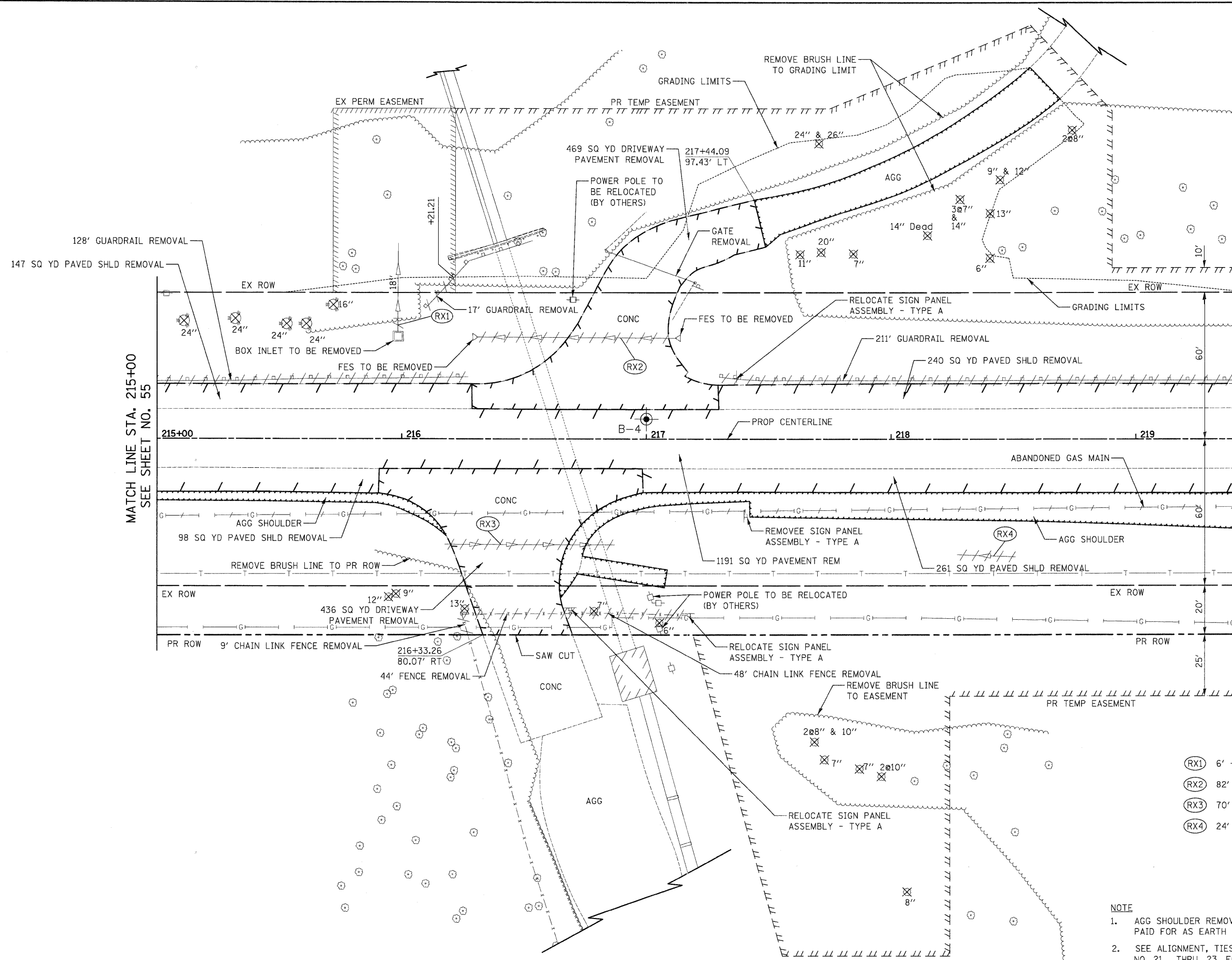

DATE	
BY	
PLAN	
SURVEYED	
PLOTTED	
GRADES CHECKED	
ALIGNMENT CHECKED	
NOTE BOOK	
NO.	
CADD FILE NAME	

DATE	
BY	
PROFILE	
SURVEYED	
PLOTTED	
GRADES CHECKED	
STRUCTURE NOTATIONS CHECKED	
NOTE BOOK	
NO.	



MATCH LINE STA. 215+00
SEE SHEET NO. 55

MATCH LINE STA. 219+40
SEE SHEET NO. 57

- (RX1) 6' - SS REM 18
- (RX2) 82' - PIPE CULVERT REMOV
- (RX3) 70' - PIPE CULVERT REMOV
- (RX4) 24' - PIPE CULVERT REMOV

- NOTE
- AGG SHOULDER REMOVAL TO BE PAID FOR AS EARTH EXCAVATION
 - SEE ALIGNMENT, TIES AND BENCHMARKS SHEET NO. 21 THRU 23 FOR DETAIL ROW AND EASEMENT LOCATIONS

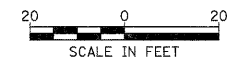

ILLINOIS ROUTE 31

FILE NAME =	USER NAME = dte	DESIGNED - KWH	REVISED -	STATE OF ILLINOIS DEPARTMENT OF TRANSPORTATION	REMOVAL PLAN			F.A.U. RTE. 3887	SECTION 96-00209-01-PV	COUNTY McHENRY	TOTAL SHEETS 271	SHEET NO. 56
Y:\2278 Virginia Klaser\load\sheet\07-Removals\2278_REM_02.dgn	PLOT SCALE = 20.0000' / in.	DRAWN - DTE	REVISED -		SCALE: 1" = 20'	SHEET NO. 2 OF 14 SHEETS	STA. 215+00 TO STA. 219+40	FED. ROAD DIST. NO. 1 [ILLINOIS] FED. AID PROJECT HPP-40640031		CONTRACT NO. 63553		
	PLOT DATE = 10/24/2011	CHECKED - GAB	REVISED -									
		DATE - 10/24/11	REVISED -									