

VIRGINIA ROAD MATCH LINE STA. 99+00
SEE SHEET NO. 68

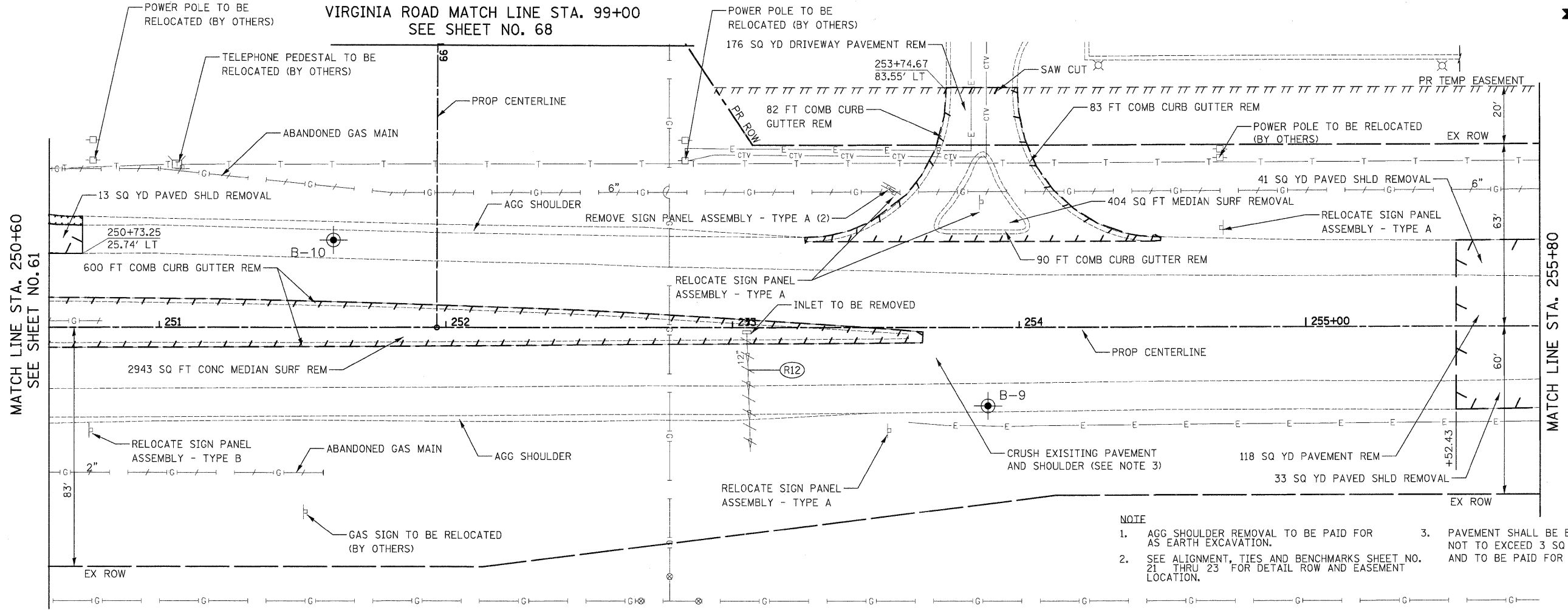

- NOTE**
- AGG SHOULDER REMOVAL TO BE PAID FOR AS EARTH EXCAVATION.
 - SEE ALIGNMENT, TIES AND BENCHMARKS SHEET NO. 21 THRU 23 FOR DETAIL ROW AND EASEMENT LOCATION.
 - PAVEMENT SHALL BE BROKEN INTO PIECES NOT TO EXCEED 3 SQ FT IN SURFACE AREA AND TO BE PAID FOR AS EARTH EXCAVATION.

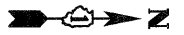
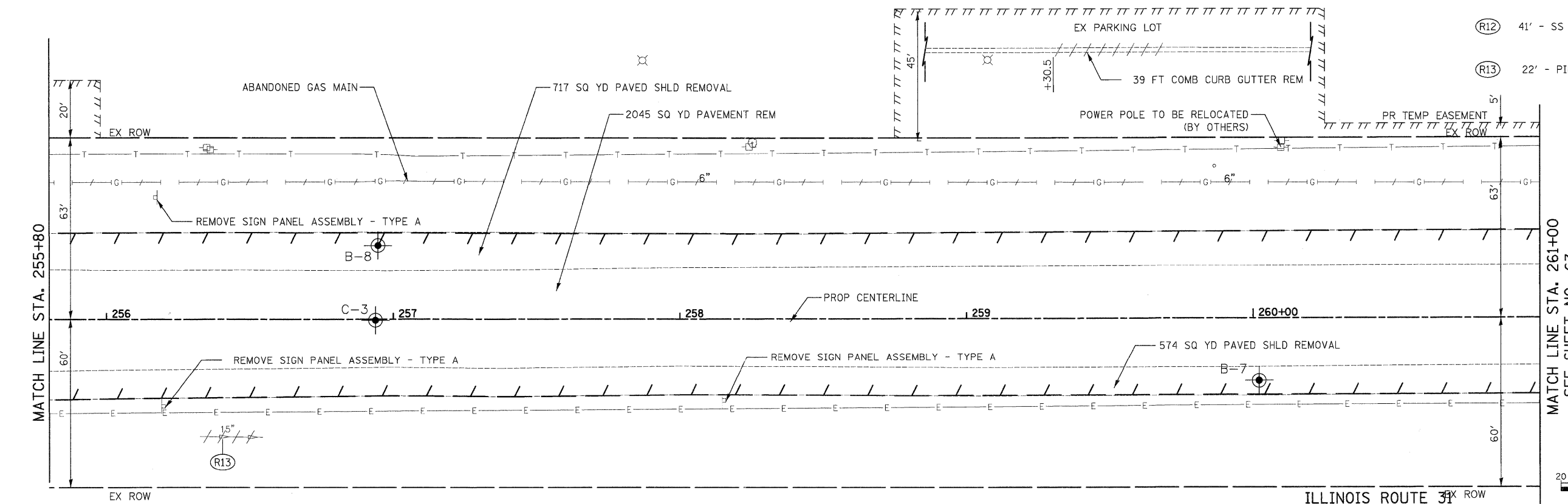

ILLINOIS ROUTE 31

DATE	BY

DATE	BY

FILE NAME =	USER NAME = dte	DESIGNED - KWH	REVISED -	<p align="center">STATE OF ILLINOIS DEPARTMENT OF TRANSPORTATION</p>	REMOVAL PLAN			F.A.U. RTE. 3887	SECTION 96-00209-01-PV	COUNTY McHENRY	TOTAL SHEETS 271	SHEET NO. 62
Y:\2278 Virginia Klassen\load\sheet\07-Remo	o:\s\2278_REM_08.dgn	DRAWN - DTE	REVISED -		SCALE: 1" = 20'	SHEET NO. 8 OF 14 SHEETS	STA. 250+60 TO STA. 261+00	FED. ROAD DIST. NO. 1 ILLINOIS	FED. AID PROJECT HPP-4064(003)	CONTRACT NO. 63553		
PLOT SCALE = 28,0000' / in.		CHECKED - GAB	REVISED -									
PLOT DATE = 10/24/2011		DATE - 10/24/11	REVISED -									