

TRINITY DRIVE

NOTES

1. AGG SHOULDER REMOVAL TO BE PAID FOR AS EARTH EXCAVATION
2. SEE ALIGNMENT, TIES AND BENCHMARKS SHEET NO. 21 THRU 23 FOR DETAIL ROW AND EASEMENT LOCATIONS

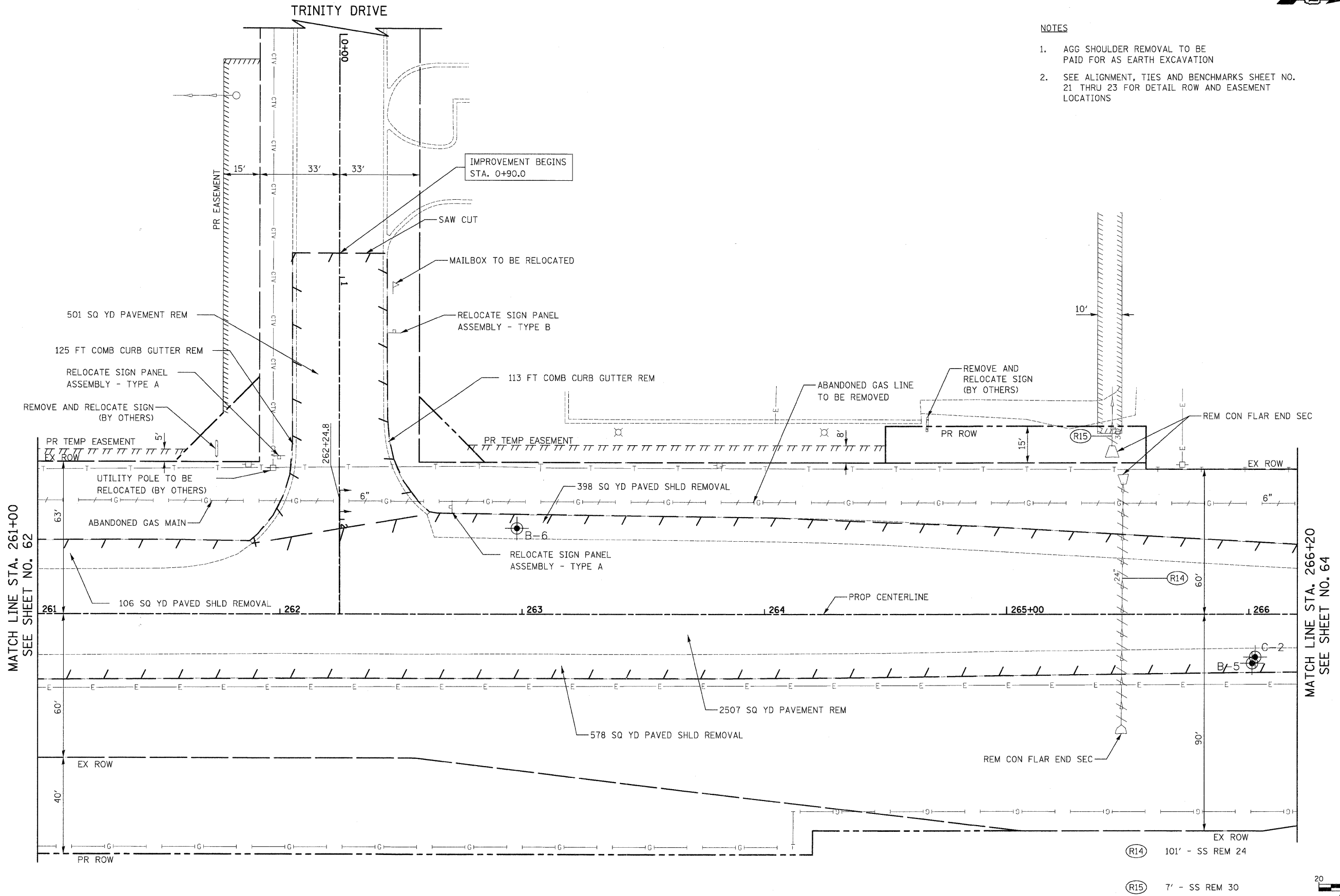

MATCH LINE STA. 261+00
SEE SHEET NO. 62

MATCH LINE STA. 266+20
SEE SHEET NO. 64

(R14) 101' - SS REM 24
 (R15) 7' - SS REM 30



ILLINOIS ROUTE 31

PLAN	SURVEYED	DATE
	PLOTTED	
	ALIGNMENT CHECKED	
	NOTE BOOK	
	CADD FILE NAME	
	NO.	

PROFILE	SURVEYED	DATE
	GRADES CHECKED	
	NOTE BOOK	
	STRUCTURE NOTATIONS CHKD	
	NO.	

FILE NAME =	USER NAME = dte	DESIGNED - KWH	REVISED -
Y:\2278 Virginia Klassen\cad\sheet\07-Remo	els\2278_REM_0.dgn	DRAWN - DTE	REVISED -
	PLOT SCALE = 20.0000' / in.	CHECKED - GAB	REVISED -
	PLOT DATE = 10/24/2011	DATE - 10/24/11	REVISED -

STATE OF ILLINOIS
DEPARTMENT OF TRANSPORTATION

REMOVAL PLAN

SCALE: 1" = 20' SHEET NO. 9 OF 14 SHEETS STA. 261+00 TO STA. 266+20

F.A.U. RTE.	SECTION	COUNTY	TOTAL SHEETS	SHEET NO.
3887	96-00209-01-PV	McHENRY	271	63
CONTRACT NO. 63553				
FED. ROAD DIST. NO. 1 ILLINOIS FED. AID PROJECT HPP-4064(003)				