

DATE	
BY	
REVIEWED	
PLANNED	
NOTED	
NO.	

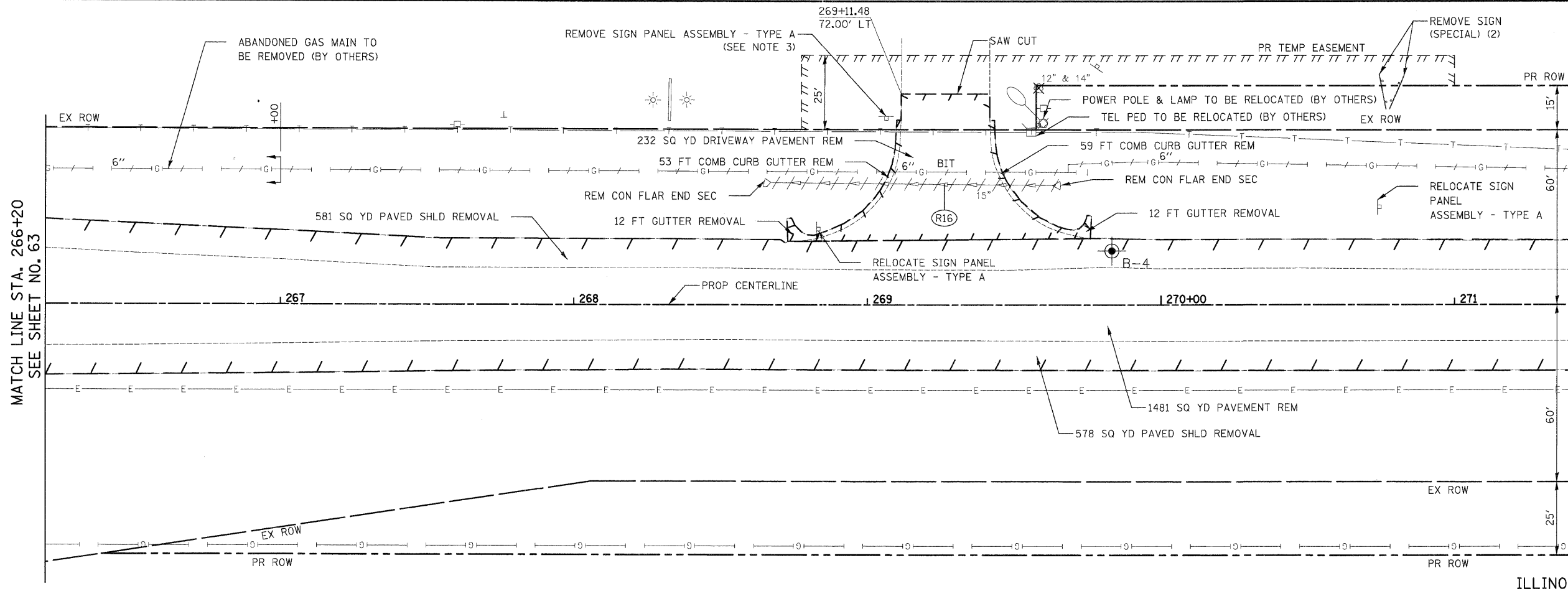

ILLINOIS ROUTE 31

DATE	
BY	
REVIEWED	
PLANNED	
NOTED	
NO.	

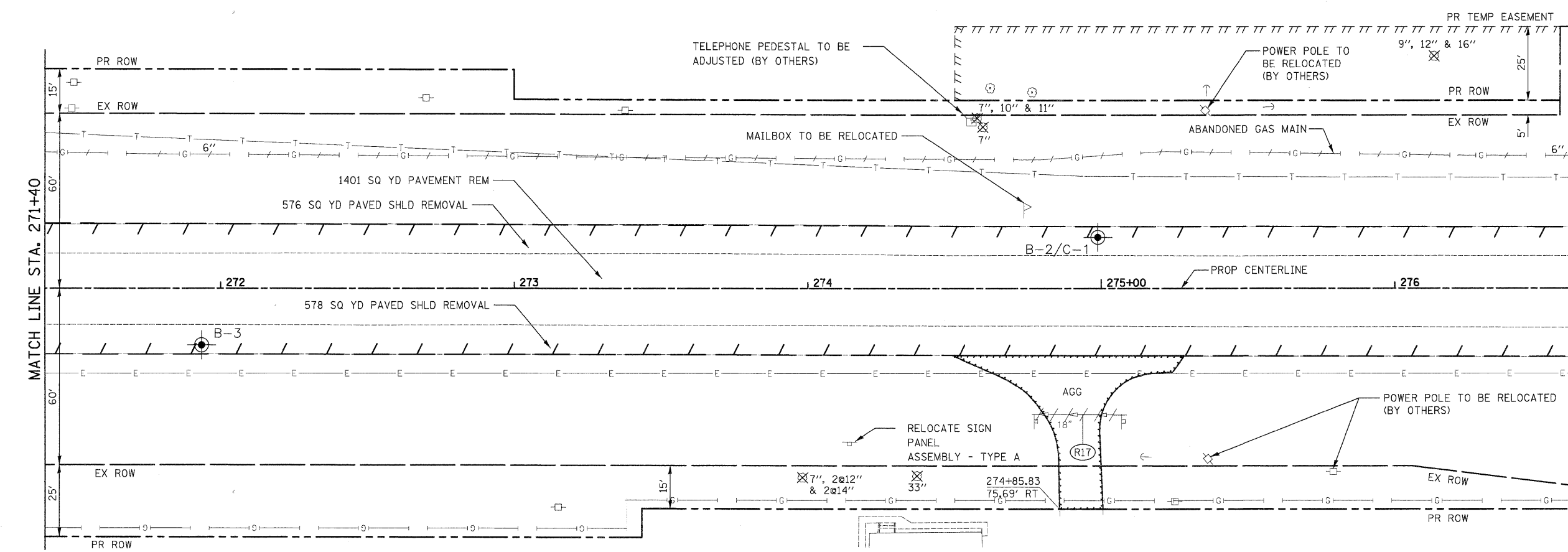

- NOTE**
1. AGG SHOULDER REMOVAL TO BE PAID FOR AS EARTH EXCAVATION
  2. SEE ALIGNMENT, TIES AND BENCHMARKS SHEET NO. 21 THRU 23 FOR DETAIL ROW AND EASEMENT LOCATIONS
  3. SIGN TO BE USED IN M.O.T. THEN REMOVED AFTER STAGES ARE COMPLETE

- REVISIONS**
- (R16) 98' - SS REM 15
  - (R17) 32' - PIPE CULVERT REMOVE

FILE NAME Y:\2278_Virginia_Klassen\load\sheet\07-Remo	USER NAME = dte als\2278_REM_10.dgn	DESIGNED - KWH	REVISED -	<b>STATE OF ILLINOIS DEPARTMENT OF TRANSPORTATION</b>	<b>REMOVAL PLAN</b>	F.A.U. RTE. 3887	SECTION 96-00209-01-PV	COUNTY McHENRY	TOTAL SHEETS 271	SHEET NO. 64		
PLOT SCALE = 20.0000' / 1"	CHECKED - GAB	REVISED -	SCALE: 1" = 20'			SHEET NO. 10 OF 14 SHEETS	STA. 266+20 TO STA. 276+60	FED. ROAD DIST. NO. 1 ILLINOIS	FED. AID PROJECT HPP-4064(003)			
PLOT DATE = 10/24/2011	DATE = 10/24/11	REVISED -	CONTRACT NO. 63553									