

PLAN	SURVEYED	DATE
	PLOTTED	
	ALIGNED	
	CHECKED	
	BY	
	NOTE BOOK	
	NO.	
	CADD FILE NAME	

PROFILE	SURVEYED	DATE
	PLOTTED	
	GRADES CHECKED	
	STRUCTURE NOTATIONS CHECKED	
	BY	
	NOTE BOOK	
	NO.	

MATCH LINE STA. 276+60
SEE SHEET NO. 64

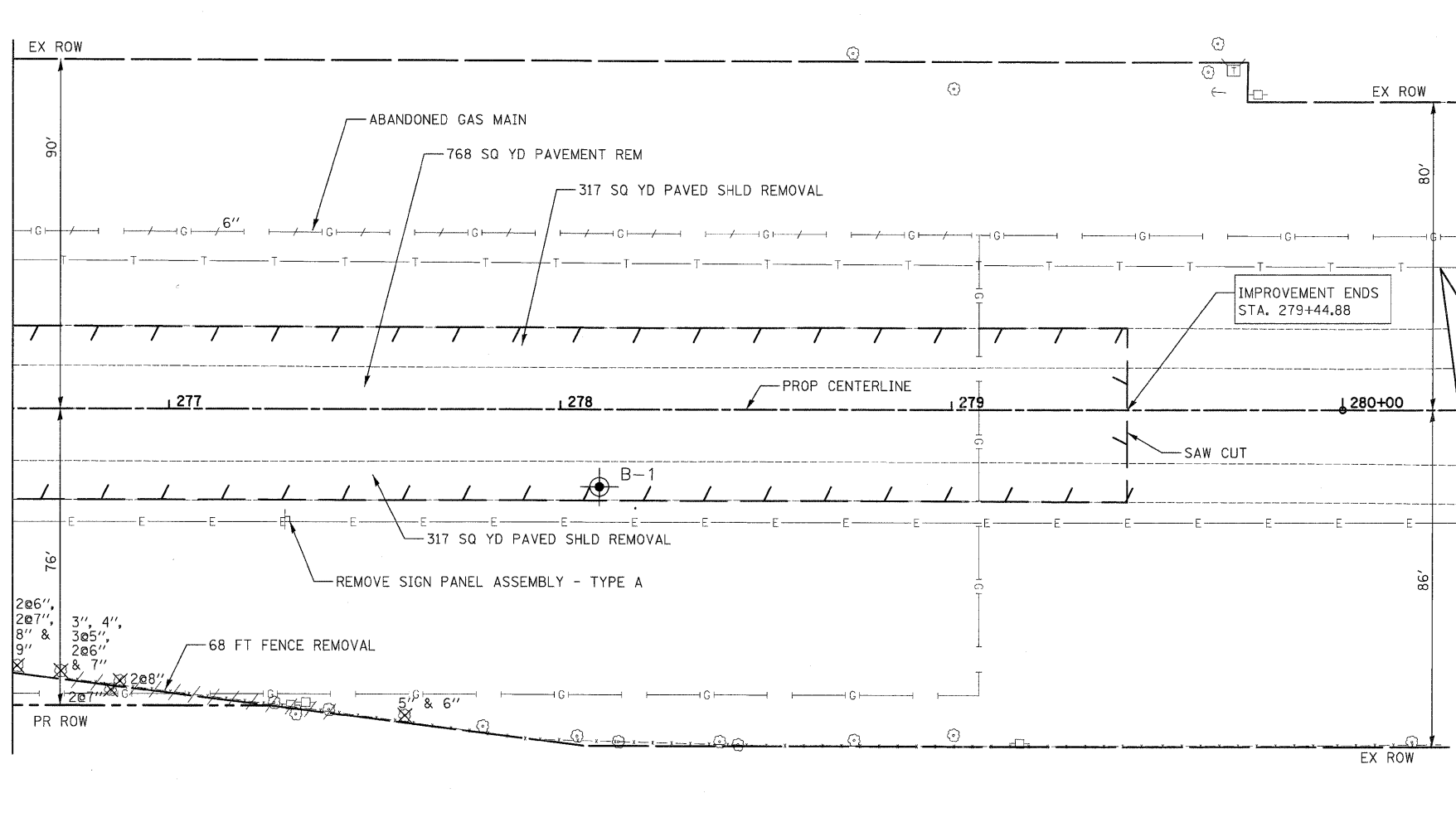

- NOTE
1. AGG SHOULDER REMOVAL TO BE PAID FOR AS EARTH EXCAVATION.
 2. SEE ALIGNMENT, TIES AND BENCHMARKS SHEET NO. 21 THRU 23 FOR DETAIL ROW AND EASEMENT LOCATIONS.

ILLINOIS ROUTE 31

FILE NAME =	USER NAME = dte	DESIGNED - KWH	REVISED -	STATE OF ILLINOIS DEPARTMENT OF TRANSPORTATION	REMOVAL PLAN	F.A.U. RTE.	SECTION	COUNTY	TOTAL SHEETS	SHEET NO.	
Y:\2278_Virginia_Klasen\load\sheet\07-Remo	els\2278_REM_11.dgn	DRAWN - DTE	REVISED -			3887	96-00209-01-PV	McHENRY	271	65	
	PLOT SCALE = 20.0000' / 1in.	CHECKED - GAB	REVISED -			CONTRACT NO. 63553					
	PLOT DATE = 10/24/2011	DATE - 10/24/11	REVISED -			FED. ROAD DIST. NO. 1 [ILLINOIS] FED. AID PROJECT HPP-40640031					
				SCALE: 1" = 20'		SHEET NO. 11 OF 14 SHEETS		STA. 276+60 TO STA. 279+44.88			